



Connells

Greystones
Willesborough ASHFORD



Property Description

*GUIDE PRICE £350,000 - £375000 * The ground floor features a stylish, well-equipped kitchen offering plenty of cupboard space and work surfaces. At the rear, a bright living and dining area opens directly onto the garden, creating a welcoming space for both day-to-day living and entertaining.

Across the upper levels are four generous bedrooms, including a top-floor main bedroom with its own en-suite shower room. The remaining rooms offer great versatility, whether used as bedrooms, a study, or guest accommodation, complemented by a contemporary family bathroom.

Outside, the property enjoys a private rear garden ideal for relaxing or outdoor dining, along with the convenience of off-street parking.

Situated in a popular residential part of Ashford, the home provides easy access to local shops, well-regarded schools, and excellent transport connections—including Ashford International Station, offering high-speed links to London.

*GUIDE PRICE £350,000 - £375000 * The ground floor features a stylish, well-equipped kitchen offering plenty of cupboard space and work surfaces. At the rear, a bright living and dining area opens directly onto the garden, creating a welcoming space for both day-to-day living and entertaining.

Across the upper levels are four generous bedrooms, including a top-floor main bedroom with its own en-suite shower room. The remaining rooms offer great versatility, whether used as bedrooms, a study, or guest accommodation, complemented by a contemporary family bathroom.

Outside, the property enjoys a private rear garden ideal for relaxing or outdoor dining,

along with the convenience of off-street parking.

Situated in a popular residential part of Ashford, the home provides easy access to local shops, well-regarded schools, and excellent transport connections—including Ashford International Station, offering high-speed links to London.

*GUIDE PRICE £350,000 - £375000 * The ground floor features a stylish, well-equipped kitchen offering plenty of cupboard space and work surfaces. At the rear, a bright living and dining area opens directly onto the garden, creating a welcoming space for both day-to-day living and entertaining.

Across the upper levels are four generous bedrooms, including a top-floor main bedroom with its own en-suite shower room. The remaining rooms offer great versatility, whether used as bedrooms, a study, or guest accommodation, complemented by a contemporary family bathroom.

Outside, the property enjoys a private rear garden ideal for relaxing or outdoor dining, along with the convenience of off-street parking.

Situated in a popular residential part of Ashford, the home provides easy access to local shops, well-regarded schools, and excellent transport connections—including Ashford International Station, offering high-speed links to London.

*GUIDE PRICE £350,000 - £375000 * The ground floor features a stylish, well-equipped kitchen offering plenty of cupboard space and work surfaces. At the rear, a bright living and dining area opens directly onto the garden, creating a welcoming space for both day-to-day living and entertaining.

Across the upper levels are four generous bedrooms, including a top-floor main bedroom with its own en-suite shower room. The remaining rooms offer great versatility, whether used as bedrooms, a study, or guest accommodation, complemented by a contemporary family bathroom.

Outside, the property enjoys a private rear garden ideal for relaxing or outdoor dining, along with the convenience of off-street parking.

Situated in a popular residential part of Ashford, the home provides easy access to local shops, well-regarded schools, and excellent transport connections—including Ashford International Station, offering high-speed links to London.



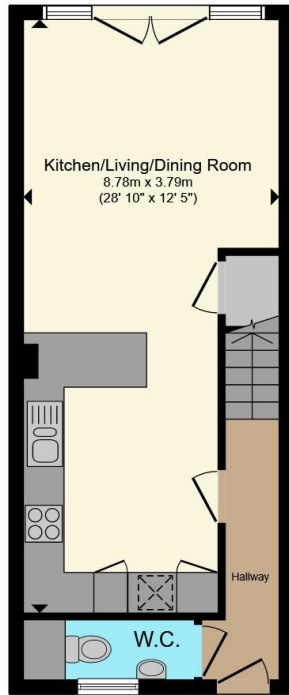

Ground Floor

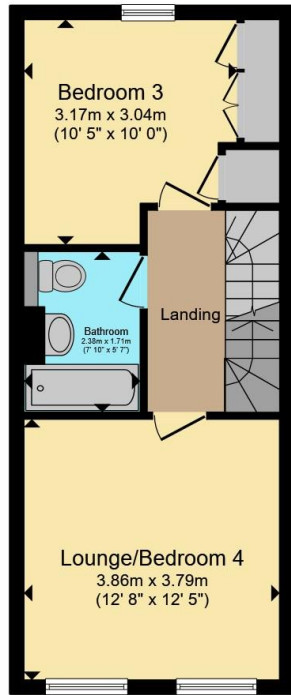

First Floor

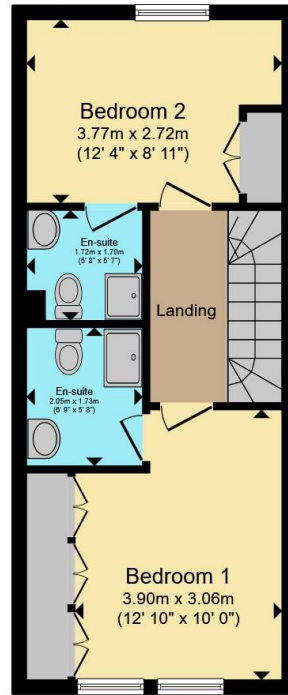

Second Floor

Total floor area 110.7 m² (1,192 sq.ft.) approx

This floor plan is for illustrative purposes only. It is not drawn to scale. Any measurements, floor areas (including any total floor area), openings and orientation are approximate. No details are guaranteed, they cannot be relied upon for any purpose and they do not form part of any agreement. No liability is taken for any error, omission or misstatement. A party must rely upon its own inspection(s). Powered by www.propertybox.io



To view this property please contact Connells on

T 01233 622206
E ashford@connells.co.uk

77 High Street
 ASHFORD TN24 8SF

EPC Rating: C Council Tax
 Band: D

view this property online connells.co.uk/Property/ASH408814

Tenure: Freehold



1. MONEY LAUNDERING REGULATIONS Intending purchasers will be asked to produce identification documentation at a later stage and we would ask for your co-operation in order that there will be no delay in agreeing the sale. 2. These particulars do not constitute part or all of an offer or contract. 3. The measurements indicated are supplied for guidance only and as such must be considered incorrect. Potential buyers are advised to recheck measurements before committing to any expense. 4. We have not tested any apparatus, equipment, fixtures, fittings or services and it is in the buyers interest to check the working condition of any appliances.

Connells Residential is registered in England and Wales under company number 1489613, Registered Office is Cumbria House, 16-20 Hockliffe Street, Leighton Buzzard, Bedfordshire, LU7 1GN. VAT Registration Number is 500 2481 05.

See all our properties at www.connells.co.uk | www.rightmove.co.uk | www.zoopla.co.uk

Property Ref: ASH408814 - 0006