

Boleyn Road, N16

£375,000

This well presented one-bedroom apartment offers bright, contemporary living with a spacious open-plan layout and modern appliances. Flooded with natural light throughout, the home sits on the third floor of a secure, modern development featuring lift access and fob-entry.

Located behind Kingsland high street there are a wealth of restaurants, shops and cafés on your door step. Dalston Kingsland and Junction are within easy reach allowing for straightforward access to Shoreditch, Islington and The City.

Features

- One Bedroom
- Third Floor
- Open Plan Living
- Integrated Appliances
- Communal Terrace
- Juliette Balcony

Boleyn Road, London, N16

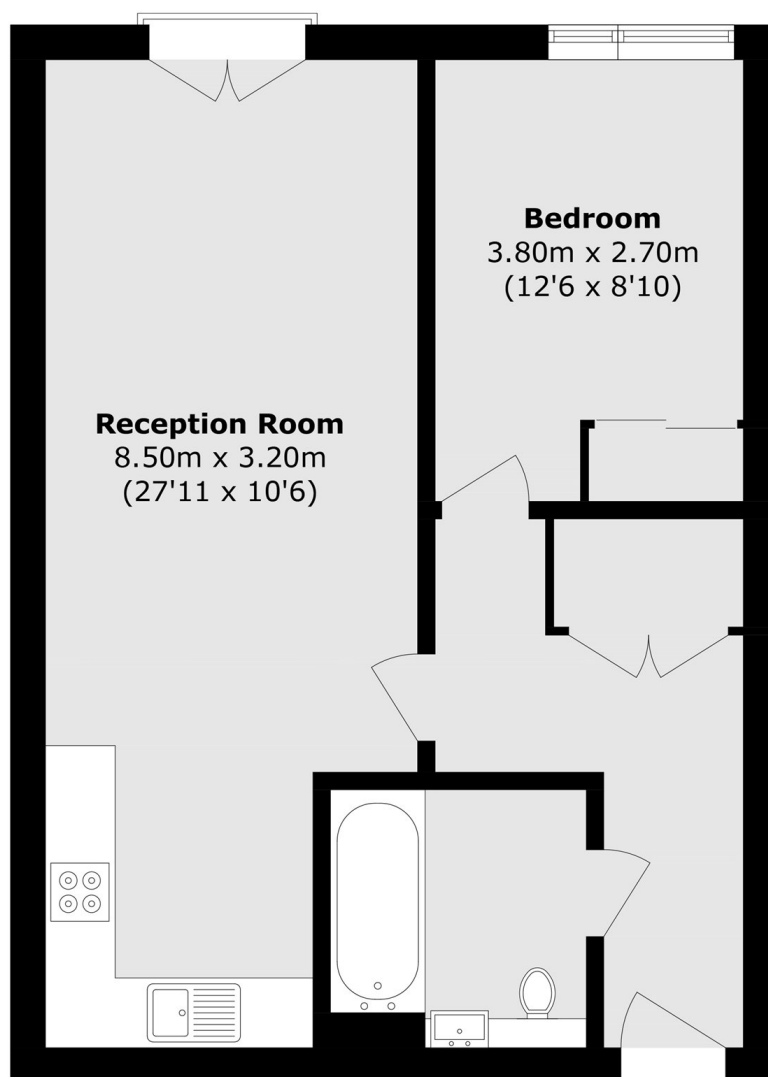

Total area (approx.): 51.0 sq. m (548.9 sq. ft)