



TO LET

Moorside, Knutsford

IRLAM
of Knutsford

Knutsford, WA16 6EZ

Moorside - £2,000 pcm



The Property

This beautiful period cottage has been sympathetically extended and refurbished to now offer generous, hi-spec accommodation, with spectacular views over The Moor and towards Tatton Park. The property sits in an enviable position on a quiet backwater in the heart of Knutsford town centre, within a short stroll of all local amenities including the bars, shops and restaurants, as well as Tatton Park and The Moor. Particular mention must be made of the stunning, bright master bedroom suite with its en-suite shower room and bright dual aspect with Juliet balconies to the front and rear.

The property is approached via an attractive country garden with flagged driveway providing off-road parking. To the rear is an enclosed garden laid to flag with decked patio area ideal for al fresco dining.

Directions

From our office proceed down Old Market Place and upon reaching The Moor turn left onto Moorside Road where the property will be seen on the left hand side.

- A beautiful period cottage
- Situated in the heart of Knutsford town centre
- Generous & flexible living space
- Breakfast kitchen with appliances and separate utility room
- Three generous bedrooms
- Two bathrooms (one en-suite)
- Off road parking & gardens.
- Unfurnished
- Available July

Postcode – WA16 6EZ

EPC Rating – C

Local Authority – Cheshire East

Council Tax – Band C



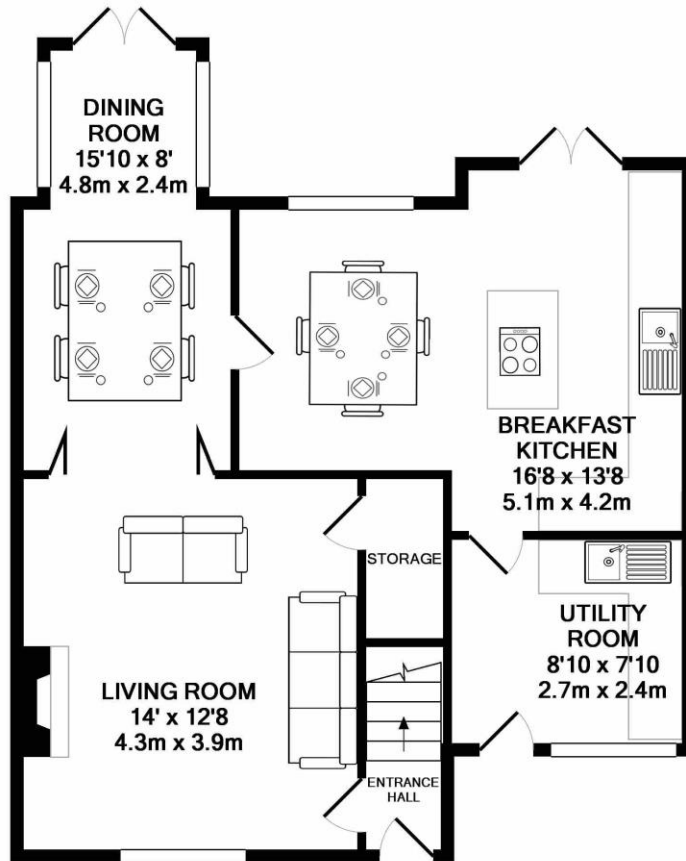

GROUND FLOOR
APPROX. FLOOR
AREA 603 SQ.FT.
(56.0 SQ.M.)

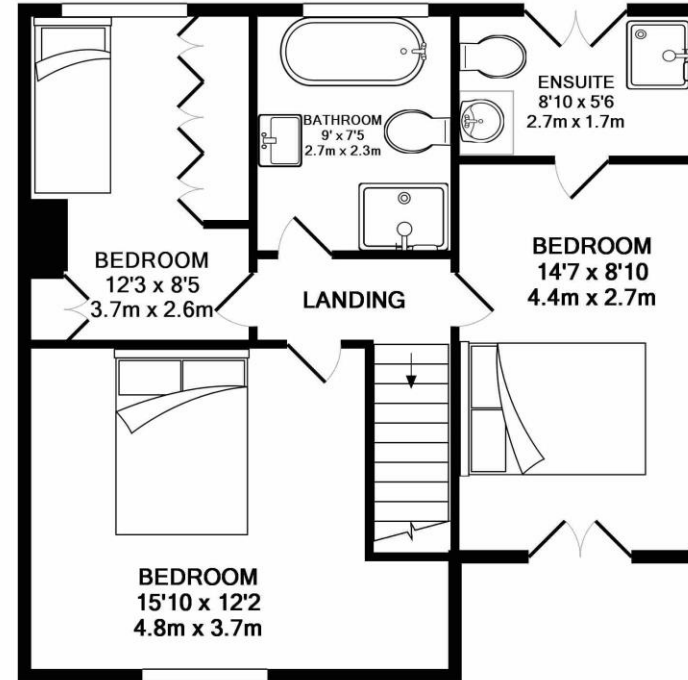

1ST FLOOR
APPROX. FLOOR
AREA 560 SQ.FT.
(52.0 SQ.M.)

TOTAL APPROX. FLOOR AREA 1163 SQ.FT. (108.1 SQ.M.)

Whilst every attempt has been made to ensure the accuracy of the floor plan contained here, measurements of doors, windows, rooms and any other items are approximate and no responsibility is taken for any error, omission, or mis-statement. This plan is for illustrative purposes only and should be used as such by any prospective purchaser. The services, systems and appliances shown have not been tested and no guarantee as to their operability or efficiency can be given
Made with Metropix ©2019

103 King Street, Knutsford, Cheshire, WA16 6EQ

01565 654 000

E: info@irlamsestateagents.co.uk

www.irlamsestateagents.co.uk

I1021_ Printed by Ravensworth 01670 713330

Irlams (Estate Agents) Ltd for themselves and for the vendors or lessors of this property whose agents they are give notice that:

- (a) The particulars are set out as a general outline only for the guidance of intending purchasers or lessees, and do not constitute, nor constitute part of, an offer or contract;
- (b) All descriptions, dimensions, references to condition and necessary permissions for use and occupation, and other details are given in good faith and are believed to be correct but any intending purchasers or lessees should not rely on them as statements or representations of fact, but must satisfy themselves by inspection or otherwise as to the correctness of each of them;
- (c) No person in the employment of Irlams (Estate Agents) Ltd has any authority to make or give any representation or warranty whatsoever in relation to this property.

