



St Michaels Court, Goxhill, North Lincolnshire

Offers over £210,000





Digitally Altered

Key Features

- ****NO CHAIN****
- Total Floor Area: Square Metres
- Lounge & Office
- Kitchen & Dining Room
- Utility Room
- Three Bedrooms
- Family Bathroom
- Spacious Driveway & Integral Garage
- Enclosed Rear Garden
- Gated Front Access
- EPC rating





DESCRIPTION

****NO CHAIN****

Situated on the quaint St Michaels Court, is this detached bungalow. On the market with no chain, looking for someone new to put their own stamp on it.

Approaching the property, you are greeted with gated access and a spacious block paved driveway. Not to forget the integral garage, adding extra storage to this property.

Continuing on, this generously proportioned accommodation includes a bright and airy lounge with a feature fireplace. Further on, there is a fully equipped kitchen with adjacent dining room overlooking the rear garden. Perfect space to entertain friends and family. Not to forget, the office and utility room adding convenience and versatility to the property. Finished with three bedrooms and a family bathroom.

Let's not forget about the rear garden. Fully laid to lawn and surrounded by fencing and mature trees and shrubbery with a delightful patio area.

Do not hesitate and book a viewing today.



FLOORPLAN

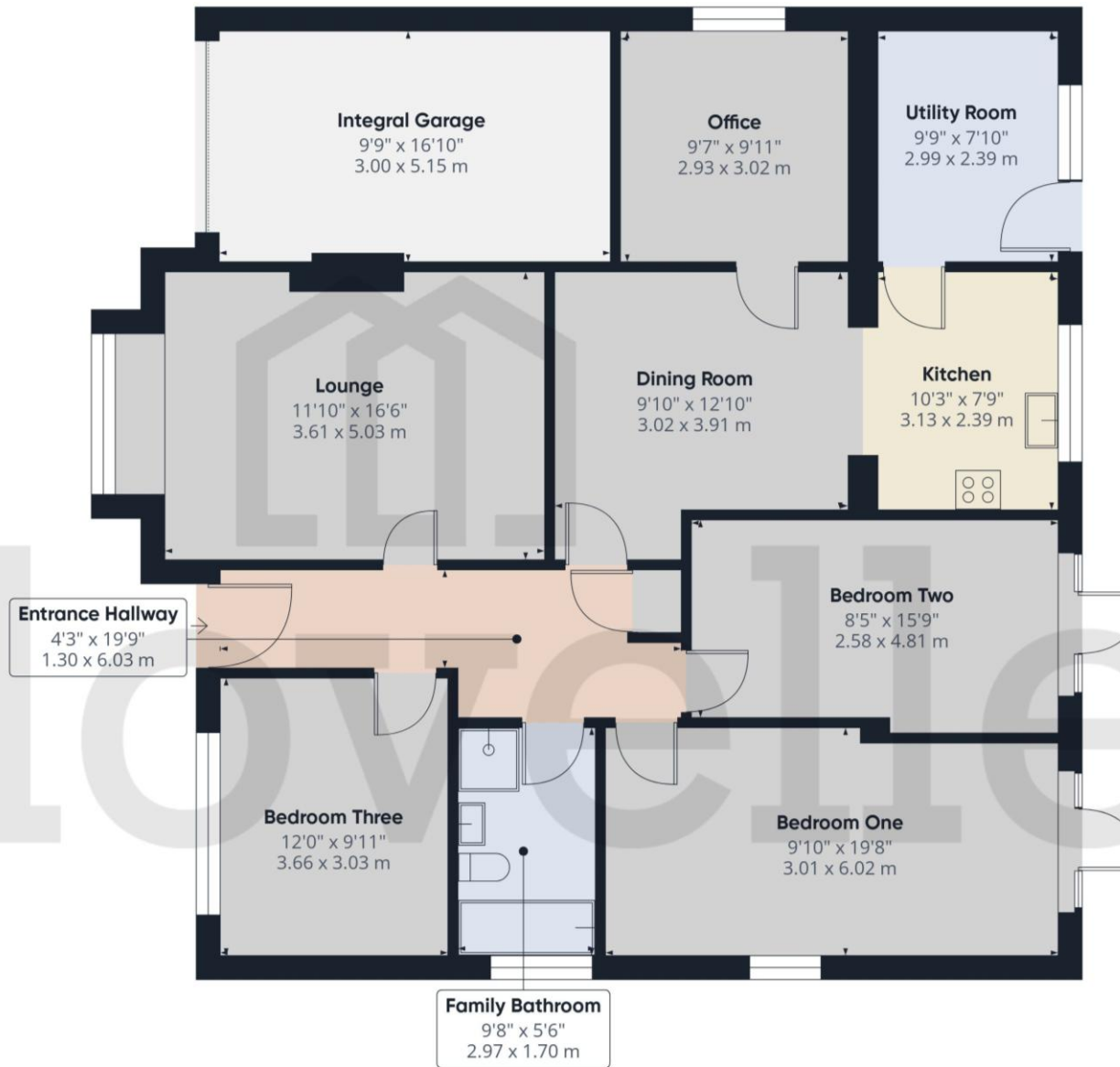

St Michaels Court, Goxhill, North Lincolnshire

TENURE

The Tenure of this property is Freehold.

COUNCIL TAX

Band C

VIEWING

By appointment with the Sole Agent Lovelle Estate Agency, telephone 01652 636587. We recommend prior to making an appointment to view, prospective purchasers discuss any particular points likely to affect their interest in the property with one of our property consultants who have seen the property in order that you do not make a wasted journey.

MORTGAGE ADVICE

Budgeting correctly and choosing the right mortgage for a move is vital. For independent mortgage and insurance advice call our mortgage advisor on 01652636587 to arrange an appointment.

AGENTS NOTE

These particulars are for guidance only. Lovelle Estate Agency, their clients and any joint agents give notice that:- They have no authority to give or make representation/warranties regarding the property, or comment on the SERVICES, TENURE and RIGHT OF WAY of any property. These particulars do not form part of any contract and must not be relied upon as statements or representation of fact. All measurements/areas are approximate. The particulars including photographs and plans are for guidance only and are not necessarily comprehensive.

SKB Estates Limited T/A Lovelle Estate Agency

HOW TO MAKE AN OFFER

If you are interested in this property then it is important that you contact us at your earliest convenience. We will require certain pieces of personal information from you in order to provide a professional service to you and our client. The personal information you have provided to us may be shared with our client, the seller, but it will not be shared with any other third parties without your consent other than stated reasons detailed within our privacy policy. More information on how we hold and process your data is available on our website <https://www.lovelle.co.uk/privacy-policy/> and you can opt out at any time by simply contacting us.

For any offer you wish to make we will need to establish certain details before negotiation can take place. This is so that our vendor can make an informed choice when negotiating and accepting your offer. You will be asked to provide formal I.D. and address verification, as required under new Money Laundering Legislation. You might also have one or two questions for us, such as which solicitor to choose, or which mortgage lender has the best offers available for me. We have a one stop shop to satisfy all of these needs so please ask.

A copy of the full Energy Performance Certificate for this property is available upon request. Advisory Notes - Please be advised if you are considering purchasing a property for Buy To Let purposes, from 1st April 2018 without an EPC rated E or above it will not be possible to issue a new tenancy, or renew an existing tenancy agreement.

Follow us on:



ENTRANCE 1.3m x 6.03m (4'4" x 19'10")

Entered through a glazed UPVC door into the hallway with doors to all principal rooms.

LOUNGE 3.61m x 5.03m (11'10" x 16'6")

Bright and airy room with a bay window to the front elevation and a feature Adam style fireplace surround housing an open flame fire.

KITCHEN 3.13m x 2.39m (10'4" x 7'10")

Range of wall and base units with contrasting work surfaces and tiled splashbacks. Inset double electric oven and a four ring hob with an extraction canopy over. Inset sink and drainer with a swan neck mixer tap. Window to the rear elevation and a door to the utility room.

DINING ROOM 3.02m x 3.91m (9'11" x 12'10")

Great space to entertain guests and family.

OFFICE 2.93m x 3.02m (9'7" x 9'11")

Window to the side elevation.

UTILITY ROOM 2.99m x 2.39m (9'10" x 7'10")

Wall units with contrasting work surfaces. Plumbing for a washing machine and space for a tumble dryer, tall fridge freezer. Window and a glazed UPVC door to the rear elevation.

BEDROOM ONE 3.01m x 6.02m (9'11" x 19'10")

Fully glazed door and windows to the rear elevation.

BEDROOM TWO 2.58m x 4.81m (8'6" x 15'10")

Fully glazed door and windows to the rear elevation.

BEDROOM THREE 3.66m x 3.03m (12'0" x 9'11")

Window to the front elevation.

FAMILY BATHROOM 2.97m x 1.7m (9'8" x 5'7")

White four piece suite incorporating a bathtub with a mixer tap and shower attachment, shower cubicle with an electric shower over, push button WC and a vanity wash hand basin with a mixer tap. Decorative tiles throughout and a chrome effect towel rail radiator.

Window to the side elevation.

OUTSIDE THE PROPERTY:

FRONT ELEVATION

Surrounded by fencing and decorative brick walls with gated access. Block paved driveway offers ample off-street parking, while the integral garage - extra storage space. Finished with mature shrubbery and plantings. Access to the rear of the property.

INTEGRAL GARAGE *3m x 5.15m (9'10" x 16'11")*

Power and lighting.

REAR ELEVATION

Fully enclosed rear garden, predominantly laid to lawn with mature trees and shrubbery, perfect to entertain family and friends in. Finished with a patio area.

LOCATION

Goxhill is a most desirable village, having a varied range of local amenities including a Doctors' Surgery, Pharmacy, All Saints Church, Garage, Pet Food Supplies and a Co-operative supermarket. There is a Primary School within the village, with Baysgarth coeducational Secondary School situated in the market town of Barton-upon-Humber, approximately 4 miles away.

BROADBAND TYPE

Standard - 3 Mbps (download speed), 0.5 Mbps (upload speed),
Superfast - 80 Mbps (download speed), 20 Mbps (upload speed),
Ultrafast- 1800 Mbps (download speed), 600 Mbps (upload speed).

MOBILE COVERAGE

Outdoors - Great,
Indoors - Good,
Available - O2, Vodafone, Three, EE.

*

We are required by law to conduct anti-money laundering checks on all those selling or buying a property. Whilst we retain responsibility for ensuring checks and any ongoing monitoring are carried out correctly, the initial checks are carried out on our behalf by Landmark who will contact you once you have had an offer accepted on a property you wish to buy. The cost of these checks for buyers is £20.00 (incl. VAT) per client, which covers the cost of obtaining relevant data and any manual checks and monitoring which is required. This fee will need to be paid by you in advance of us issuing a memorandum of sale, directly to Landmark, and is non-refundable. We will receive some of the fee taken by Landmark to compensate for its role in the provision of these checks.

