



Tremadoc Road, SW4

£2,800 Per calendar month

On the ground floor of a Victorian conversion, with three large double bedrooms, a spacious reception room, wooden flooring throughout and kitchen leading to a private patio garden.

Located just off Clapham High Street, Tremadoc Road is a firm favourite of young professionals as it provides access to one of South London's most popular social hubs.

Features

- Three Double Bedrooms
- Separate Reception
- Wooden Flooring
- Private Garden
- Prime Location
- Neutral Interior

Tremadoc Road, London, SW4

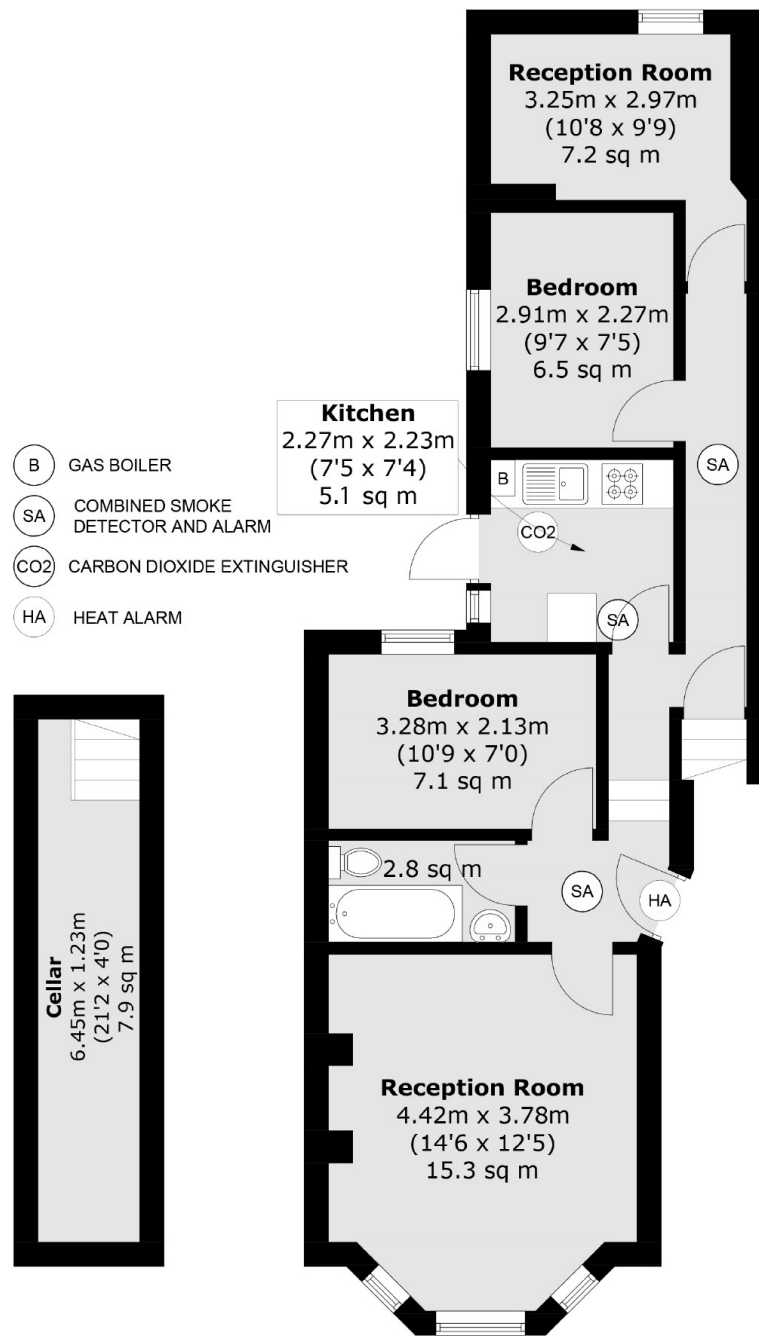

Basement

Ground Floor

Total area (approx.): 64.5 sq. m (694.3 sq. ft)
(Including Basement)