



Cuckoo Hall & Blythgate Cottage Blythgate Lane

Tickhill, Doncaster, DN11 9RJ

Price Guide £800,000

CUCKOO HALL AND BLYTHGATE COTTAGE

Located within this idyllic rural location, in grounds of over 2 acres, and being close to the thriving town of Tickhill, a unique opportunity to acquire two individual, detached character homes, both enjoying stunning views across open countryside. The grounds combine both formal gardens and paddock.

CUCKOO HALL : an elegant Grade 2 listed building, is the main dwelling, fronting Blythgate Lane: In need of extensive refurbishment, the property briefly comprises of 3 reception rooms, kitchen and shower room. 1st floor; 3 bedrooms and bathroom, 2nd floor provides 2 further bedrooms. Outside; gardens extend to the front and side.

BLYTHGATE COTTAGE : situated to the rear of the site, and comprises of to the ground floor; 2 reception rooms and breakfast kitchen, whilst to the 1st floor are 3 bedrooms and bathroom.

Outside; the properties share a range of outbuildings, including stores and garaging. Extensive grounds, abutting open countryside. Formal rear gardens. Ample parking for numerous vehicles.

- two individual detached homes of character, in idyllic rural setting
- within 2 miles of central Tickhill and its wide variety of shops, bars and restaurants
- extensive grounds of 2.19 acres , enjoying panoramic views to all sides
- great potential to further improve to create a stunning country retreat
- M18 (Junction 1) - 5.5 miles : A1 (Blyth) - 5 miles
- good access to mainline rail routes (Retford 13 miles, Doncaster 7 miles)
- EPC rating - Cuckoo Hall - 1/68 : Blythgate Cottage - 46/71
- *overage clause applies (ask agent for further details)
- Council tax band : Cuckoo Hall - F : Blythgate Cottage - E

Viewing

Please contact our Office on 01302 751616 if you wish to arrange a viewing appointment for this property or require further information.



Floor Plan

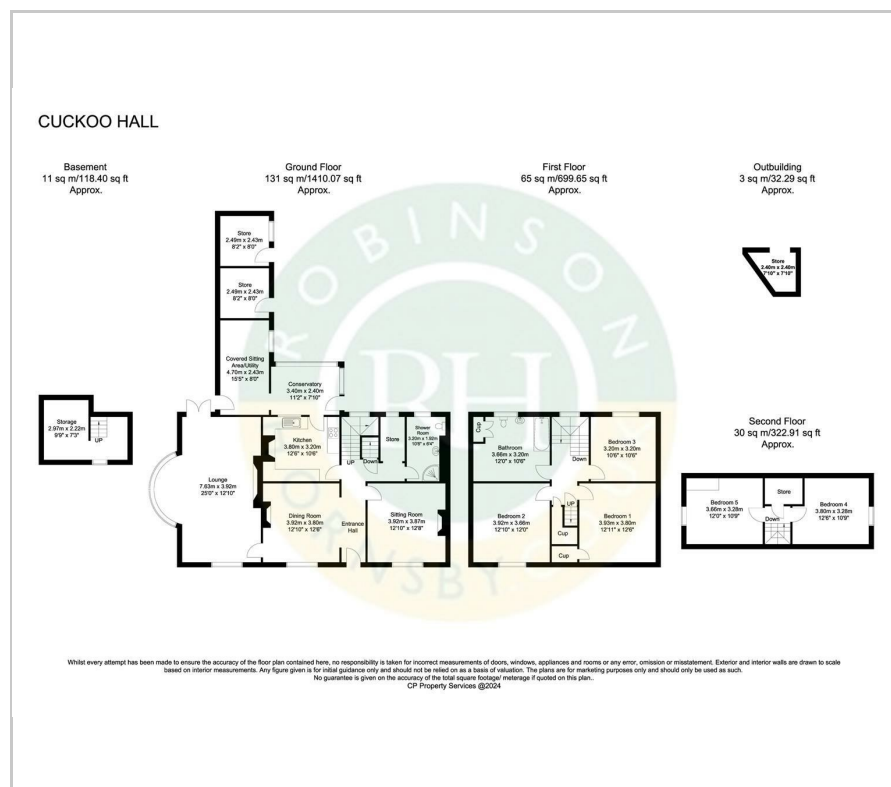

Area Map



Energy Efficiency Graph

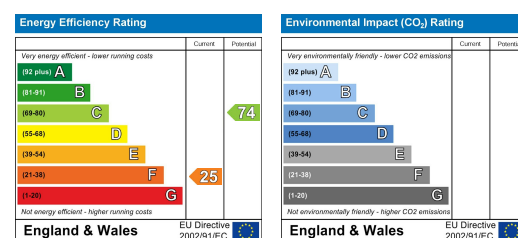

These particulars, whilst believed to be accurate are set out as a general outline only for guidance and do not constitute any part of an offer or contract. Intending purchasers should not rely on them as statements of representation of fact, but must satisfy themselves by inspection or otherwise as to their accuracy. No person in this firm's employment has the authority to make or give any representation or warranty in respect of the property.