



Rothschild Road, W4

£2,100 Per calendar month

A well presented two bedroom apartment that offers a modern bathroom, a large reception room and a separate kitchen.

Located under a mile from Acton Town station and half a mile from Chiswick Park station. This property is also close to Chiswick High Road with its array of bars, restaurants and shops under half a mile away.

Features

- Two Bedrooms
- Modern Bathroom
- Separate Kitchen
- Large Living Area
- Transport Links
- Purpose Built

Rothschild Road, London, W4

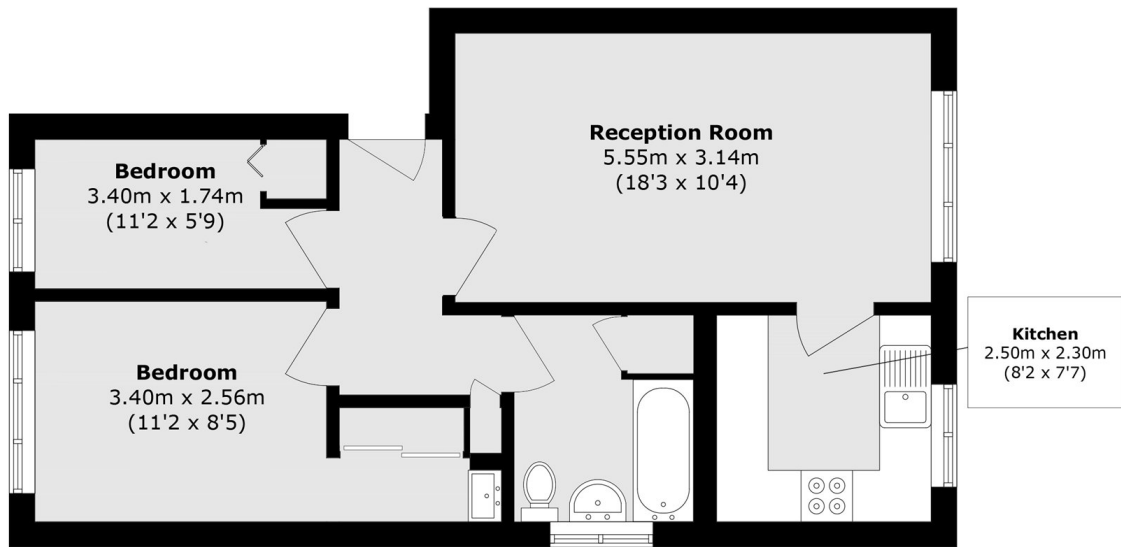

Total area (approx.): 53.4 sq. m (574.8 sq. ft)