



Cyril Bell Close, Lymm, WA13 0JU

£160,000

 1  1  1



NO ONWARD CHAIN – Stunning Canal-Side Apartment For The Over 55s

Superbly refurbished one-bedroom first-floor retirement apartment, enjoying an elevated position with beautiful views over the Bridgewater Canal and surrounding countryside. Ideally located within easy walking distance of Lymm Village Centre and its excellent amenities.

This bright and well-presented home features a spacious lounge with Juliette balcony, a stylish re-fitted kitchen with integrated appliances, a generous double bedroom with fitted wardrobes, and a contemporary shower room.

Banner & Co

Residents benefit from secure entry, an on-site House Manager, communal gardens, laundry facilities, and resident parking.

Early viewing is highly recommended. EPC Rating C.

Key Features

- One bedroom first floor retirement apartment (over 55s)
- Refurbished throughout
- Modern re-fitted kitchen with integrated appliances
- Contemporary shower room with electric shower
- Well-maintained communal gardens and resident parking
- Elevated canal-side location with stunning views
- Bright lounge with Juliette balcony overlooking Bridgewater Canal
- Spacious double bedroom with fitted wardrobes
- Secure entry system with House Manager available
- Walking distance to Lymm Village Centre and local amenities

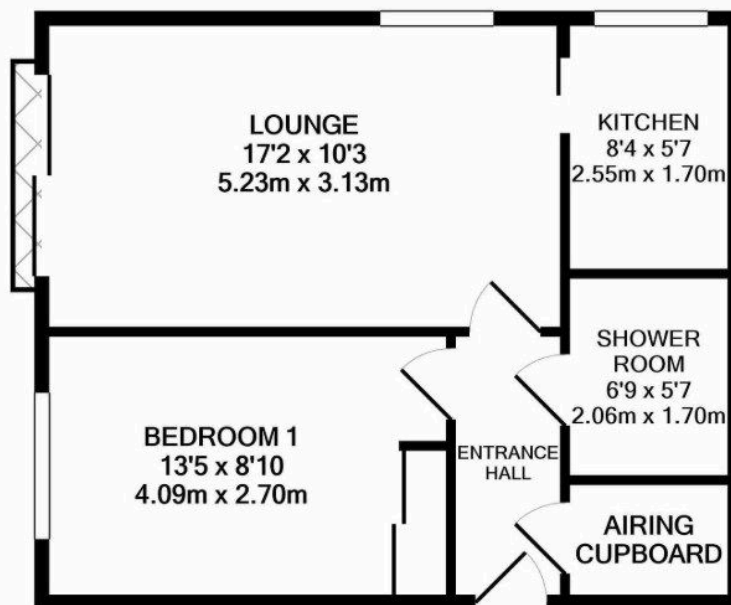

TOTAL APPROX. FLOOR AREA 435 SQ.FT. (40.4 SQ.M.)

Whilst every attempt has been made to ensure the accuracy of the floor plan contained here, measurements of doors, windows, rooms and any other items are approximate and no responsibility is taken for any error, omission, or mis-statement. This plan is for illustrative purposes only and should be used as such by any prospective purchaser. The services, systems and appliances shown have not been tested and no guarantee as to their operability or efficiency can be given

Made with Metropix ©2020