



19 Yates Close  
Weldon, NN17 3LS



**Simpson West**



Introducing the Hadley! A rarely available stone built detached residence with FIVE bedrooms located within the highly regarded Weldon Park. This executive home occupies a highly desirable position at the end of a private drive and is within walking distance to the new school, shops and other amenities. Features include a spacious entrance hall, dining room, living room with stylish bay window, an impressive kitchen dining family room boasting a range of integrated appliances, quartz work surfaces and doors leading to the rear garden. In addition there is a utility room and cloakroom w/c. To the first floor there are four large double bedrooms with the larger benefiting from an en-suite shower room, there is a fifth single bedroom and the main family bathroom. To the rear is a large established garden that is fully enclosed with extended patio area, there is in addition a seating area towards the end of the garden and a large lawn space. The front of the property enjoys views of fields and features a large driveway providing off road parking for multiple vehicles leading to a double detached garage with power and lighting. Early viewings are highly encouraged. Energy rating B. Council Tax Band E.



Offers In Excess Of £430,000

 5  2  2



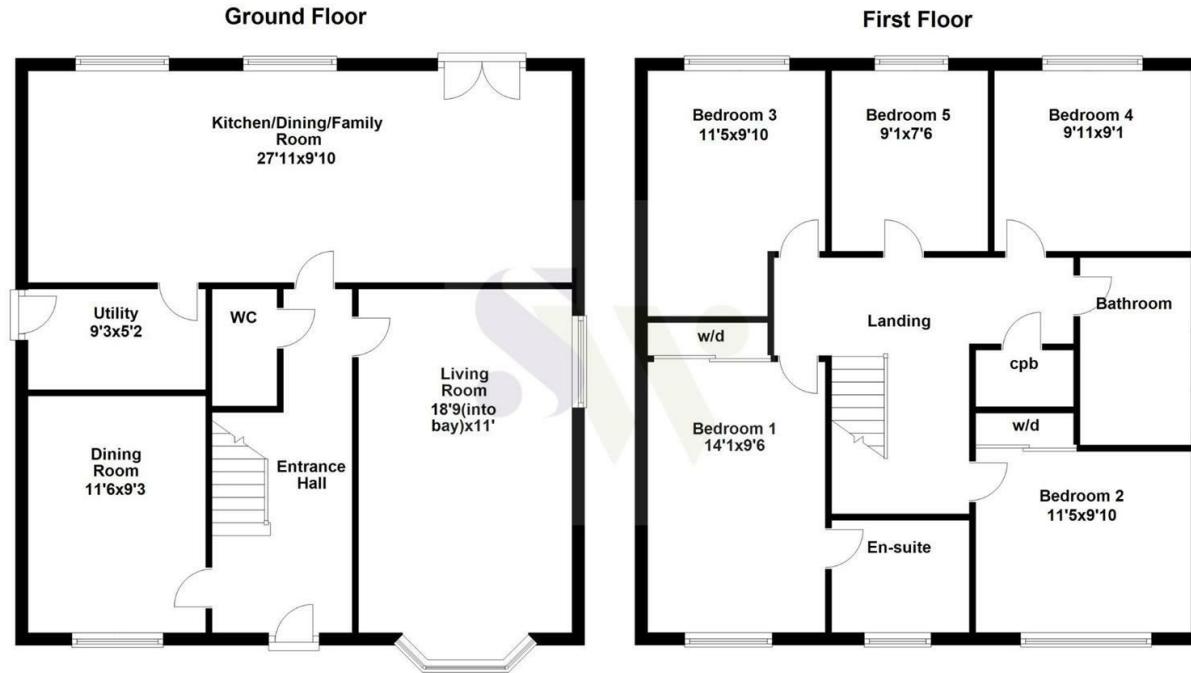

Floor plan not to scale - for guidance purposes only.  
 Floor plan created by Simpson West for their use.  
 Plan produced using PlanUp.

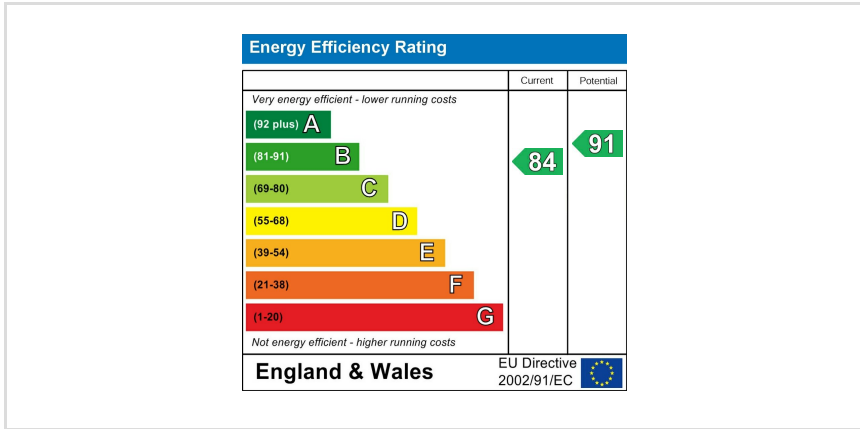



When you buy with Simpson West, you know **you'll be in safe hands**. From the moment you walk through our doors, we'll make you **feel truly welcome**. Our sales consultants and financial advisors will take you through **every step of the process**, offering **free expert advice** along the way, from help choosing the right mortgage and insurance through to finding your conveyancer. And if you need help selling your home too, **with over 20 years of local experience, you can trust us to get you moving**.



**Simpson  
West**

Making Every  
Journey Personal



01536 202007

[info@simpsonwest.co.uk](mailto:info@simpsonwest.co.uk)

<https://www.simpsonwest.co.uk/>

64 Corporation Street, Corby, Northants, NN17 1NH