

Sipson Road

West Drayton • • UB7 0JF
Per Month: £1,600 Per Month



coopers
est 1986

Newly refurbished two bedroom apartment located within the popular Copeswood Court development in Sipson. Finished to a modern standard throughout, the apartments offer bright and spacious living accommodation, contemporary fitted kitchens and bathrooms, and well proportioned bedrooms.

Ideally situated close to Heathrow Airport, excellent transport links, local amenities, and major road networks including the M4 and M25.

Unfurnished and Available Now

Newly Refurbished

Unfurnished

Available Now

Close to Heathrow Airport

Elizabeth Line

Two Bedrooms

Nearby to Stockley Park

Easy Access to the M4

Council Tax Band C

Local Amenities

Available Date

26th May 2026



GROUND FLOOR
627 sq.ft. (58.3 sq.m.) approx.

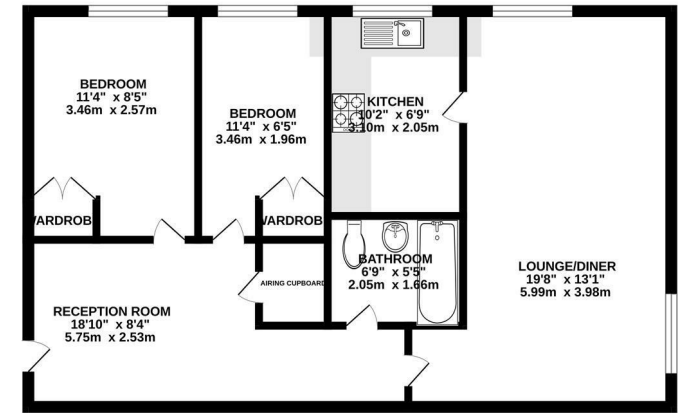

TOTAL FLOOR AREA: 627 sq ft (58.3 sq m) approx.
 Whilst every attempt has been made to ensure the accuracy of the description contained herein, measurements of doors, windows, rooms and any other items are approximate and no responsibility is taken for any error, omission or misstatement. This plan for illustrative purposes only and should be used as such by any prospective purchaser. The services, systems and appliances shown have not been tested and no guarantee as to their operability or efficiency can be given.
 Made with Metropop 02026

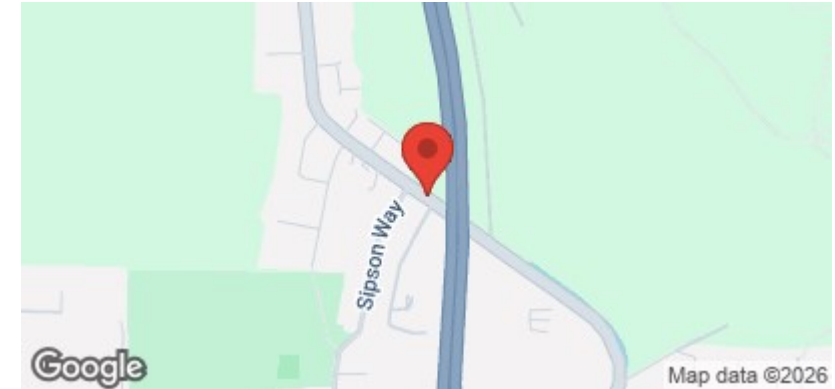

01895 257 566

**1 Vine Street, Uxbridge,
Middlesex, UB8 1QE**

propertymanagement@coopersresidential.co.uk

CoopersResidential.co.uk

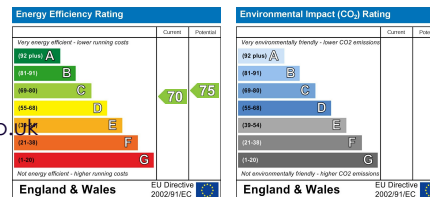

Important Notice: These particulars, whilst believed to be accurate are set out as a general outline only for guidance and do not constitute any part of an offer or contract. Intending purchasers should not rely on them as statements or representation of fact, but must satisfy themselves by inspection or otherwise has the authority to make or give any representation or warranty in respect of the property.

coopers
est 1986