

BRENNAN

BESPOKE

39

BRENNAN
RESPONSE
FOR SALE
01938 904400

OFFERS IN EXCESS OF

£200,000

Bryant Road

Kettering, NN15 6JD

PROPERTY SUMMARY

This two-bedroom semi-detached bungalow on Bryant Road, Kettering, offers a fantastic opportunity for buyers seeking single-level living with scope to personalise and add value. The property is set on a generous plot, featuring a large private lawned garden at the rear—ideal for gardening enthusiasts, outdoor entertaining, or simply enjoying a peaceful green space. Off-road parking is available at the front, providing convenience for residents and visitors. The layout includes a bright lounge with a bay window, a separate kitchen with garden access, two bedrooms, and a bathroom. While the bungalow is in generally good order, some modernisation is required, allowing buyers to update finishes and fittings to their own taste and requirements. Located in a popular residential area of Kettering, Bryant Road is close to local amenities, shops, parks, and transport links, making it a practical choice for downsizers, retirees, or anyone seeking a manageable home with excellent outdoor space.

2



1



1





BRENNAN
BESPOKE

OFFICE ADDRESS
BRENNAN BESPOKE
2 The Tithe Barn Glendon Lodge Farm
Glendon
Kettering
Northamptonshire
NN14 1QF

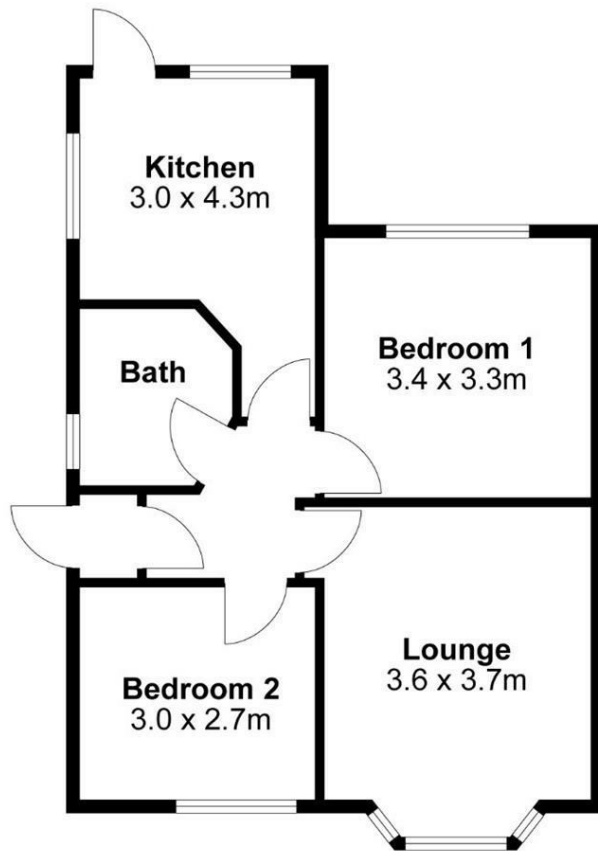

For identification only not to scale

Internal Area Approx. : 53m²

BRENNAN
BESPOKE

OFFICE DETAILS
01536 904400
info@brennanbespoke.co.uk
<https://www.brennanbespoke.co.uk>

LOCAL AUTHORITY

TENURE
Freehold

COUNCIL TAX BAND

VIEWINGS
By prior appointment only

Energy Efficiency Rating		
	Current	Potential
<i>Very energy efficient - lower running costs</i>		
(92 plus) A		
(81-91) B		
(69-80) C		
(55-68) D		
(39-54) E		
(21-38) F		
(1-20) G		
<i>Not energy efficient - higher running costs</i>		
England & Wales	EU Directive 2002/91/EC	

Agents Note: Whilst every care has been taken to prepare these particulars, they are for guidance purposes only. All measurements are approximate and are for general guidance purposes only and whilst every care has been taken to ensure their accuracy, they should not be relied upon and potential buyers/tenants are advised to recheck the measurements