

## Regents Bridge Gardens, SW8

£2,450 Per calendar month

A spacious and well-presented, two double bedroom ground floor flat in a secure gated development close to Vauxhall station. The property also offers a spacious reception room, modern kitchen and a tiled bathroom.

Regents Bridge Gardens is a quiet gated development which benefits from an on-site porter, newly refurbished swimming pool and a gym. Both Vauxhall train and underground stations are within walking distance.

### Features

- Two Double Bedrooms
- Wooden Floors Throughout
- Gated Development
- Refurbished Swimming Pool
- Residents Gym
- Great Location

# Regents Bridge Gardens, London, SW8

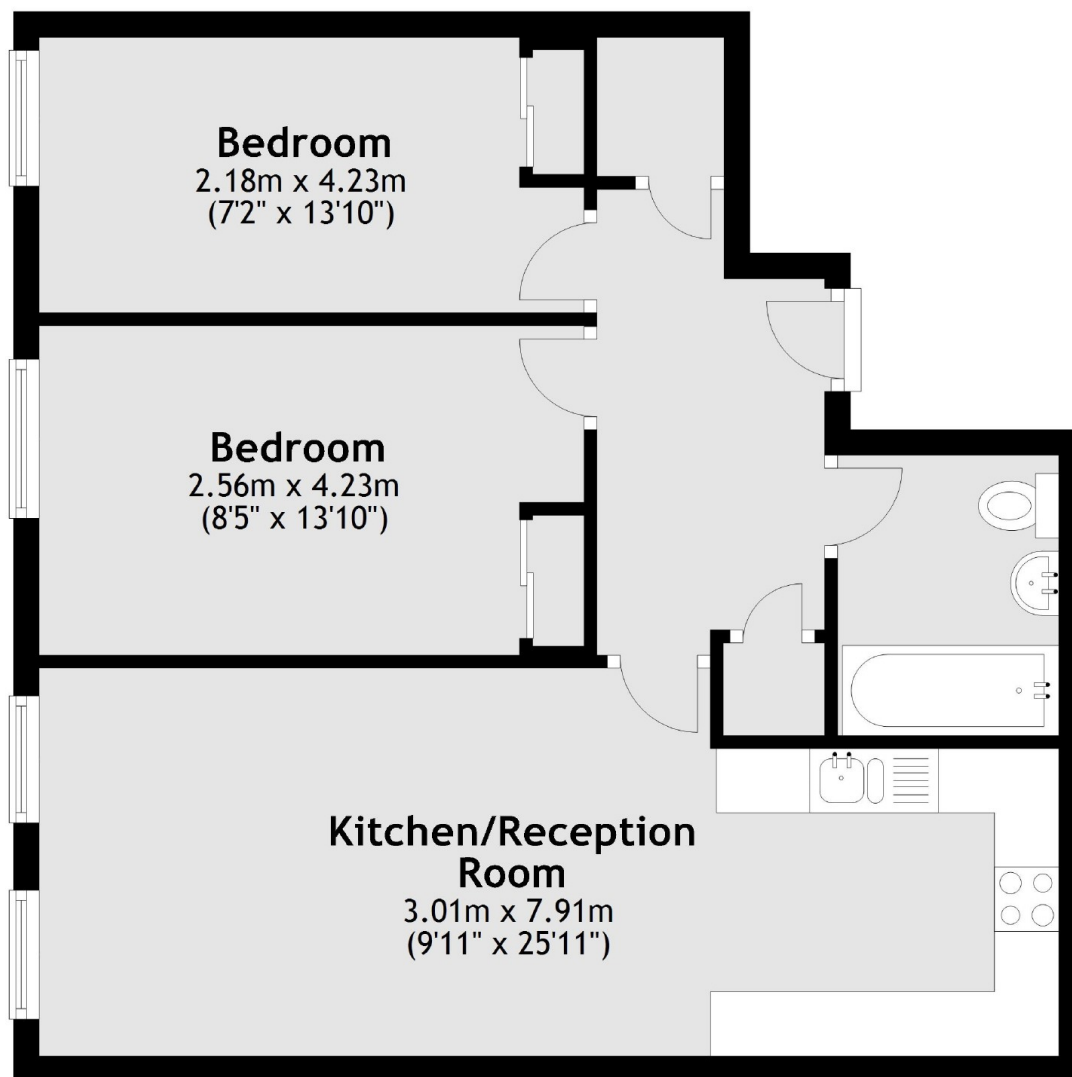

Total area: approx. 55.2 sq. metres (594.3 sq. feet)