

## Wesley Street, Pontefract



**£795 Per Month**



3



1



1



59

This well-presented terraced property in South Elmsall is perfect for families seeking both comfort and convenience. Ideally located close to local schools and transport links, the home offers practical living in a highly accessible area. The private rear garden provides an ideal space for relaxing or entertaining family and friends, with high walls and fencing creating a private and secure feel. The property is currently undergoing full redecoration throughout, giving the home a fresh, modern yet welcoming feel.



- Village Location
- Good-Sized Reception Room
- Open Plan Kitchen Diner
- Three First-Floor Bedrooms
- Family Bathroom
- On Street Parking
- Close to Local Schools and Transport Links
- Redecoration in progress - Further photographs to follow
- Council Tax Band A
- EPC Grade D

Call **01977 285 111** to view this property or visit [www.crownestateagents.com](http://www.crownestateagents.com)

Opening hours:  
Mon - Fri 9am - 5pm  
Sat 10am - 2pm

### Entrance Lobby

### Lounge

12'10" x 15'1" (3.92 x 4.62)

Spacious lounge featuring a window to the front elevation and an electric fireplace, creating a comfortable and welcoming living space.

### Kitchen Diner

10'1" x 15'10" (3.09 x 4.84)

Fitted kitchen/diner comprising a range of wall and base units with complementary work surfaces and tiled surround. Incorporating a single sink drainer, plumbing for a washing machine and a wall-mounted gas boiler. A rear-facing window provides natural light, while the dining area offers practical everyday family living.

### Bedroom One

15'3" x 15'11" (overall) (4.66 x 4.86 (overall))

A spacious first bedroom with a front-facing window, built-in storage cupboard and radiator, offering a comfortable and practical space.

### Bedroom Two

8'3" x 10'1" (2.52 x 3.09 )

Well-proportioned second bedroom featuring a rear-facing window allowing plenty of natural light, along with a radiator, creating a comfortable and versatile space.

### Bedroom Three

7'4" x 10'11" (2.25 x 3.35)

A well-proportioned third bedroom featuring a rear-facing window providing natural light and a radiator, offering a comfortable and versatile space suitable for a variety of uses.

### Family Bathroom

6'9" x 6'11" (2.07 x 2.11)

Family bathroom fitted with a low flush WC, wash hand basin and panelled bath with mixer shower over. Featuring tiled flooring, radiator and a uPVC frosted rear-facing window providing natural light and privacy.

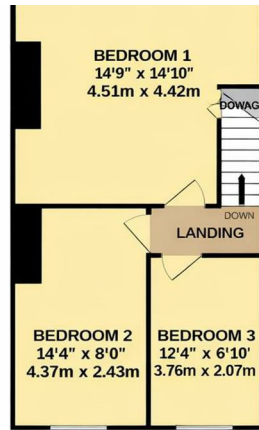
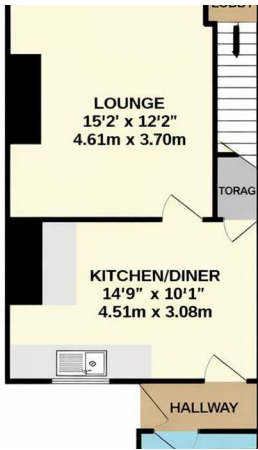

FLOOR PLAN



TOTAL FLOOR AREA: 826 sq ft (76.7 sq m) approx.  
 Whilst every attempt has been made to ensure the accuracy of the floorplan, Crown Estate Agents Ltd does not accept any liability for any errors, omissions or misstatements. The plan is for information purposes only and should not be used as a basis for any prospective purchase. The services, options and appliances shown have not been tested and no guarantee can be given.



**Energy Efficiency Rating**

	Current	Potential
Very energy efficient - lower running costs		
(92 plus) <b>A</b>		
(81-91) <b>B</b>		
(69-80) <b>C</b>		<b>75</b>
(55-68) <b>D</b>	<b>59</b>	
(39-54) <b>E</b>		
(21-38) <b>F</b>		
(1-20) <b>G</b>		
Not energy efficient - higher running costs		

**England & Wales** EU Directive 2002/91/EC

Please call our Castle Dwellings Ltd Office on 01977 285 111 if you wish to arrange a viewing appointment for this property or if you require further information.

These particulars, whilst believed to be accurate are set out as a general outline only for guidance and do not constitute any part of an offer or contract. Intending purchasers should not rely on them as statements of representation of fact, but must satisfy themselves by inspection or otherwise as to their accuracy. No person in this firm's employment has the authority to make or give any representation or warranty in respect of the property.

Call 01977 285 111 to view this property or visit [www.crownestateagents.com](http://www.crownestateagents.com)

Opening hours:  
 Mon - Fri 9am - 5pm  
 Sat 10am - 2pm