



Richmond Place

, Brighton BN2 9NA

- *****AVAILABLE AUGUST*****
- Ground Floor Apartment
- Modern Kitchen With Appliances
- Stones Throw From Station and Bus Routes
- Pet Friendly
- Two Double Bedrooms
- Excellent Condition Throughout
- Central Brighton Location
- Students Welcome

£1,900 PCM

Local Authority Brighton &
Hove City Council
Council Tax Band B
EPC Rating C

GROUND FLOOR
494 sq.ft. (45.9 sq.m.) approx.

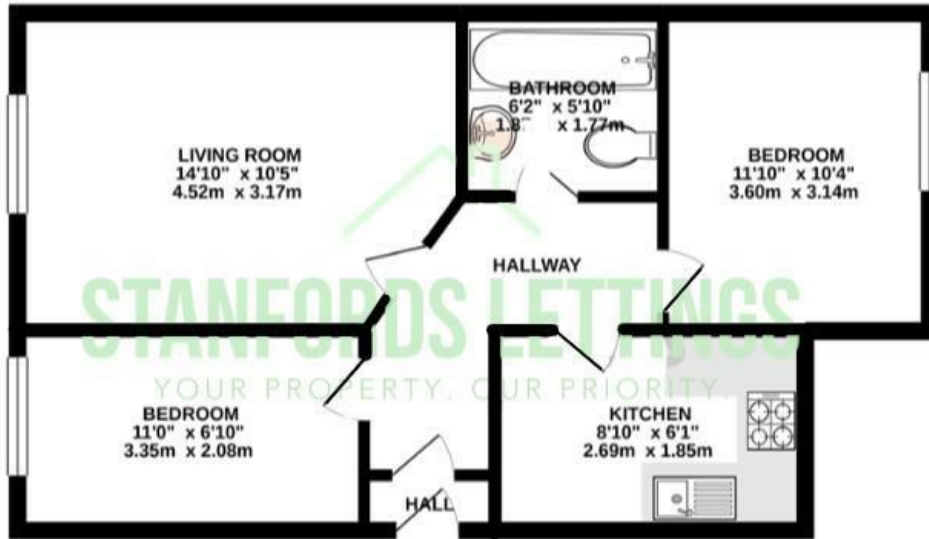

TOTAL FLOOR AREA: 517sq.ft. (48.0 sq.m.) approx.
Whilst every attempt has been made to ensure the accuracy of the figures contained herein, measurements of doors, windows, rooms and any other items are approximate and no responsibility is taken for any error, omission or mis-statement. This plan is for illustrative purposes only and should be used as such by any prospective purchaser. The services, systems and appliances shown have not been tested and no guarantee as to their operability or efficiency can be given.
Made with Metropex ©2023



Moretons Lettings Office
30-31 North Street, Brighton,
East Sussex, BN1 1EB

Contact

Agents Note: Whilst every care has been taken to prepare these particulars, they are for guidance purposes only. All measurements are approximate and for general guidance purposes only and whilst every care has been taken to ensure accuracy, they should not be relied upon and potential buyers/tenants are advised to recheck the measurements.