



1

Bedroom



1

Bathroom

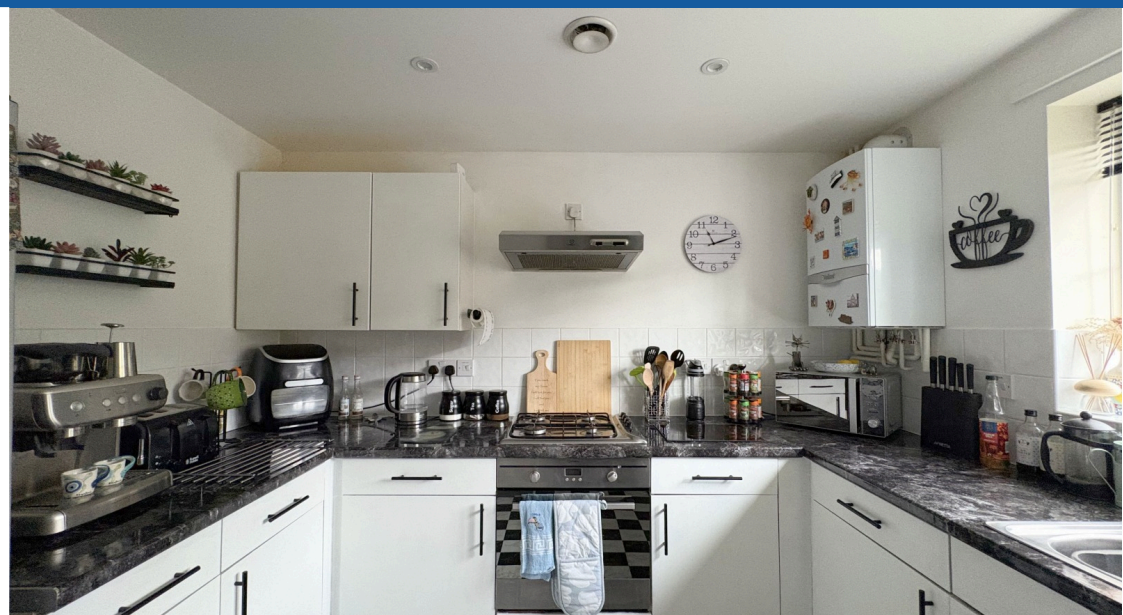

- Ground Floor Flat
- Kitchen
- Lounge with Storage Cupboard
- Double Bedroom
- Family Bathroom
- Open Outdoor Space
- Off Road Parking
- Gas Central Heating
- UPVC Double Glazing
- Close to Local Amenities
- Bus Route

Wilkinson SLM are pleased to bring to market, a well presented one bedroom ground floor flat, located in the popular development of Northway. The location is walking distance to local amenities, within the school catchment area and a close commute to the M5. Within a bus route to Tewkesbury Town, Cheltenham and Gloucester and a short walk to the new Designer Outlet, this is not one to miss!

The ground floor flat has its own front door, welcoming a light and airy hallway. To the right of the hallway is a kitchen with an array of base and wall units, as well as a built in electric oven and gas hob. There is space and plumbing for a washing machine and space for a fridge freezer. To the left of the hallway is a family bathroom.

There is also a spacious lounge with a useful storage cupboard and French doors opening out to the outdoor space which is mainly gravelled. Completing the living accommodation is a double bedroom with a convenient built in double wardrobe.

Further benefits to this home include UPVC double glazing, gas central heating and allocated off road parking.

This is a perfect opportunity for first time buyers and rental investors - a viewing comes highly recommended!

Lease Length - 123 years left

Service Charge - £185 (incl Vat) per annum

Peppercorn Rent

Lounge 13' 2" x 14' 0" (4.01m x 4.27m)
maximum measurements

Kitchen 9' 11" x 9' 1" (3.02m x 2.77m)

Bedroom 15' 11" x 8' 6" (4.85m x 2.59m)
maximum measurements

Bathroom 7' 2" x 8' 6" (2.18m x 2.59m)

Ground Floor

Approx. 49.6 sq. metres (533.6 sq. feet)

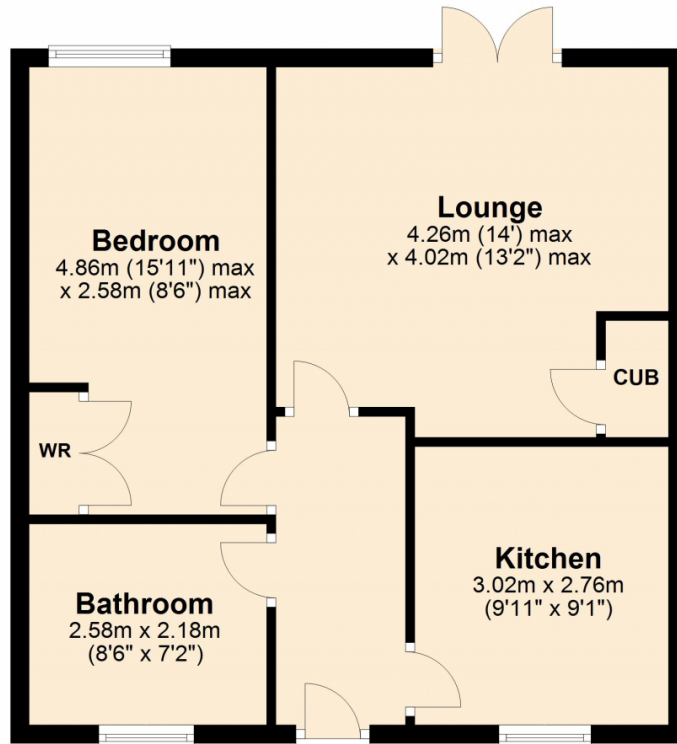

Total area: approx. 49.6 sq. metres (533.6 sq. feet)

This plan is not to scale and is for guidance only. Produced by PlanUp.
Plan produced using PlanUp.



Coming soon

