



## Thornbury Road

Isleworth, TW7

£650,000

Well presented throughout, this beautiful three double bedroom home is full of history. Set in the Old Station Masters House, the property is offered with no forward chain and is ideally located for access to Syon Lane train station, Osterley tube station, the beautiful green spaces of Osterley Park, a choice of excellent local schools, including the popular Nishkam School and amenities. The welcoming hallway invites you in and leads to a dining room and spacious reception room, a bespoke fitted kitchen, utility room and modern shower room. The first floor offers three double bedrooms and a separate WC. Externally the property benefits from a large, well kept rear garden with a large outbuilding and side access. Further benefits include access to a basement space, gas central heating, double glazing throughout the property and resident permit parking. There is potential to extend the property subject to the relevant planning consent.



- No Forward Chain
- Beautiful Family Home
- Three Double Bedrooms
- Stunning Rear Garden
- Sought-after Location
- Separate W/C
- Close to Osterley Park
- Utility Room
- Potential to Extend (STPP)
- Spacious Basement Space

SCAN HERE  
FOR  
PROPERTY  
DETAILS



OAKHILL

GROUND FLOOR  
438 sq.ft. (40.7 sq.m.) approx.

1ST FLOOR  
394 sq.ft. (36.6 sq.m.) approx.

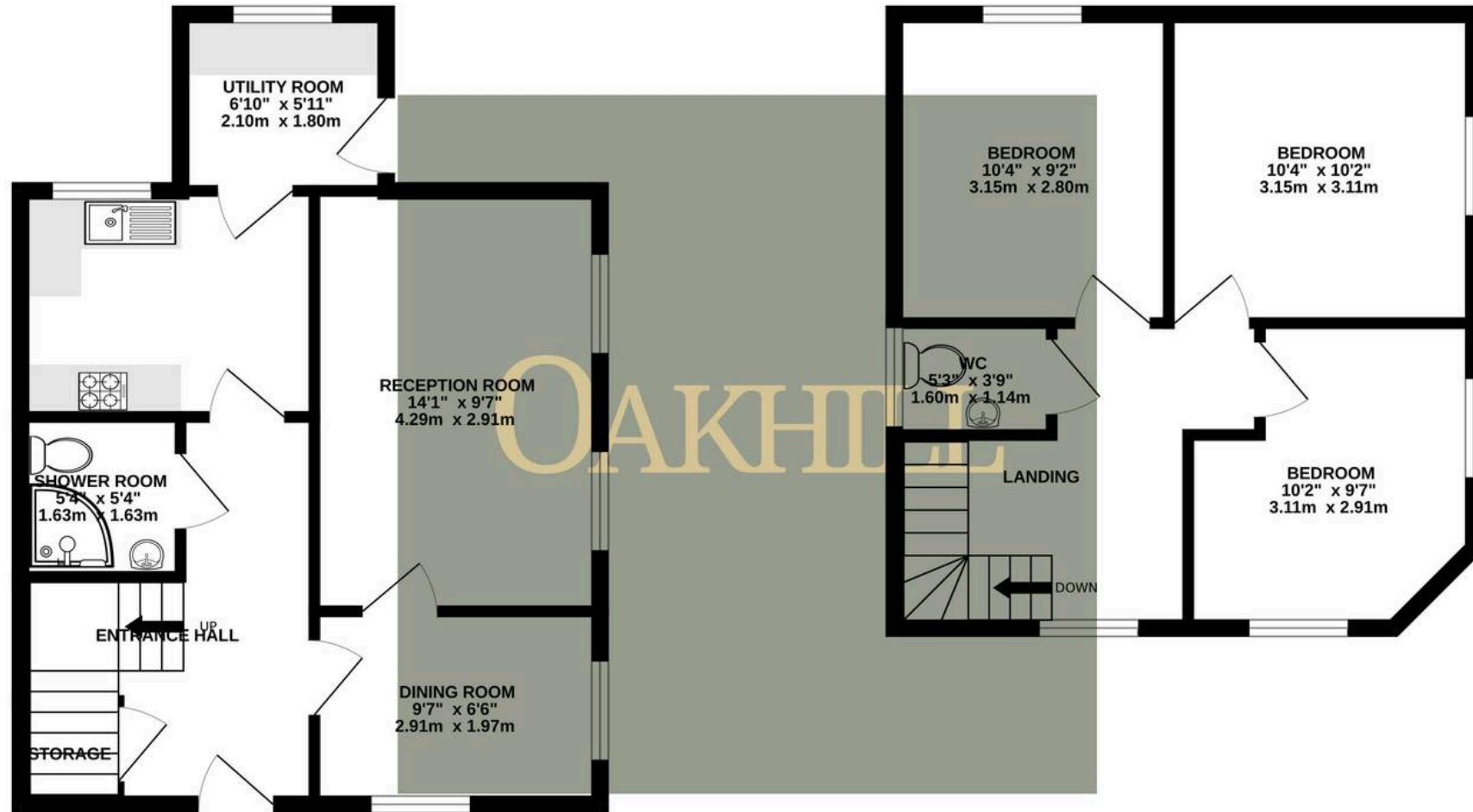

TOTAL FLOOR AREA : 833 sq.ft. (77.3 sq.m.) approx.

Whilst every attempt has been made to ensure the accuracy of the floorplan contained here, measurements of doors, windows, rooms and any other items are approximate and no responsibility is taken for any error, omission or mis-statement. This plan is for illustrative purposes only and should be used as such by any prospective purchaser. The services, systems and appliances shown have not been tested and no guarantee as to their operability or efficiency can be given.  
Made with Metropix ©2024

