



Tom Milford Place, Watton Thetford IP25 6UN

welcome to

Tom Milford Place, Watton Thetford

>> CHAIN-FREE! A well-presented two-bedroom mid-terraced home in the vibrant market town of Watton, offering great transport links, local amenities, low-maintenance gardens and allocated parking. Ideal for first-time buyers, investors or those looking to downsize.



Porch

Carpet flooring, Radiator, UPVC door to the front aspect, Stairs leading to first floor

Lounge

13' 4" x 12' (4.06m x 3.66m)

Carpet flooring, Radiator, double glazed window to the front aspect, Storage cupboard

Kitchen/Diner

16' 5" x 8' (5.00m x 2.44m)

Vinyl flooring, Radiator, Range of wall mounted low-level units, Inset 1.5 sink/drain, Space for oven, Space for washing machine, Space for fridge freezer, Two double glazed windows to the rear aspect, UPVC Double glazed door to the rear aspect

Bedroom 1

13' 1" x 8' 8" (3.99m x 2.64m)

Carpet flooring, Radiator, Double glazed window to the front aspect, Storage cupboard

Bedroom 2

11' 8" x 9' 3" (3.56m x 2.82m)

Carpet flooring, radiator, double glazed window to the rear aspect

Bathroom

Vinyl flooring, Frosted double glazed window to the rear aspect, Panelled bath with overhead shower, Low-level WC, Handwash basin



view this property online williamhbrown.co.uk/Property/WAT108943



welcome to

Tom Milford Place, Watton Thetford

- Chain- Free Property
- Spacious Lounge and Kitchen/Diner
- Two Well-Proportioned Bedrooms
- Allocated Rear Parking Space
- Front and Rear Garden

Tenure: Freehold EPC Rating: C
Council Tax Band: A

offers over
£160,000

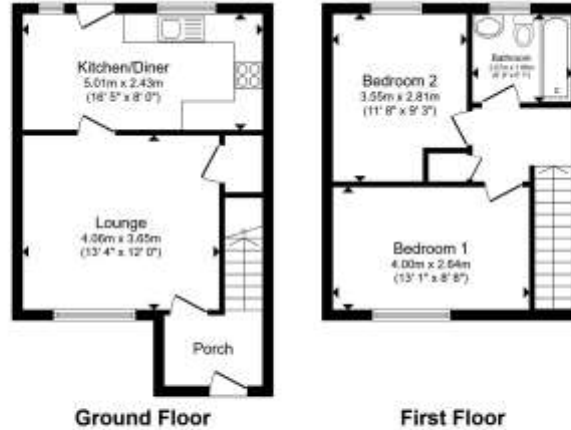

Total floor area 65.2 m² (702 sq.ft.) approx
This floor plan is for illustrative purposes only. It is not drawn to scale. Any measurements, floor areas (including any total floor area), openings and orientation are approximate. No details are guaranteed, they cannot be relied upon for any purpose and they do not form part of any agreement. No liability is taken for any error, omission or misstatement. A party must rely upon its own inspections. Powered by viewproperty.co.uk



Please note the marker reflects the
postcode not the actual property

view this property online williamhbrown.co.uk/Property/WAT108943



Property Ref:
WAT108943 - 0006

1. MONEY LAUNDERING REGULATIONS Intending purchasers will be asked to produce identification documentation at a later stage and we would ask for your co-operation in order that there is no delay in agreeing the sale. 2. These particulars do not constitute part or all of an offer or contract. 3. The measurements indicated are supplied for guidance only and as such must be considered incorrect. Potential buyers are advised to recheck measurements before committing to any expense. 4. We have not tested any apparatus, equipment, fixtures or services and it is in the buyers interest to check the working condition of any appliances. 5. Where an EPC, or a Home Report (Scotland only) is held for this property, it is available for inspection at the branch by appointment. If you require a printed version of a Home Report, you will need to pay a reasonable production charge reflecting printing and other costs. 6. We are not able to offer an opinion either written or verbal on the content of these reports and this must be obtained from your legal representative. 7. Whilst we take care in preparing these reports, a buyer should ensure that his/her legal representative confirms as soon as possible all matters relating to title including the extent and boundaries of the property and other important matters before exchange of contracts.

William H Brown is a trading name of Sequence (UK) Limited which is registered in England and Wales under company number 4268443, Registered Office is Cumbria House, 16-20 Hockliffe Street, Leighton Buzzard, Bedfordshire, LU7 1GN. VAT Registration Number is 500 2481 05.

william h brown



01953 881951



Watton@williamhbrown.co.uk



9 High Street, Watton, THETFORD, Norfolk,
IP25 6AB



williamhbrown.co.uk