

17 Cooks Close - Guide Price £270,000

Halstead CO9 1YE

shires

Estate & Letting Agents



"Consistently providing outstanding service to our clients"

Guide Price £270,000

The Property

Nestled in the charming area of Cooks Close, Halstead, this delightful house presents an excellent opportunity for those seeking a comfortable and inviting home. The property boasts a well-proportioned reception room, perfect for both relaxation and entertaining guests. With two spacious bedrooms, there is room for a small family or for those wishing to have a guest room or home office.

The bathroom is conveniently located, ensuring ease of access for all residents. The house is designed to provide a warm and welcoming atmosphere, making it an ideal retreat after a long day.

Halstead itself is a picturesque town, offering a blend of historical charm and modern amenities. Residents can enjoy local shops, cafes, and parks, all within a short distance. The community is known for its friendly atmosphere, making it a wonderful place to settle down.

This property is perfect for first-time buyers, small families, or those looking to downsize. With its appealing features and prime location, this house in Cooks Close is a must-see for anyone looking to make Halstead their home. Don't miss the chance to explore this lovely property and envision your future in this delightful setting.

Features

- TWO DOUBLE BEDROOMS
- ADJACENT TO FIELDS
- NICE END PLOT
- IDEAL FOR FIRST TIME BUYERS
- PRIVATE LOCATION
- PARKING WITH VISITORS SPACES
- CLOSE TO LOCAL AMENITIES
- LARGE KITCHEN/DINER
- GOOD SIZED LOUNGE
- EARLY VIEWING ADVISED





These sales particulars have been produced as a general guide only and we would draw to your attention that we have not carried out a detailed Survey of the property nor have we tested services, appliances or specific fittings. Whilst measurements and statements given within the details are provided in good faith, their accuracy should not be relied upon. If there are any points about which you may be uncertain or would like further clarification, we would suggest that you telephone this office and speak to our staff who will endeavour to assist you.

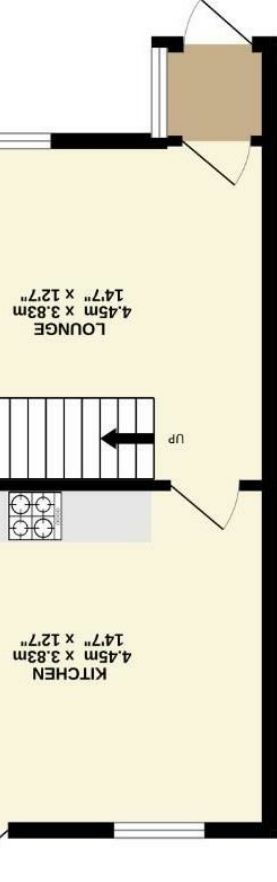

GROUND FLOOR
35.4 sq.m. (381 sq.ft.) approx.



1ST FLOOR
34.0 sq.m. (366 sq.ft.) approx.

Whilst every attempt has been made to ensure the accuracy of the description contained herein, measurements of doors, windows, corners and any other items are approximate and no responsibility is taken for any error, omission or mis-statement. This plan is for illustrative purposes only and should be used as such by any prospective purchaser. The services, systems and appliances shown have not been tested and no guarantee as to their operating or efficiency can be given.
Made with Metropix 6.0.25

