



15 Union Way
Witney, Oxfordshire OX28 6HD

15 Union Way, Witney, Oxfordshire OX28 6HD

A very appealing 5 bedroom detached family house, set in a quiet position in a small close near the town centre. This attractive property is presented in excellent condition and provides a spacious and light living space throughout. The accommodation comprises a large hallway, a cloakroom, living room and dining area plus a refitted kitchen/breakfast room with appliances, and a utility room. The first floor offers 5 bedrooms, including a large main bedroom and ensuite, a spacious landing, and a family bathroom. There is a garage and driveway parking to the front, and private gardens to the rear.

Material Information - sourced via Ofcom:

All mains are connected. Ultrafast broadband is available. Mobile & Data Signals - outdoor: good for EE, O2. Three & Vodafone.

Directions

From Witney town centre, proceed along Corn Street to the roundabout, taking the third exit onto Tower Hill. Take the second right hand turn into Union Way. The property can then be found at the end of the close, on the right hand side.

Draft details - may be subject to alterations. 06E26





GROUND FLOOR

Entrance Hall

Cloakroom

Living Room

Dining Area

Refitted Kitchen/Breakfast Room

Utility Room

FIRST FLOOR

Spacious Landing

5 Bedrooms

Ensuite

Family Bathroom

Double Glazing

Gas Central Heating

OUTSIDE

Long Garage

Driveway Parking

Private Rear Garden

Easy Walking Distance To The Town Centre

Price £725,000 Freehold
WODC Tax Band F / EPC Rating: 70/C



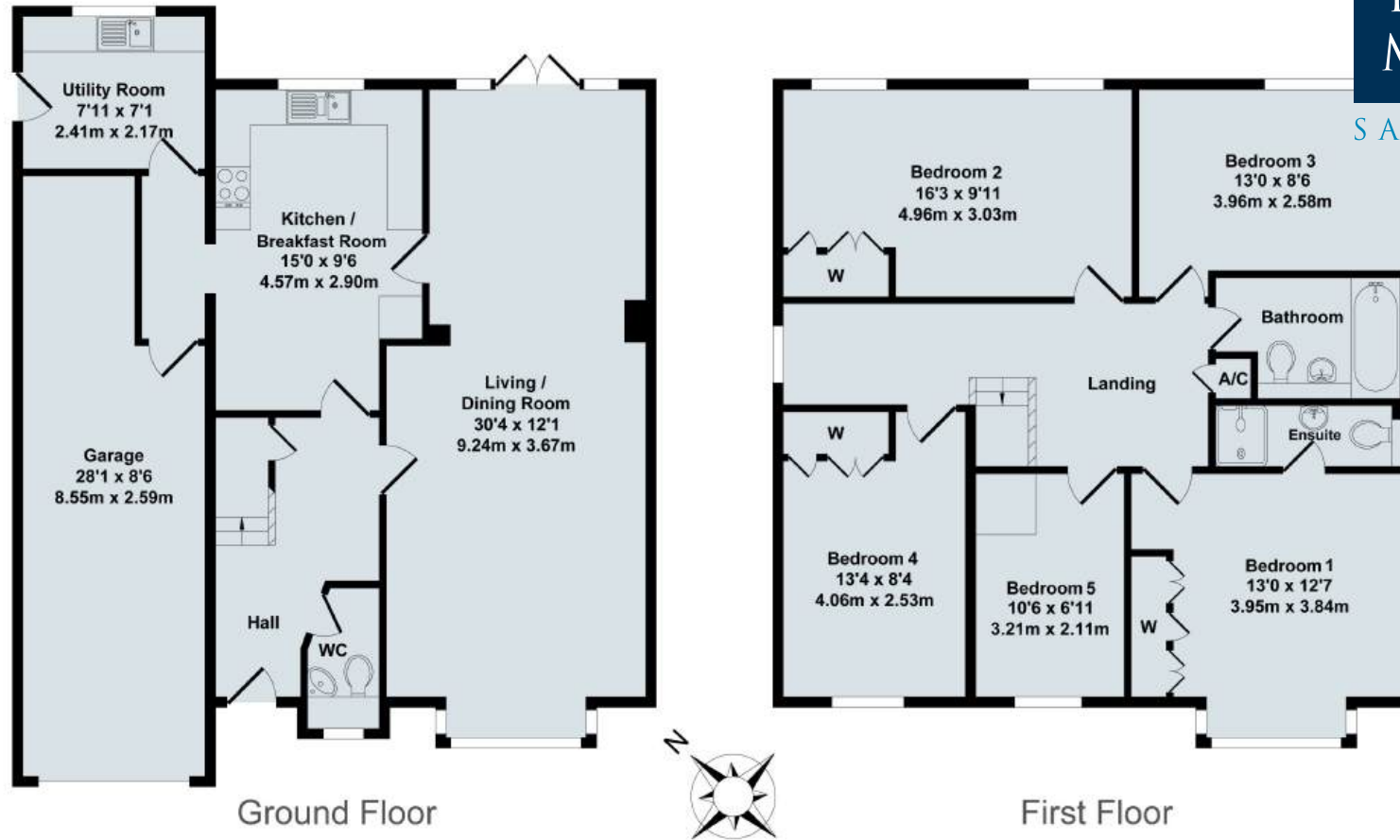

15 Union Way, Witney

Total Approx. Floor Area 1741 Sq.Ft. (161.70 Sq.M.)

All items illustrated on this plan are included in the "Total Approx Floor Area"

Contact:

52 Market Square, Witney, Oxfordshire, OX28 6AF

Tel: 01993 772000 Email: witney@thomasmerrifield.co.uk

Importance Notice

Thomas Merrifield and their clients give notice that:

1. They are not authorised to make or give any representations or warranties in relation to the property either here or elsewhere, either on their own behalf or on behalf of their client or otherwise. They assume no responsibility for any statement that may be made in these particulars. These particulars do not form part of any offer or contract and must not be relied upon as statements or representations of fact.

2. Any areas, measurements or distances are approximate. The text, photographs and plans are for guidance only and are not necessarily comprehensive. It should not be assumed that the property has all necessary planning, building regulation or other consents and Thomas Merrifield have not tested any services, equipment or facilities. Purchasers must satisfy themselves by inspection or otherwise.