



## The Elms

Chester Le Street DH2 3EJ

£139,950







This footer paragraph is an example only and should not be relied upon as complying with current legislation. These particulars, whilst believed to be accurate are set out as a general outline only for guidance and do not constitute any part of an offer or contract. Intending purchasers should not rely on them as statements of representation of fact, but must satisfy themselves by inspection or otherwise as to their accuracy. No person in this firms employment has the authority to make or give any representation or warranty in respect of the property.

# The Elms

Chester Le Street DH2 3EJ



Nestled in the heart of Chester-le-Street, The Elms presents a remarkable opportunity for those aged 55 and over seeking a comfortable and secure living, high calibre environment. This delightful apartment boasts 100% ownership and has been recently redecorated and recarpeted throughout, ensuring a fresh and inviting atmosphere.

Upon entering, you are welcomed by a communal entrance leading to your own private space. The entrance hall opens into a spacious lounge, which features a charming balcony that overlooks the beautifully maintained, landscaped communal gardens—perfect for enjoying a morning coffee or an evening breeze. The new superbly refitted kitchen is equipped with new built-in appliances, making it a joy for any home cook.

This apartment comprises of two generously sized bedrooms, with the second bedroom offering a lovely Juliet balcony, allowing for plenty of natural light. The walk-in shower room is modern and practical, catering to all your needs. Additionally, the property benefits from underfloor heating and UPVC double glazed windows and doors, ensuring warmth and comfort throughout the year.

The Elms is not just a residence; it is a purpose-built community, designed to support independent living in attractive surroundings. Residents can enjoy a range of facilities, including hairdressing services, a cafe, laundry room, lifts and communal lounges. For those with mobility needs, scooter storage is available, and guest accommodation can be arranged if required. Should you need additional services such as meals, bathing, or 24-hour care, these can be provided at an extra cost.

This highly sought-after apartment is offered with immediate vacant possession, making it an ideal choice for those looking to move quickly. We encourage you to call early for a viewing to fully appreciate the charm and convenience this property has to offer.

There is also an opportunity to purchase some new furniture via separate negotiation.

Costings attached  
EPC B

**COMMUNAL ENTRANCE**

**ENTRANCE HALL**

## LOUNGE

15'11" x 10'8" (4.85m x 3.25m)

## KITCHEN

10'10" x 8'3" (3.30m x 2.51m)

## BEDROOM 1

16' x 9'9" (4.88m x 2.97m)

## BEDROOM 2

11'11" x 7'10" (3.63m x 2.39m)

## SHOWER ROOM/WC

## OUTSIDE

## COSTINGS ATTACHED

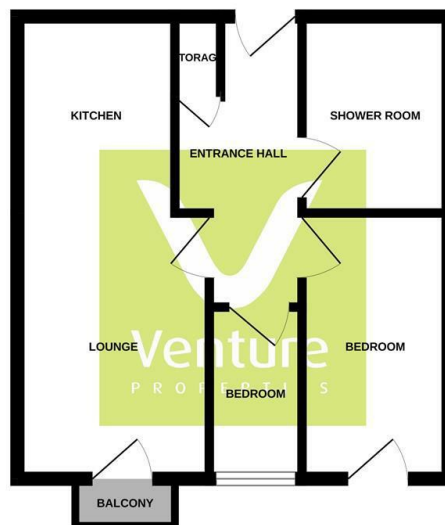

Whilst every attempt has been made to ensure the accuracy of the floorplan contained herein, measurements of doors, windows, rooms and any other items are approximate and no responsibility is taken for any error, omission or mis-statement. This plan is for illustrative purposes only and should be used as a guide only. Prospective purchasers should verify the accuracy of the floorplan and measurements before making any offer or purchase. The services, systems and appliances shown have not been tested and no guarantee as to their operability or efficiency can be given. Made with Lettingmap ©2025

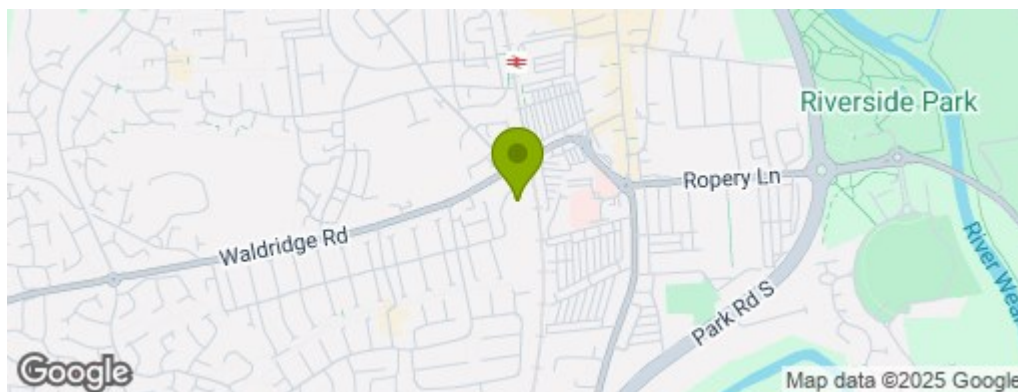

## Property Information

**0191 372 9898**

Suite 6, 15 North Burns, Chester-le-Street, County Durham, DH3 3TF  
[sales.cls@venturepropertiesuk.com](mailto:sales.cls@venturepropertiesuk.com)