



**Noel Road, Acton, London W3 0JD**  
**Price £950,000 Freehold - No Chain**

**With potential for development. An extended 3-bedroom semi-detached property arranged over two floors with a garage and drive. There is a very large (approx 182ft) south-facing rear lawn garden with spacious side access giving development potential as well as ground floor and loft extensions (subject to the usual regulations).**

**Ground floor** - entrance hall leads to 2 good sized reception rooms, conservatory and an extended kitchen.

**First floor** - three bedrooms and a family bathroom with a separate WC.

**Outside** - the rear lawn garden is south-facing and approximately 182ft x 20ft (55.53m x 6.24m) with a garage at the side and off-street parking.

Conveniently situated approx 0.2 miles from **Acton Main Line** station (Elizabeth line) into Central London or to **Ealing Broadway** and beyond for further main train connections and 0.7 miles from **West Acton** station and local shops. The open spaces of North Acton playing fields are close by. Road links include the A40 and A406.

Well-placed for a number local schools including Ellen Wilkinson High, Ark Soane Academy and Twyford CofE High. Primary schools include St Vincent's Catholic, West Acton and John Perryn.

# Noel Road, London, W3

Approximate Area = 1323 sq ft / 122.9 sq m

Garage = 167 sq ft / 15.5 sq m

Total = 1490 sq ft / 138.4 sq m

For identification only - Not to scale

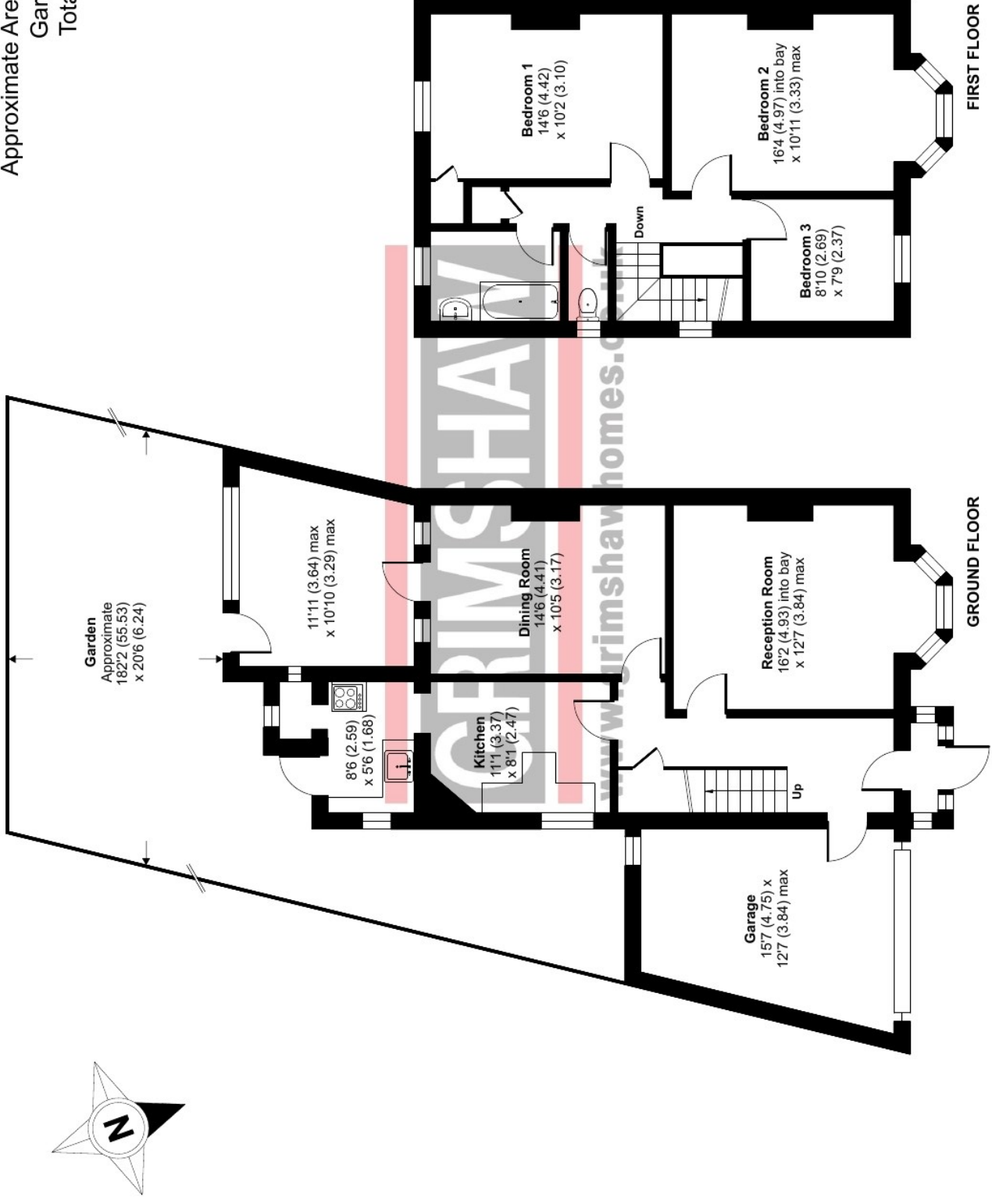





EPC Rating = C

Council tax band = F (£3,088.98 for 2026 / 2027)

Local authority: London Borough of Ealing

Parking: Garage at the side, off-street parking and controlled parking zone (Gypsy Corner Zone CC)

Accessibility: Internal staircase

Connected services and utilities: Gas supply (boiler and mains gas heating): electricity supply: mains drainage: no broadband: no CCTV: landline connected: partly boarded loft: there is right of way to an alleyway

Surface water : 'Low' means between 0.1% and 1% chance of a flood each year.

Rivers and sea: 'Very low' means less than 0.1% chance of a flood each year.

All subject to confirmation

**VIEWING BY APPOINTMENT - All negotiations should be conducted through Grimshaw & Company, who will be pleased to arrange appointments and provide further information.**

Any reference to the term "period" denotes period-style. Services, heating, appliances, any security and drainage systems have not been tested. Internal photographs are reproduced for general information only and it must not be inferred that any item shown therein is included with the property. Where double-glazing is mentioned, it must not be inferred that each and every door and window in the property is double-glazed. Trade Names: Where trade names are mentioned, you are advised to verify these with the vendor to your own satisfaction. All property measurements are approximate and have been taken with an electronic tape into bays and alcoves as appropriate. These particulars do not form part of any offer or contract nor can their accuracy be relied upon by purchasers, who should satisfy themselves by inspection or otherwise. Neither Grimshaw & Company nor any person in their employment has any authority to make or give any warranty whatever in relation to any property. No responsibility can be accepted for any loss of expenses incurred in viewing in relation to any property.

20.04.2026 Ref: 10068

Grimshaw and Co, 5 Station Parade, Ealing Common, London W5 3LD