



Kilburn Lane, W10

£495,000

A one bedroom flat in a newly built development, offering a bright open-plan living space with access to a private balcony. The property features a spacious bedroom with ample storage and a modern three-piece bathroom. The flat has access to a communal roof terrace with 360 degree views of London.

The Old Dairy is ideally located within easy reach of Queen's Park station, offering excellent transport links into central London via the Bakerloo line and London Overground. It is also close to the popular amenities of Salusbury Road, known for its cafés, restaurants, and independent shops, as well as nearby Queen's Park.

Features

- One Bedroom
- Private Balcony
- Landscaped Courtyard
- Communal Roof Terrace
- Excellent Condition
- Close to Transport Links

Kilburn Lane, London, W10

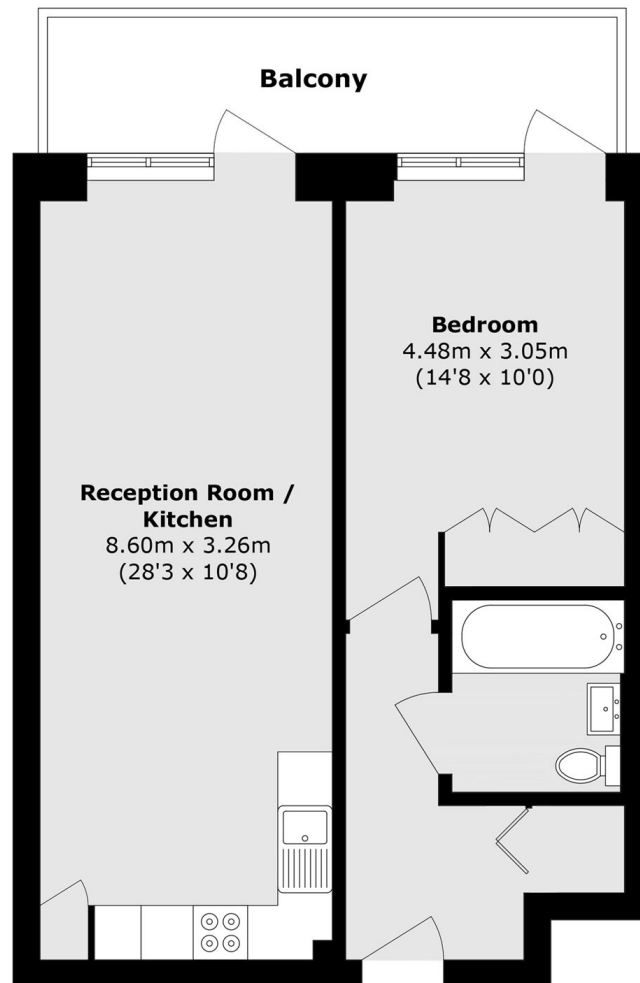

Total area (approx.): 54.5 sq. m (586.6 sq. ft)

Balcony area (approx.): 9.4 sq. m (101.1 sq. ft)