



MARSHAM STREET, SW1P

£4,300 pcm

A beautifully presented three-bedroom, two-bathroom apartment on the third floor of the sought-after Romney House. Offered fully furnished, the property features a modern open-plan living space with fitted kitchen, a spacious en-suite master bedroom, two further double bedrooms, 24-hour concierge, residents' gym, and a communal courtyard garden.

- Three Bedroom
- Two Bathrooms
- Open Plan Kitchen
- Furnished
- Concierge
- Residents Gym



ABOUT THE HOME

Ideally located near the transport links of Pimlico Station, St James's Park Station, and Westminster Station you are within easy reach of central London.





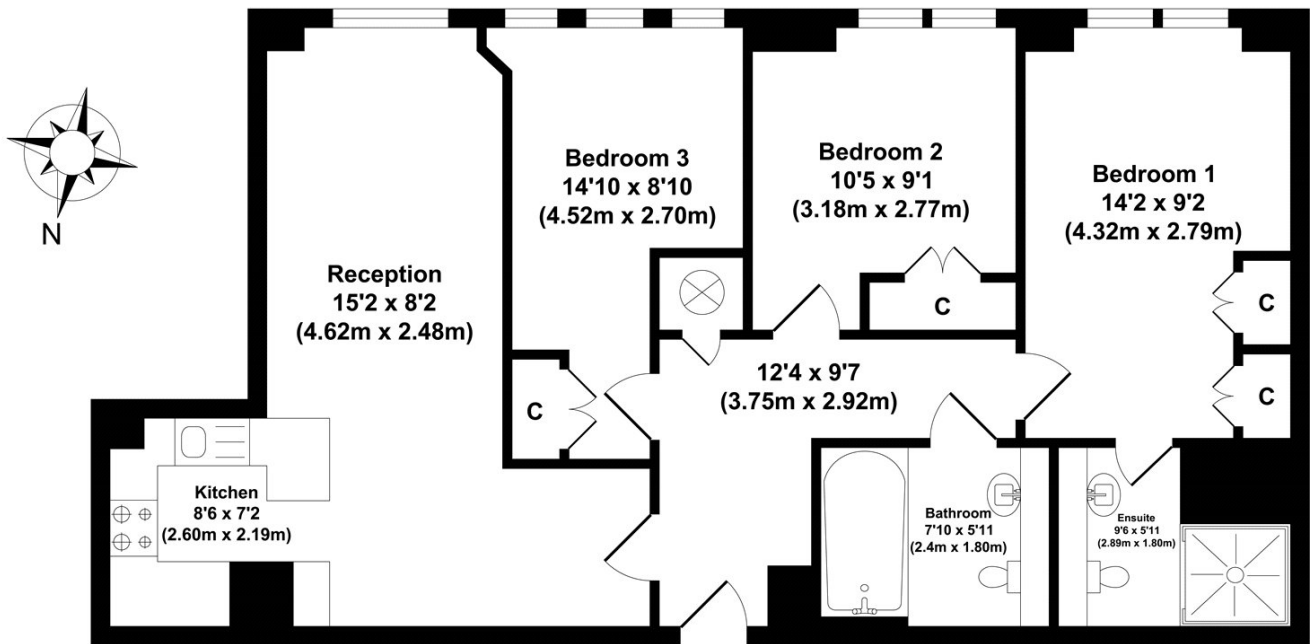

TOTAL APPROX FLOOR AREA 801 SQ.FT. (74.44 SQ.M)

whilst every attempt has been made to ensure the accuracy of the floor plan contained here, measurements of doors, windows, rooms and any other items are approximate and no responsibility is taken for any error, omission or mis-statement. This plan is for illustrative purposes only and should be used as such by any prospective purchaser. The services, systems and appliances shown have not been tested and no guarantee as to their operability or efficiency can be given.

LiFE RESIDENTIAL

11 Flagstaff House, London,
SW8 2LZ
Sales: 020 7476 1408
Lettings: 020 7582 7989

Energy Rating: C. We aim to make our particulars both accurate and reliable. However they are not guaranteed; nor do they form part of an offer or contract. If you require clarification on any points then please contact us, especially if you're traveling some distance to view. Please note that appliances and heating systems have not been tested and therefore no warranties can be given as to their good working order.