

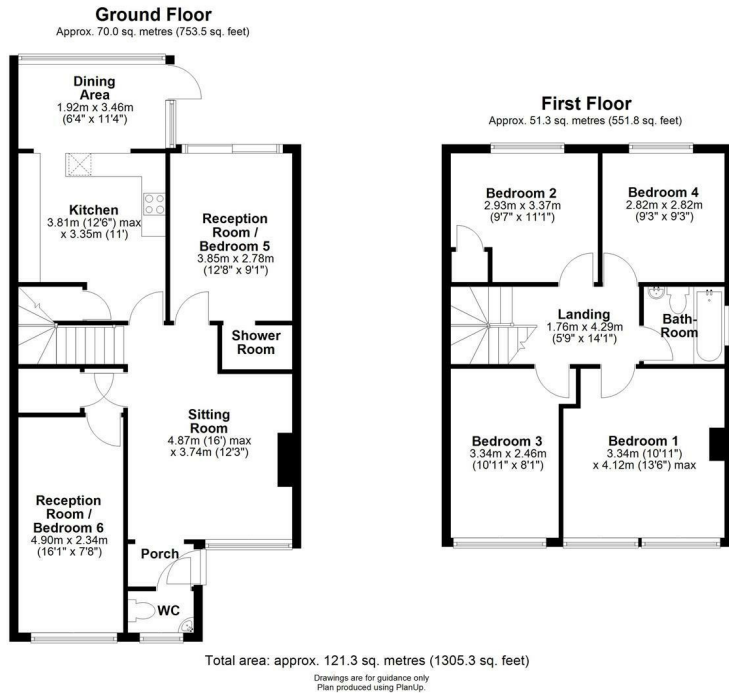

49 Mill End Road, Cambridge, CB1 9JW
£3,000 Per month





- 6 bedroom property
- Fully furnished
- Excellent location
- Off-road parking and garden

A large six bedroom furnished house, ideal for a group of sharers, located within close proximity to the railway station and Addenbrookes Hospital.

The property comprises entrance hall with downstairs W/C. This leads through to the very good size living room with sofa's and coffee table. From the living room is the kitchen with a range of cabinets and appliances, and a dining area at the rear which overlooks the rear garden as well as providing rear access. On the ground floor there are two double bedrooms, one of which benefits from it's own shower room.

Upstairs there are four further bedrooms and the shared bathroom. All bedrooms are fully furnished. The property also benefits from a good sized garden to the rear, and driveway for up to three cars.

The property is available to let from August. Council tax band D. EPC C

///hiking.supply.fetch

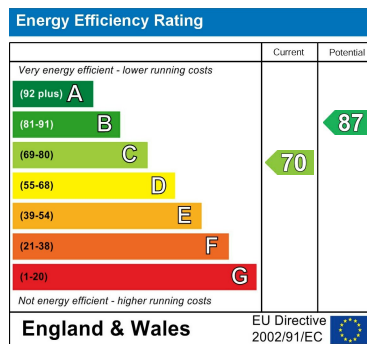

These particulars, whilst believed to be accurate are set out as a general outline only for guidance and do not constitute any part of an offer or contract. Intending purchasers should not rely on them as statements of representation of fact, but must satisfy themselves by inspection or otherwise as to their accuracy. No person in this firm's employment has the authority to make or give any representation or warranty in respect of the property.