



Musgrove Road, SE14

£1,500 Per calendar month

A one double bedroom ground floor Victorian conversion with modern features and ample storage throughout.

Musgrove Road is situated in the highly sought after Telegraph Hill Conservation area, offering easy access to New Cross Gate and New Cross Station as well as the amenities on New Cross Road.

Features

- One Double Bedroom
- Ground Floor Flat
- Part-Furnished
- Victorian Conversion
- Telegraph Hill Conservation Area

Musgrove Road, London, SE14

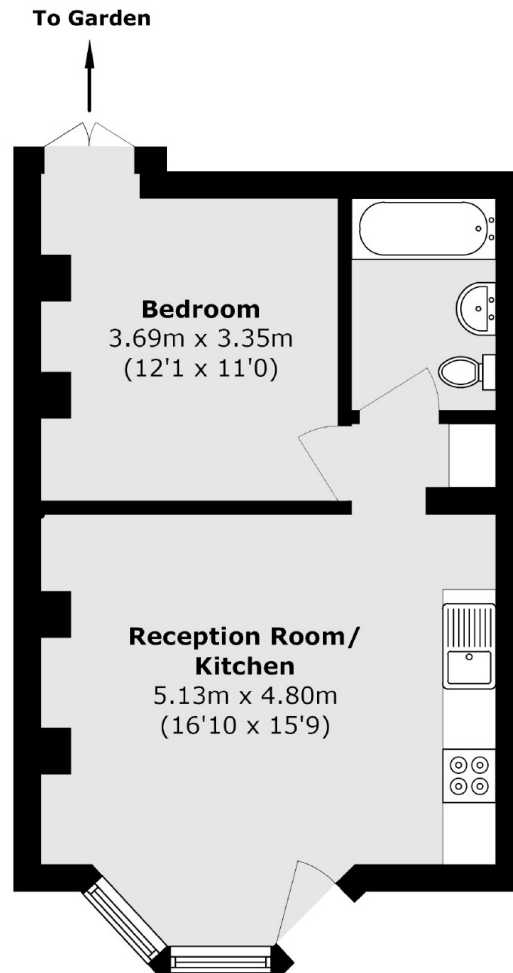

Total area (approx.): 40.7 sq. m (438.0 sq. ft)