



## 20A Lime Avenue

Melksham, SN12 6UY

**Guide Price £300,000**

Welcome to Lime Avenue, Melksham. A two bedroom detached bungalow situated in a popular residential area.

The accommodation comprises entrance hall, shower room, lounge/dining room with patio doors to the garden, newly fitted kitchen, utility room with access door onto the garden and two double bedrooms.

The property further benefits from gas central heating, double glazing, an enclosed garden and single garage and driveway parking.

Dimensions (approximate)

Lounge/Dining Room 11.7ft at it's widest point (8.6ft at it's narrowest point) x 21.2 ft

Bedroom 1 - 11.68ft x 9.5ft

Bedroom 2 - 11.37 ft x 9.7ft

- Chain Free
- Freehold
- Detached Bungalow
- Two Double Bedrooms
- Newly Fitted Kitchen
- Enclosed Rear Garden
- Garage
- Driveway Parking

### Viewing

Please contact our Blueleaf Property Office on 01225 839050 if you wish to arrange a viewing appointment for this property or require further information.

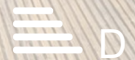

## Floor Plan

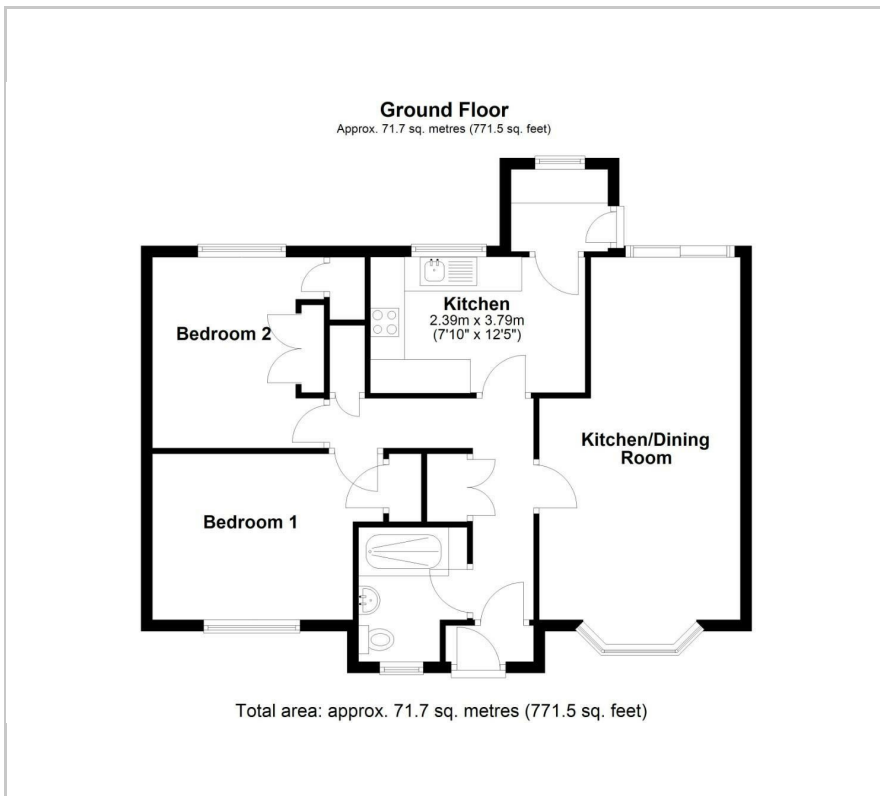

## Area Map

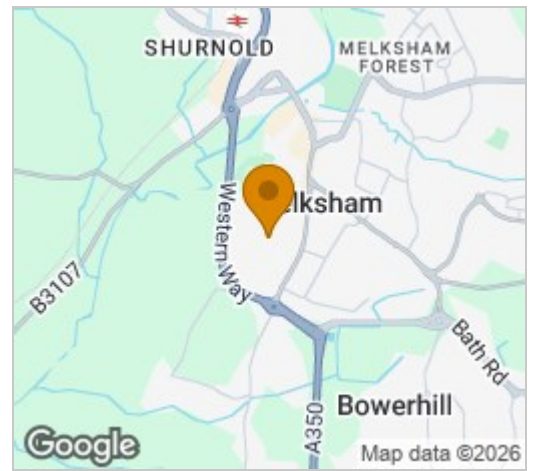

## Energy Efficiency Graph

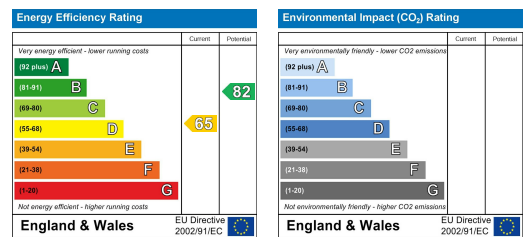

These particulars, whilst believed to be accurate are set out as a general outline only for guidance and do not constitute any part of an offer or contract. Intending purchasers should not rely on them as statements of representation of fact, but must satisfy themselves by inspection or otherwise as to their accuracy. No person in this firm's employment has the authority to make or give any representation or warranty in respect of the property.

Office 4 Stockley Farm, Stockley, Wiltshire, SN11 0NT

Tel: 01225 839050 Email: [hello@blueleafproperty.co.uk](mailto:hello@blueleafproperty.co.uk) <https://www.blueleafproperty.co.uk>