

ANTHONY JAMES MANSEY

Residential Sales & Lettings



Percheron Close

Isleworth, TW7 6SS

£2,300 Per Month



Nestled in the desirable area of Percheron Close, Isleworth, this charming three-bedroom house presents an excellent opportunity for those seeking a comfortable and inviting home. The property boasts a well-proportioned reception room, perfect for both relaxation and entertaining guests.

The house features three spacious bedrooms, providing ample space for rest and personalisation. The separate kitchen is a delightful addition, offering functionality and convenience for culinary enthusiasts. The property is equipped with gas central heating, ensuring warmth and comfort throughout the colder months.

One of the standout features of this home is the private rear garden, a tranquil oasis ideal for outdoor gatherings, gardening, or simply enjoying a moment of peace. The sought-after location enhances the appeal, with local amenities, parks, and transport links within easy reach, making it a perfect choice for families and professionals alike.

This property is a wonderful blend of comfort, convenience, and charm, making it an ideal place to call home. Don't miss the chance to view this delightful house in Isleworth.



Area Map



Floor Plans

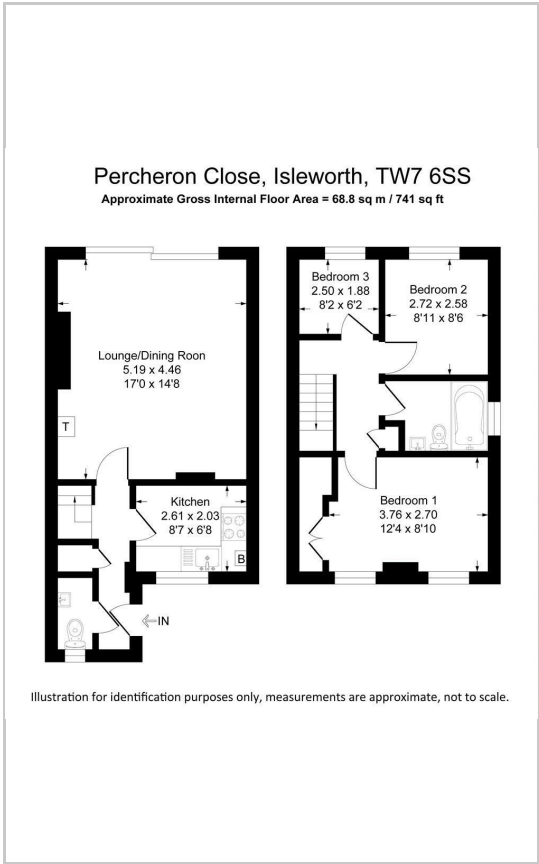

Energy Efficiency Graph

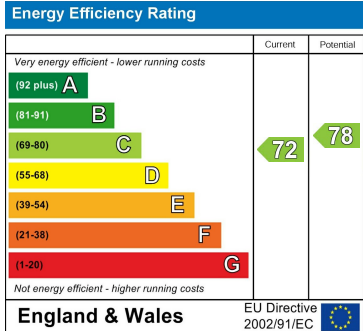

These particulars, whilst believed to be accurate are set out as a general outline only for guidance and do not constitute any part of an offer or contract. Intending purchasers should not rely on them as statements of representation of fact, but must satisfy themselves by inspection or otherwise as to their accuracy. No person in this firms employment has the authority to make or give any representation or warranty in respect of the property.