



DUNWORTH MEWS, W11

£2,950 per week (£12,783.33 per month)

An exceptional two-bedroom upper maisonette with an impressive private roof terrace, perfectly positioned in the heart of Notting Hill.

Two bedrooms
Two bathrooms
High ceilings

Precise specification
Huge roof terrace
Iconic location

STEP INSIDE DUNWORTH MEWS

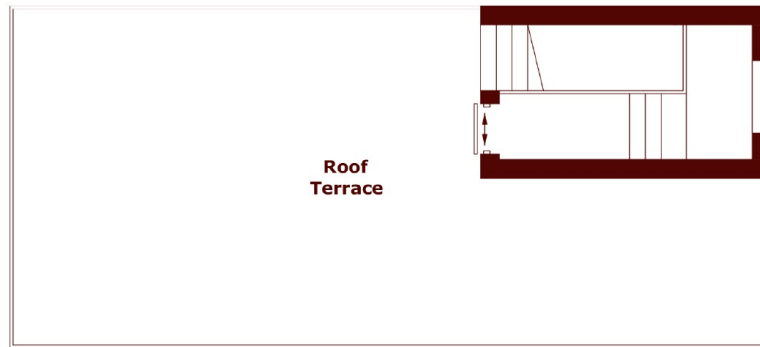

Third Floor

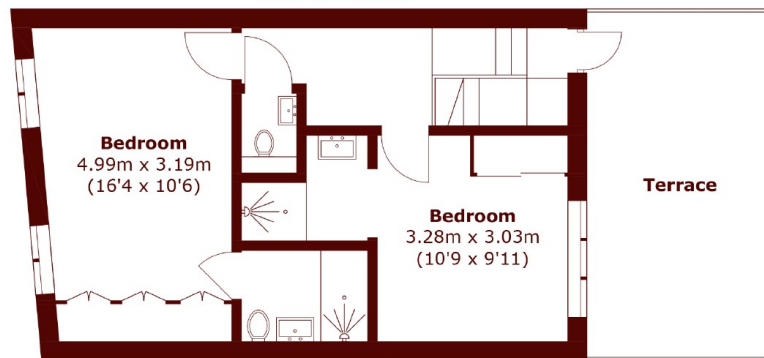

Second Floor

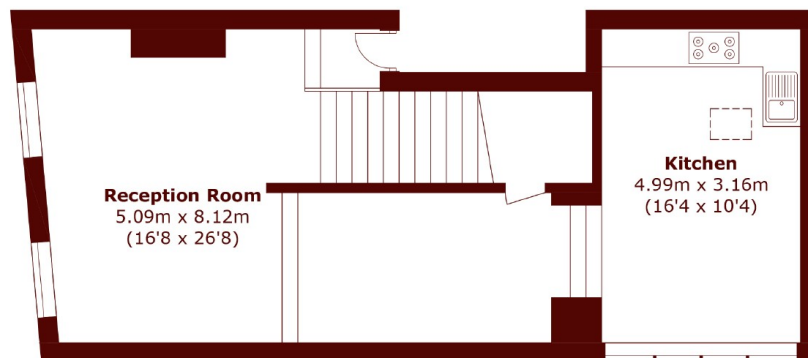

First Floor

Total area (approx.): 107.1 sq. m (1,152.9 sq. ft)
Roof Terrace / Terrace: 68.0 sq. m (731.9 sq. ft)

Notting Hill
020 7313 6910

Energy Rating: E We aim to make our particulars both accurate and reliable. However, they are not guaranteed; nor do they form part of an offer or contract. If you require clarification on any points then please contact us, especially if you're traveling some distance to view. Please note that appliances and heating systems have not been tested and therefore no warranties can be given as to their good working order

**MARSH &
PARSONS**