



+44 1843 265050
contact@footprintsproperty.co.uk
footprintsproperty.co.uk

12a Highcliffe Hall, Eastern Esplanade

£250,000

🛏 2 🚿 1 🛋 1



- Garden Flat - private garden with amazing views!
- Desirable Cliff Top Location
- Adjacent to the old Cliftonville Croquet Lawns with direct access
- Less than 100m to the beach
- Spacious Living/Dining Room and Kitchen with utility room
- Parquet Flooring and Stylish Decor



This seaside garden flat leaves a lasting impression and stands out amongst others - with it's internal space biased towards the living accommodation, it boasts a beautiful large living dining room with a bay window to the front, a large fitted kitchen to the rear, utility room and spacious inner hallway. The 2 bedrooms consist of 1 double bedroom and 1 single bedroom. With parquet flooring, period style bathroom and tasteful decor this home feels welcoming, traditional and modern all at the same time.

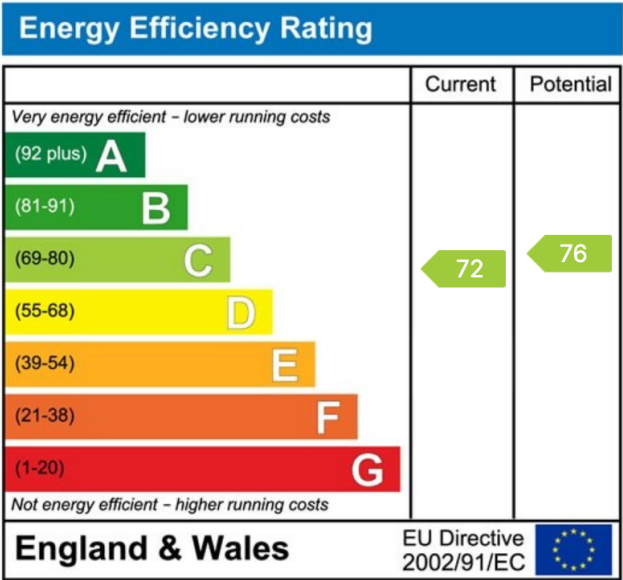
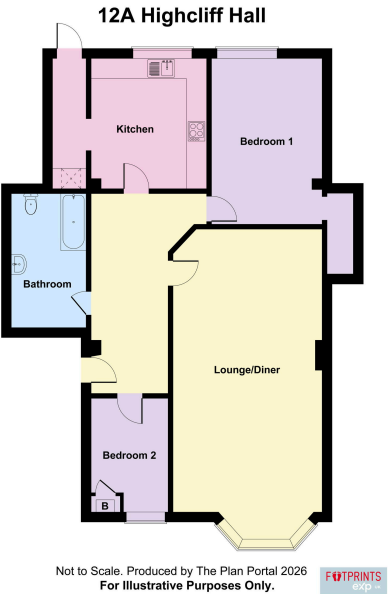

If you have instructed another agent to sell your house and instruct eXp World Ltd to sell your property at the same time, then you could be liable to pay both agents. It is recommended that you check the contract you have with your current agent.

FOOTPRINTS Property Is an approved agent at eXp World UK Limited, trading as eXp UK, registered at C/O Corporation Service Company [Uk] Limited, 5 Churchill Place, 10th Floor, London, United Kingdom, E14 5HU. Company number 12016573. VAT no 327 4120 29.