



**Eardley Road, SW16**

**£675,000**

**Dexters**



## Eardley Road, SW16

A four bedroom family home with great transport links right on the doorstep. Spread over three floors, this home has two reception rooms with one being used as a dining room. There is a separate galley kitchen leading through to the charming landscaped garden.

Upstairs on the first floor there are two large double bedrooms as well as a smaller box room that could be used as a nursery or home office. The top floor has been converted to create a large main bedroom with en-suite, built-in wardrobes as well as desk area and eaves storage.

Eardley Road is in the midst of access routes into Clapham Junction, London Victoria and London Bridge via Streatham Common and Streatham Station. Tooting Bec Common and Streatham Common are short walks away. There are also some great local pubs, shops and restaurants within walking distance.

### Features

- Four Bedrooms
- Opposite Station
- Separate Kitchen
- Two Bathrooms
- Good Condition
- Two Receptions



# Eardley Road, London, SW16

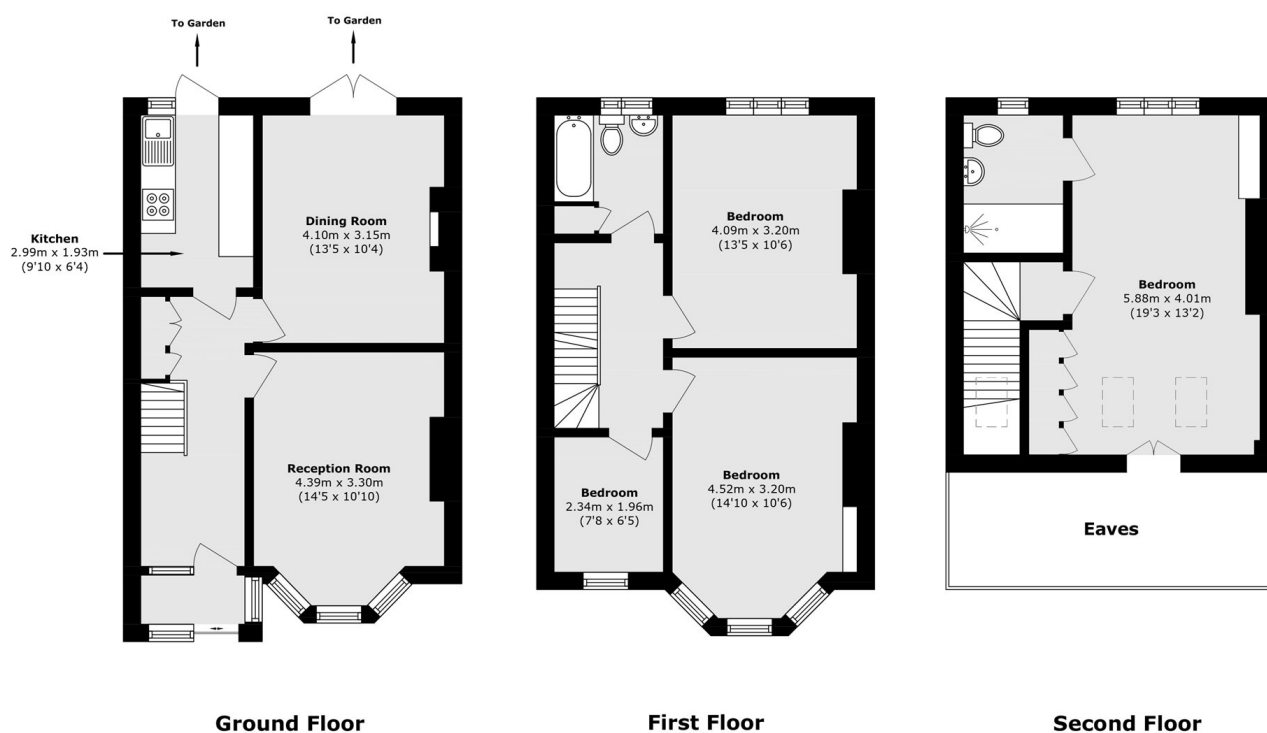

Total area (approx.): 117.0 sq. m (1259.3 sq. ft)  
(Excluding Eaves)