

Springfield Road, Atherton, M46 9RZ
Offers Over £290,000

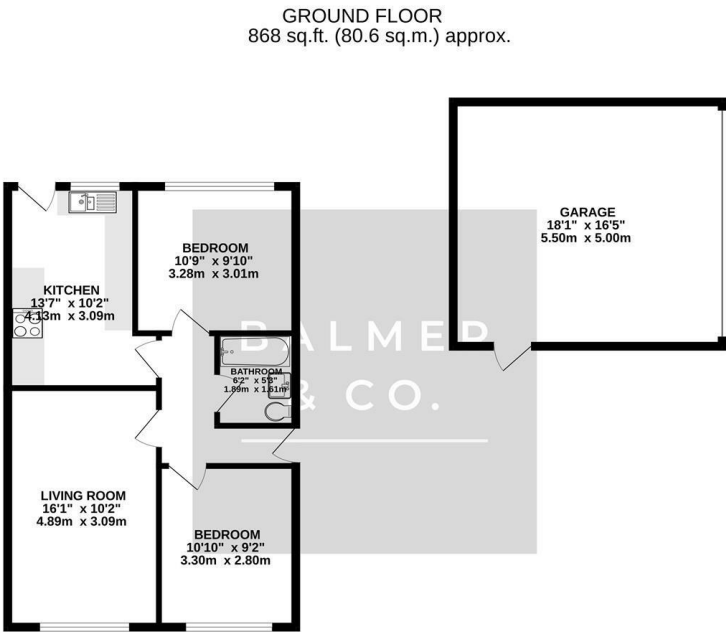

BALMER & CO in ATHERTON are delighted to offer FOR SALE this fantastic two bedroom detached true bungalow located on Springfield Road, a popular and well regarded residential location within walking distance of Atherton train station. Recently refurbished it is ready to move into and perfect for those looking for single floor accommodation with generous garden space. Comprising in brief; living room with LVT flooring, modern fitted kitchen, two double bedrooms, one benefitting from fitted wardrobes and a three piece bathroom suite. Externally, it occupies a fantastic corner plot with gardens to the front, side and rear with a detached double garage and off road parking. Early viewings highly recommended, all enquiries welcome.

Floor Plan



TOTAL FLOOR AREA: 868 sq.ft. (80.6 sq.m.) approx.
Whilst every attempt has been made to ensure the accuracy of the floorplan contained here, measurements of floors, windows, doors and any other items are approximate and no responsibility is taken for any error, omission or misstatement. This plan is for information purposes only and should be used as a guide only. Prospective purchasers. The services, systems and appliances shown have not been tested and no guarantee is given as to their operability or efficiency can be given.
Made with Metapix ©2025

Area Map

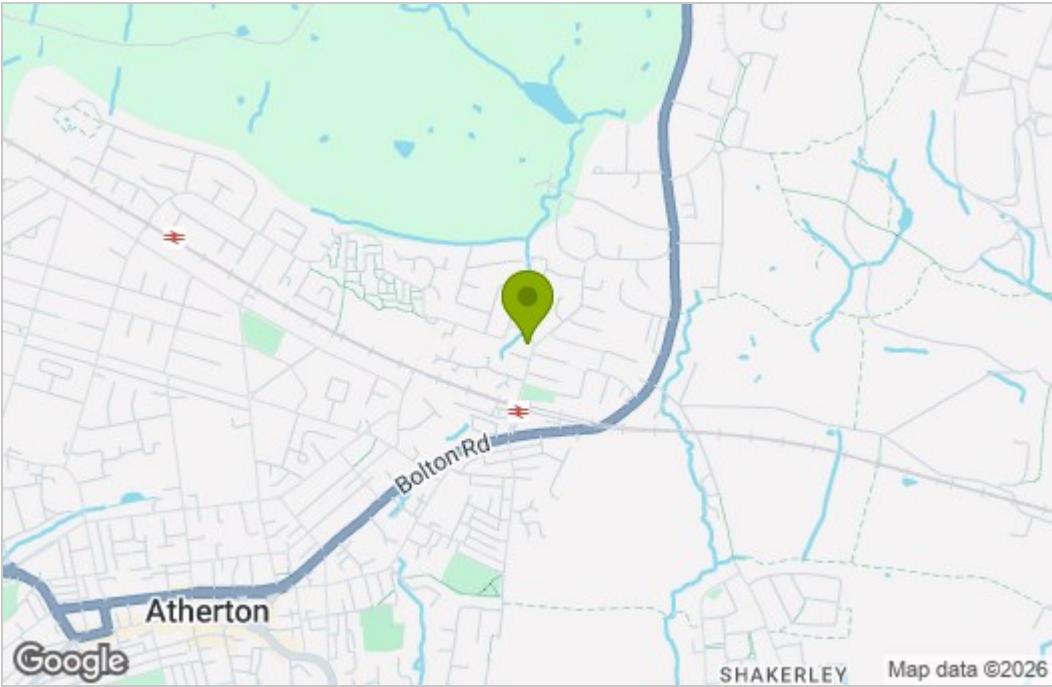

Energy Efficiency Graph

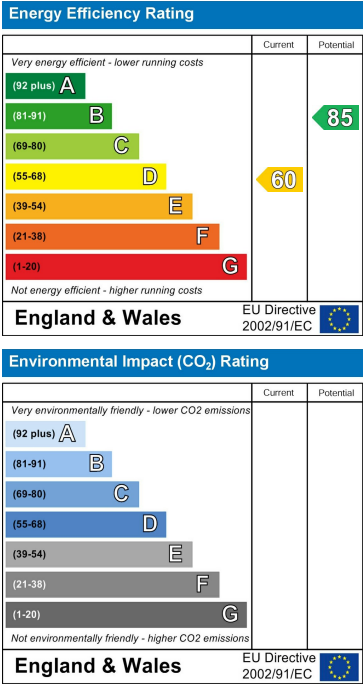

These particulars, whilst believed to be accurate are set out as a general outline only for guidance and do not constitute any part of an offer or contract. Intending purchasers should not rely on them as statements of representation of fact, but must satisfy themselves by inspection or otherwise as to their accuracy. No person in this firms employment has the authority to make or give any representation or warranty in respect of the property.