



Sheen Court, TW10

£500,000

Set within the highly sought-after Sheen Court, this generously proportioned mansion block apartment offers well-balanced accommodation throughout. The property comprises two well-sized bedrooms, a spacious bathroom, a separate fully fitted kitchen, and a substantial reception room that opens onto a private balcony, providing excellent natural light and additional outdoor space.

Sheen Court is a well maintained private sought after residential development set within extensive communal grounds. Richmond and North Sheen stations offer tube or rail services into Central London via the District Line, South West Trains and London Overground.

Features

- Two Bedrooms
- Residents Parking
- Top Floor
- Balcony
- Share Of Freehold
- No Onward Chain

Sheen Court, Richmond, TW10

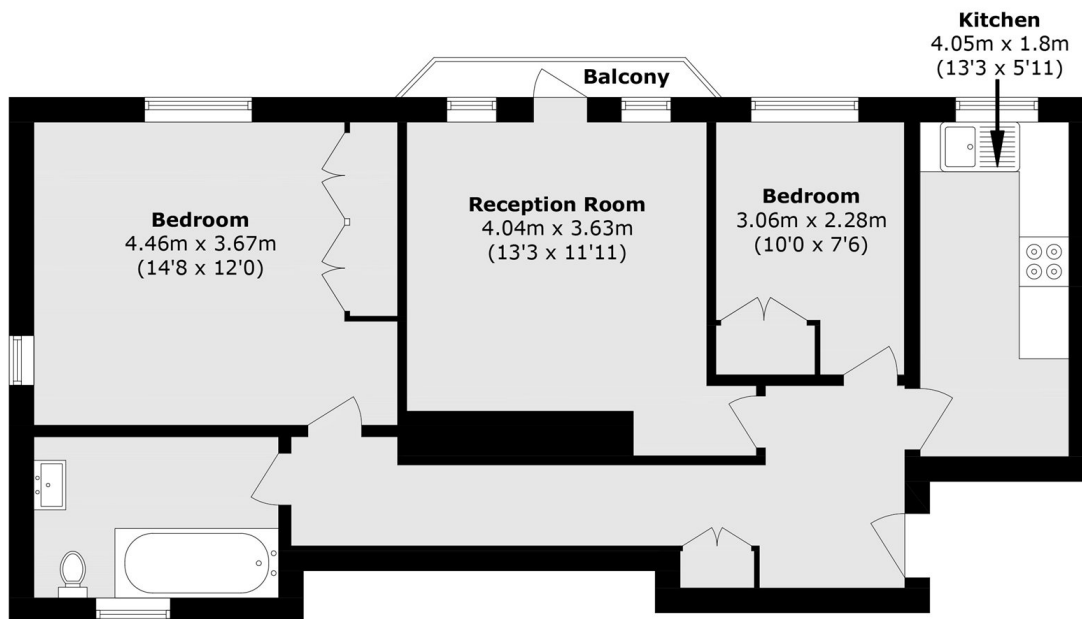

Total area (approx.): 65.3 sq. m (702.8 sq. ft)
Balcony area (approx.): 1.4 sq. m (15 sq. ft)