



14 Chester Road
, Bristol, BS5 7AX

Asking price **£390,000**



14 Chester Road



Description

Welcome to this lovely 2 bedroom terrace with St. George Park right on its doorstep and the increasingly popular Church Road within walking distance offering an array of independent shops, cafes and pubs! With good transport links into the city, a Westerly facing garden and much more, this property is an ideal first time buy.

As you enter, you are greeted by an entrance hallway leading to an open plan living arrangement downstairs. Comprising of a bay living room, featuring a period fireplace, a full-width dining room and a modern kitchen. To the rear you'll find a modern bathroom with a walk-in shower. Outside is a lovely Westerly facing garden perfect for hosting friends and family. Upstairs you'll find a full-width master bedroom, a second double bedroom and a study/third bedroom.

Further benefits include double glazing, gas central heating from a combination boiler and much more! Don't miss out on the opportunity to make this gem your own, call now to book a viewing !!

- NEXT TO ST. GEORGE PARK
- WESTERLY FACING GARDEN
- BAY LIVING ROOM
- MODERN KITCHEN
- REAR EXTENSION
- 2 DOUBLE BEDROOMS + STUDY/THIRD BEDROOM
- OPEN PLAN LAYOUT
- FULL-WIDTH DINING ROOM
- MODERN BATHROOM
- DOUBLE GLAZING





Floor Plan

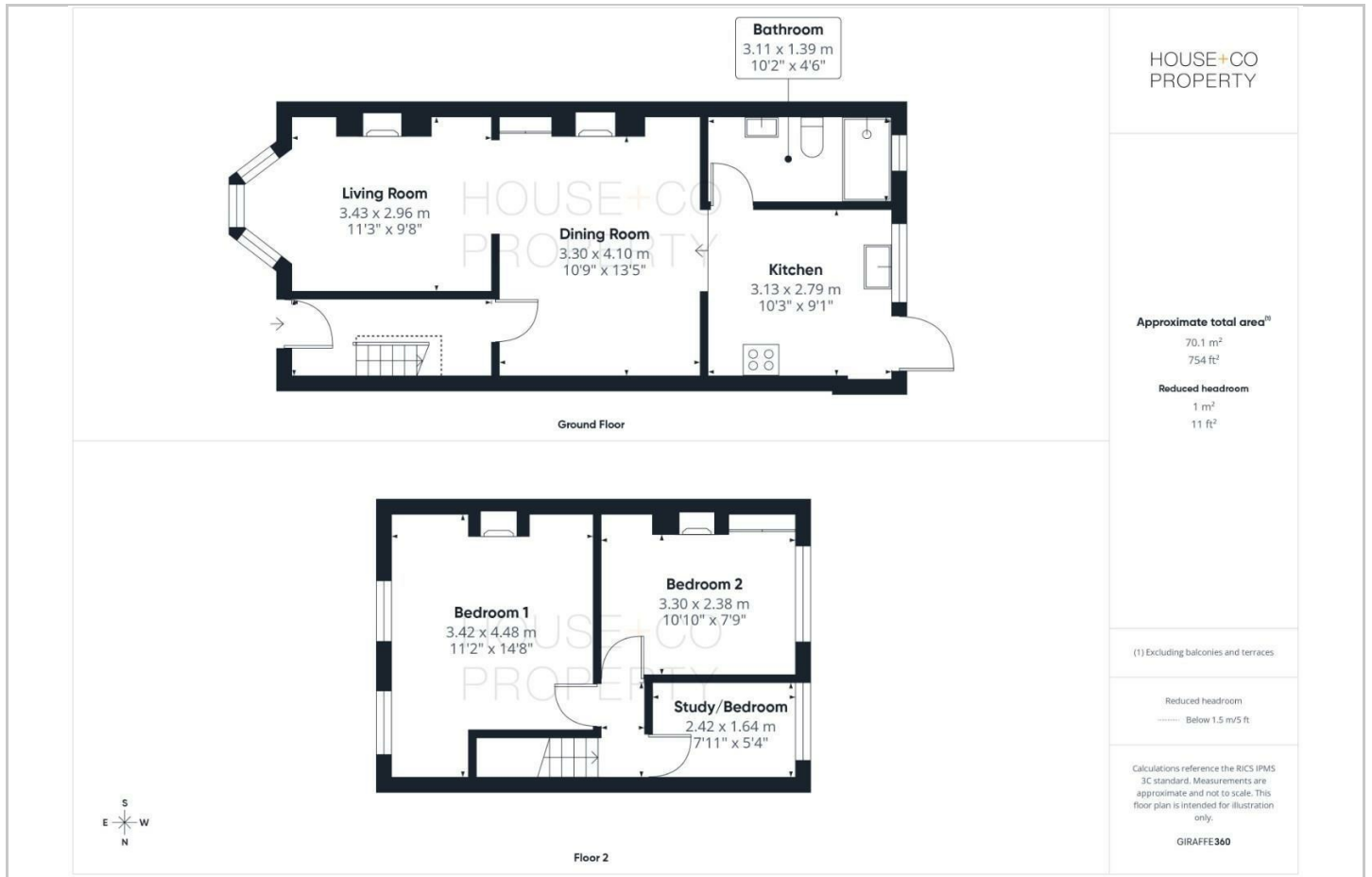

Area Map

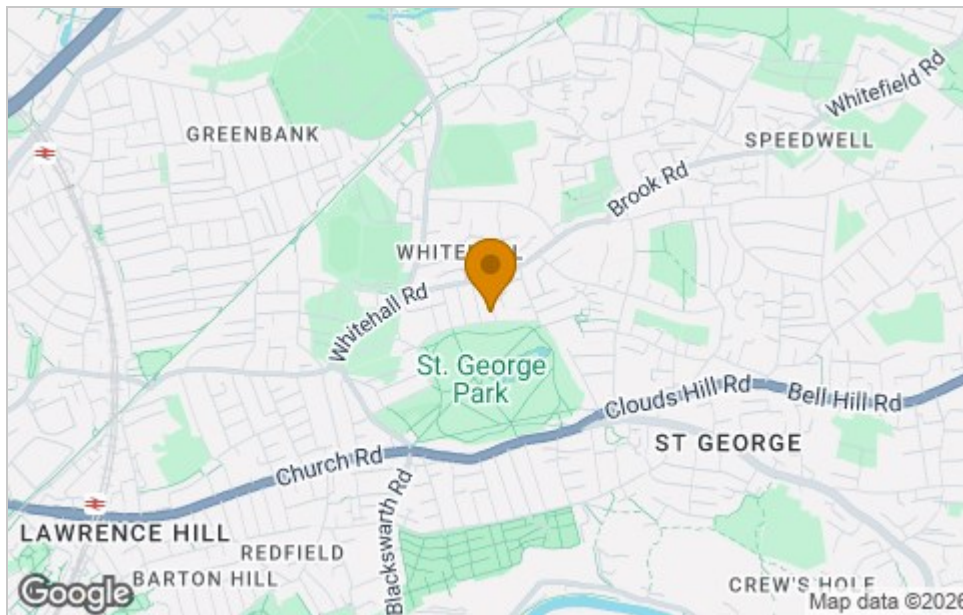

Viewing

Please contact our House + Co Property (Sales) Office on 0117 907 0020 if you wish to arrange a viewing appointment for this property or require further information.

Energy Efficiency Graph

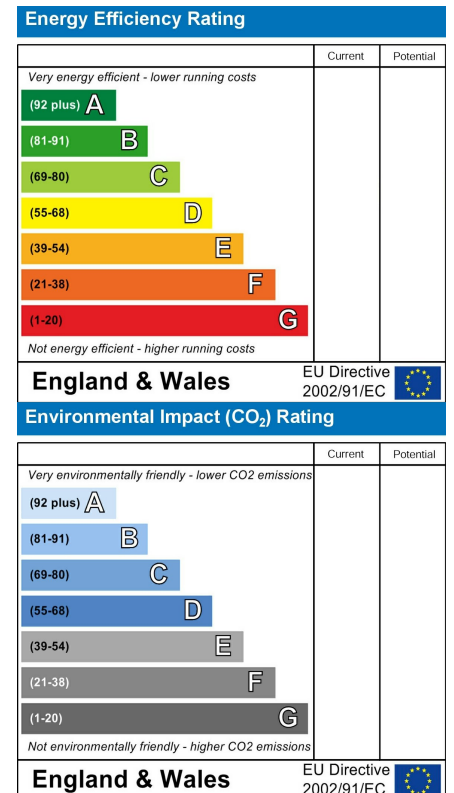

These particulars, whilst believed to be accurate are set out as a general outline only for guidance and do not constitute any part of an offer or contract. Intending purchasers should not rely on them as statements of representation of fact, but must satisfy themselves by inspection or otherwise as to their accuracy. No person in this firm's employment has the authority to make or give any representation or warranty in respect of the property.