



6 Willow Close, Pershore

Guide Price **£485,000**





6 Willow Close

Pershore, Pershore

Council Tax band: E

Tenure: Freehold

EPC Energy Efficiency Rating: C

EPC Environmental Impact Rating:

- Spacious detached bungalow extending to approx. 1,544 sq. ft.
- Tucked away position within a desirable cul-de-sac
- Generous overall plot with private gardens
- Excellent scope to improve and modernise
- Three bedrooms including versatile study/bedroom three
- Attached garage and driveway parking
- Convenient access to Pershore town centre and amenities







Ground Floor

Approx. 143.5 sq. metres (1544.8 sq. feet)

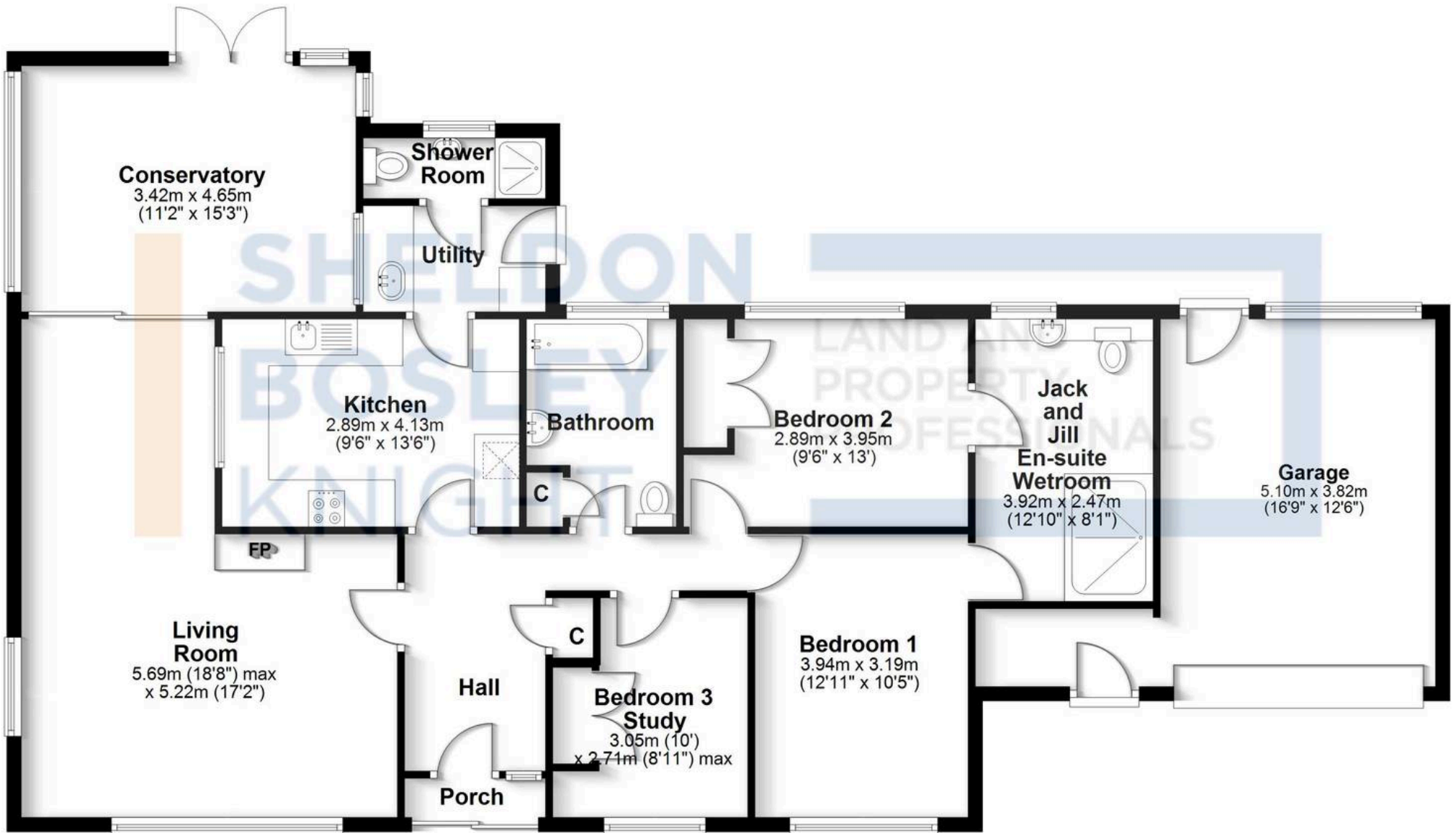

Total area: approx. 143.5 sq. metres (1544.8 sq. feet)

All efforts have been made to ensure the measurements are accurate on this floor plan, however these are for guidance purposes only.
Plan produced using PlanUp.