



Hepworth Court  
30 Gatliff Road, SW1W

CHESTERTONS





Situated within a riverside development with porter, this magnificent one bedroom that offers Lift access and a contemporary living and entertaining space with modern fixtures and fittings throughout. Grosvenor Water side is ideally located for a collection of pavement lined cafes, galleries and local conveniences along Pimlico Road which leads into Sloane Square for a more extensive range of upmarket designer retailers and restaurants.

There is a semi open plan kitchen with a breakfast bar and integrated appliances, one en suite plus guest cloakroom, comfort cooling, wood flooring, a large range of fitted wardrobes bedroom. Floor to ceiling windows in the living-room allow for the flat to exploit its west facing aspect to the greatest extent. The development provides residents with a 24 hour concierge service and there is a leisure suite with a well-equipped gym with spa facilities as well as a private parking space.

- One Bedroom
- Porter
- Lift Access
- West Facing Balcony
- New Build
- Air Cooling system
- No onward chain

Asking Price £795,000

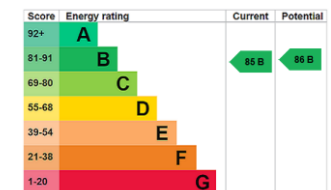

**Tenure:** Leasehold 976 years (expiring 01/01/3002)  
**Service Charge:** £6,000 per annum  
**Ground Rent:** £1,200 per annum  
**Local Authority:** City of Westminster  
**Council Tax Band:** F

*Chestertons Knightsbridge & Belgravia Sales*

31 Lowndes St  
 Knightsbridge  
 London  
 SW1X 9HX

knightsbridge@chestertons.co.uk  
 020 7235 8090

# Hepworth Court, SW1W

Approximate gross internal area  
59.92 sq m / 645 sq ft

Key :  
CH - Ceiling Height

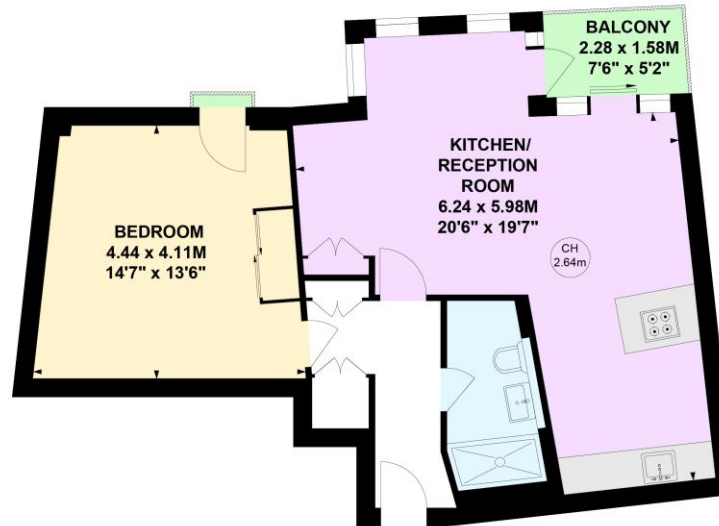

## Fourth Floor

Not to scale, for guidance only and must not be relied upon as a statement of fact.  
All measurements and areas are approximate only

Chesterton UK Services Limited trading as Chestertons for themselves and for the vendor of this property whose agents they are, give notice that (i) these particulars do not constitute any part of an offer or contract, (ii) all statements contained within these particulars are made without responsibility on the part of Chestertons or the vendor, (iii) whilst made in good faith, none of the statements contained within these particulars are to be relied upon as a statement or representation of fact, (iv) any intending purchasers must satisfy themselves by inspection or otherwise as to the correctness of each of the statements contained within these particulars, (v) the vendor does not make or give either Chestertons or any person in their employment any authority to make or give representation or warranty whatsoever in relation to this property. Wide angle lenses may be used. ©Copyright Chestertons | Chesterton UK Services Limited | Registered Office 40 Connaught Street, Hyde Park, London W2 2AB Registered Company Number 05334580.



This paper is  
100% recyclable