



## Avenue Gardens, W3

£850,000

A well presented three bedroom, two bathroom, home in the Mill Hill Park Conservation Area. The property has off-street parking, a secluded, south-facing garden and plentiful storage.

Avenue Gardens is conveniently located within half a mile of both Acton Town station (Piccadilly & District Line) and South Acton station (Overground), and a mile from Acton Main Line station (Elizabeth Line).

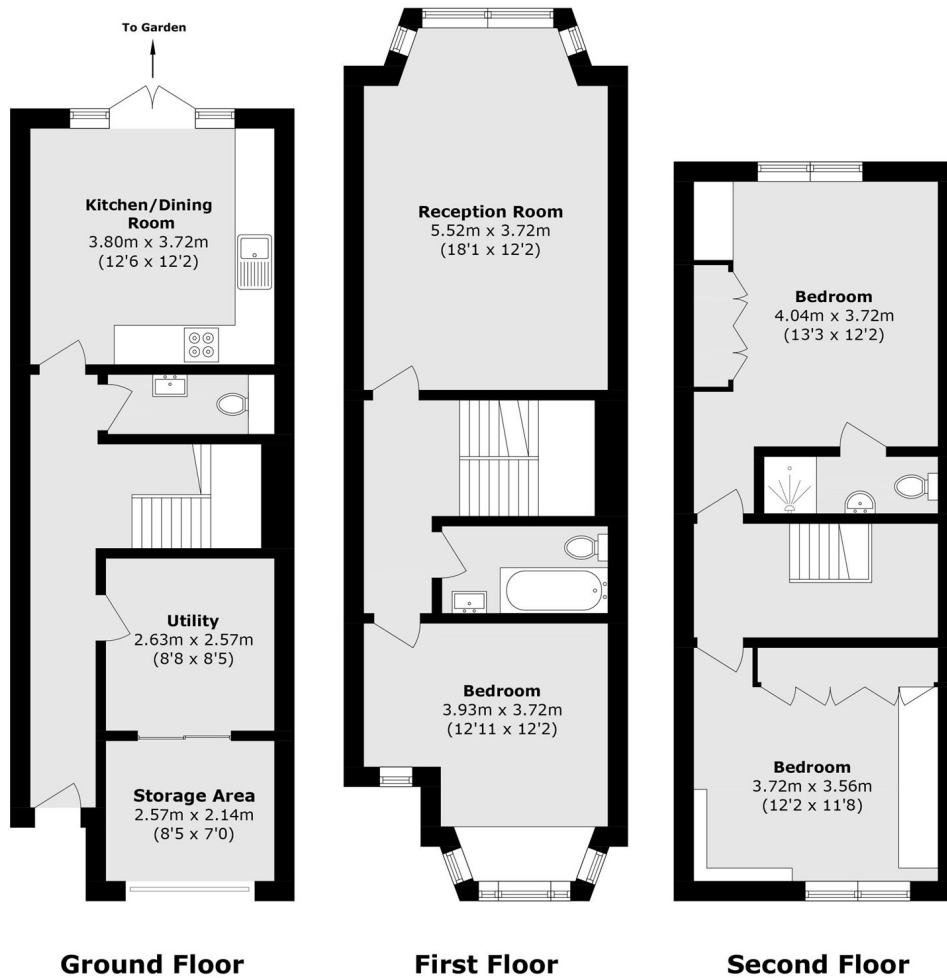

Total area (approx.): 126.1 sq. m (1357.3 sq. ft)

Robertson Smith & Kempson Acton Sales  
137 High Street, Acton,  
London, W3 6LY  
020 8896 3996  
[actonsales@robertsonsmithandkempson.co.uk](mailto:actonsales@robertsonsmithandkempson.co.uk)

Energy Rating: C. We aim to make our particulars both accurate and reliable. However they are not guaranteed; nor do they form part of an offer or contract. If you require clarification on any points then please contact us, especially if you're traveling some distance to view. Please note that appliances and heating systems have not been tested and therefore no warranties can be given as to their good working order.