



STOBART
& HURRELL

**STOBART
& HURRELL**

WE BRING PEOPLE AND PROPERTY TOGETHER ACROSS NORFOLK



151 Kingswood Avenue, Taverham, Norfolk, NR8 6UW

A detached four-bedroom family home, ideally positioned on the north-west outskirts of the historic city of Norwich within the highly sought-after village of Taverham. Offering an excellent balance of village convenience and city accessibility, the area is particularly popular with families thanks to its well-regarded schools for all ages, supermarket, petrol station, garden centre with café, and a variety of independent shops and everyday amenities.

Set back from the road, the property is approached via a hardstanding driveway providing convenient off-road parking. The former garage has been thoughtfully converted to create a versatile additional reception room or fourth bedroom, ideal for growing families, guests, or home working. To the rear, the enclosed garden offers a paved terrace perfect for alfresco dining and entertaining, complemented by mature shrubs and established borders that create an attractive and private outdoor setting.

Internally, the accommodation is well presented throughout and perfectly suited to modern family living. The welcoming entrance hall provides access to a cloakroom, the family room/fourth bedroom, and a comfortable lounge which flows through to a separate dining room. The dining area leads into the kitchen, which is further complemented by a separate utility room, while sliding doors open into a bright conservatory overlooking the rear garden. Upstairs, there are three well-proportioned bedrooms, one benefiting from built-in storage, together with a modern family shower room.

The property is further enhanced by its excellent location, with Norwich city centre just a short drive away, offering an extensive range of shopping, dining, cultural attractions, and historic landmarks. The stunning North Norfolk coastline and the Norfolk Broads are also easily accessible, making this an ideal home for those seeking convenient access to city, countryside, and coast alike.



Detached



House



Older



1 Bathroom
1 Cloakroom



3 Receptions



4 Bedrooms



Tax Band C



Off-Road
Parking



Converted
Garage



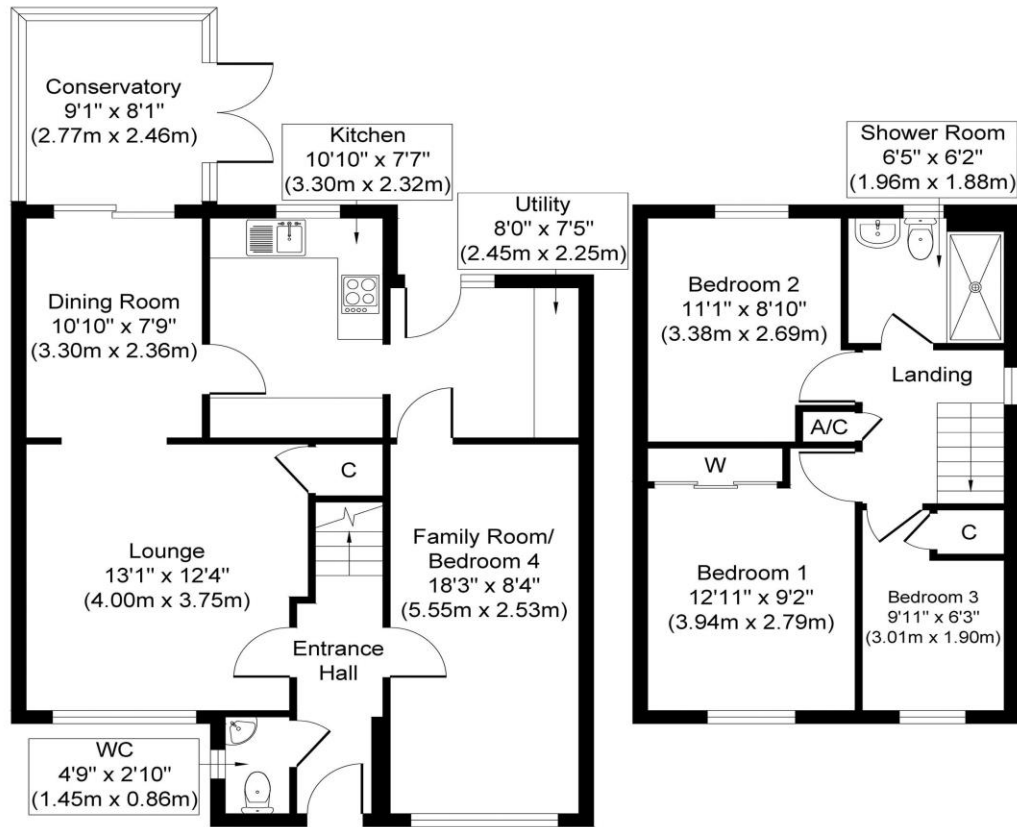

Ground Floor
Approximate Floor Area
715 sq. ft
(66.42 sq. m)

First Floor
Approximate Floor Area
381 sq. ft
(35.37 sq. m)

Whilst every attempt has been made to ensure the accuracy of the floor plan contained here, measurements of doors, windows, rooms and any other items are approximate and no responsibility is taken for any error, omission, or mis-statement. The measurements should not be relied upon for valuation, transaction and/or funding purposes. This plan is for illustrative purposes only and should be used as such by any prospective purchaser or tenant. The services, systems and appliances shown have not been tested and no guarantee as to their operability or efficiency can be given.

Stobart & Hurrell

Horning Road West, Hoveton, Norfolk NR12 8QJ

www.stobarthurrell.co.uk

enquiries@stobarthurrell.co.uk

01603 782 782





**STOBART
& HURRELL**



**STOBART
& HURRELL**
MORTGAGES