



14 Knipton Drive , Loughborough, LE11 4ER £215,000

Offered to the market with no upward chain, this immaculately presented three-bedroom semi-detached home is ideally located within easy reach of Loughborough town centre, making it a superb choice for both first-time buyers and investors alike.

The property has been maintained to a high standard throughout and benefits from a recently refitted contemporary kitchen with quality fixtures and fittings, perfect for modern day living. The ground floor also comprises a spacious and light-filled living room and an entrance porch providing a practical welcome space.

To the first floor, the home offers three generously sized bedrooms, providing ample space for families, guests, or home working. A stylish, fully fitted three-piece bathroom suite completes the upper level.

Additional features include gas central heating and double glazing throughout, ensuring year-round comfort and energy efficiency. Externally, the property benefits from a low-maintenance and well-presented private rear garden, ideal for outdoor relaxation or entertaining. A detached garage located in a nearby block to the side of the property offers secure parking or additional

- Semi Detached Family Home
- Three Bedrooms
- Cul-De-Sac Location
- Off Road Parking
- No Upward Chain
- Recently Fitted Boiler
- Council Tax Band B
- EPC Rating E

Viewing

Please contact our Berkley Kibworth Office on 0116 2796161 if you wish to arrange a viewing appointment for this property or require further information.



3



1



1



E

Floor Plan

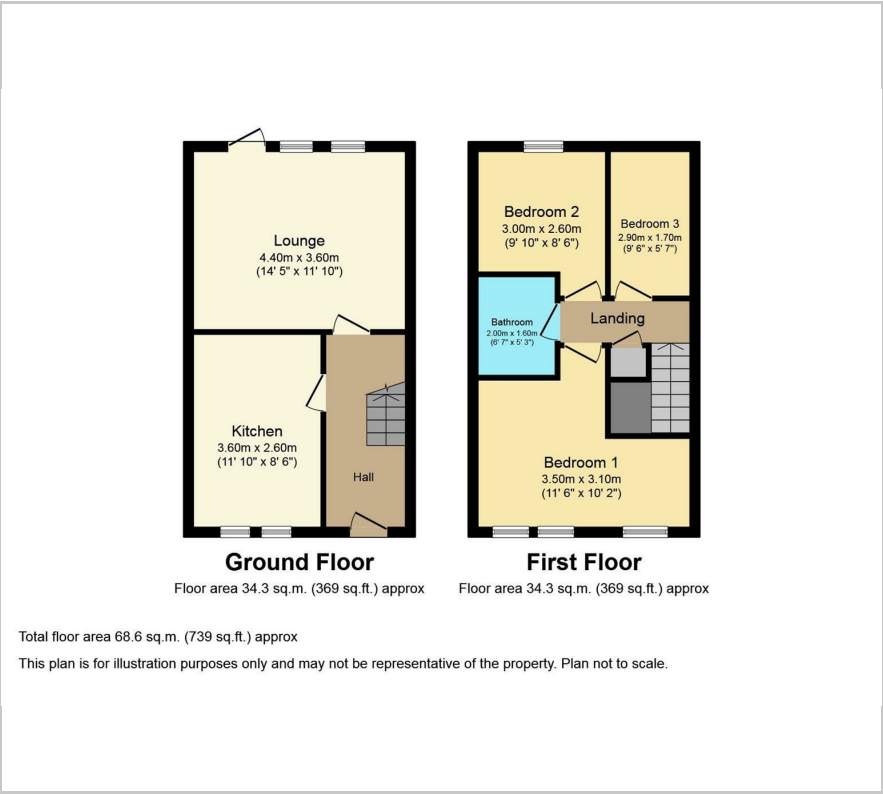

Area Map



Energy Efficiency Graph

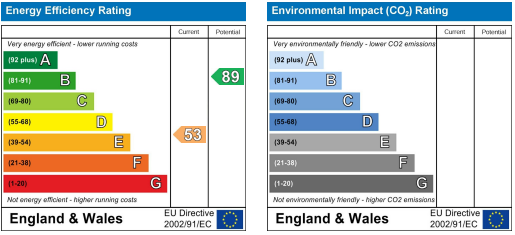

These particulars, whilst believed to be accurate are set out as a general outline only for guidance and do not constitute any part of an offer or contract. Intending purchasers should not rely on them as statements of representation of fact, but must satisfy themselves by inspection or otherwise as to their accuracy. No person in this firms employment has the authority to make or give any representation or warranty in respect of the property.