



Taylor's

Harrison Road, Wordsley, Stourbridge, DY8 5XT

Offers In Region Of £85,000

🛏 1 🚿 1 🚻 1



This MOST APPEALING & WELL ARRANGED APARTMENT enjoys a secure TOP FLOOR POSITION within this POPULAR DEVELOPMENT, which is centrally located to Stourbridge Town Centre, Brierley Hill High Street & Kingswinford Village and furthermore has an EXTENSIVE RANGE of Regular Transport Links & Local Amenities close by.

This WELL PRESENTED PROPERTY is for sale with NO UPWARD CHAIN and together with being ideally suited for FIRST TIME BUYERS, those wishing to downsize or Investors seeking an Astute Buy-to-let investment, in brief comprises: Entrance Hall, Pleasant Lounge Diner, Fitted Kitchen, Double Bedroom with Fitted Wardrobes & Shower Room. Furthermore with Communal Off Road Parking, Double Glazing & Well Maintained Communal Gardens & Grounds.

By law, we are required to conduct anti-money laundering checks on all potential buyers and sellers, and we take this responsibility very seriously. In line with HMRC guidelines, our trusted partner, Coadjute, will securely manage these checks on our behalf. Once an offer is accepted (subject to contract), Coadjute will send a secure link for you to complete the biometric checks electronically. A non-refundable fee of £40 + VAT per person will apply for these checks, and Coadjute will handle the payment for this service. These anti-money laundering checks must be completed before we can send the memorandum of sale to the solicitors to confirm the sale. Please contact the office if you have any questions in relation to this.

ROOM DIMENSIONS

Flats Own Entrance Hall

Lounge Diner - 4.21m x 3.22m (13'9" x 10'6")

Kitchen - 3.13m x 1.85m (10'3" x 6'0")

Bedroom - 3.35m x 2.89m (10'11" x 9'5")

(Measurements taken at widest available points)

Shower Room - 2.5m x 1.83m (8'2" x 6'0")

OUTSIDE

Communal Off Road Parking

Well Maintained Communal Gardens & Grounds

EPC: D. Council Tax Band: A. Mains electric, Mains Sewerage & Mains Water is connected. Broadband / Mobile Coverage: According to Ofcom (the office of communications), standard, superfast & ultrafast broadband is available at this property. Construction: We believe the property is of a standard construction type (this must be checked by any potential buyers conveyancing solicitor / surveyor). According to gov.uk, there is a very low risk of yearly flooding. Tenure: The property is Leasehold with 167 years remaining on the lease. There is an annual service charge of approximately £1,642 per year and a yearly ground rent of £50 per year (All leasehold information should be clarified by any potential buyers conveyancing solicitor).



Harrison Court, Harrison Road, Wordsley, DY8 5XT

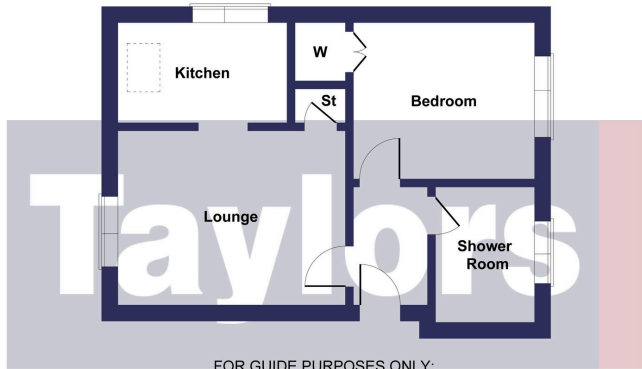

FOR GUIDE PURPOSES ONLY:

Whilst every attempt has been made to ensure the accuracy of the floor plan contained here, measurements of doors, windows, rooms and any other items are approximate and no responsibility is taken for any error, omission, or mis-statement. This plan is for illustrative purposes only and should be used as such by any prospective purchaser. The services, systems and appliances shown have not been tested and no guarantee as to their operability or efficiency can be given. This floor plan is provided strictly for the purpose of providing a guide and is not intended to be sufficiently accurate for any purpose. Taylors Estate Agents do not accept any responsibility for errors or misuse. Prospective buyers must always seek their own verification of a layout, or seek the advice of their own professional advisors (surveyor or solicitor).

- MOST APPEALING & WELL ARRANGED APARTMENT
- NO UPWARD CHAIN
- GENEROUS DOUBLE BEDROOM
- DOUBLE GLAZING
- POPULAR RESIDENTIAL LOCATION
- IDEAL FOR FIRST TIME BUYERS OR THOSE WISHING TO DOWNSIZE
- FANTASTIC INVESTMENT OPPORTUNITY
- FITTED KITCHEN
- WELL MAINTAINED COMMUNAL GARDENS & GROUNDS
- EXCELLENT RANGE OF TRANSPORT LINKS & LOCAL AMENITIES CLOSE BY

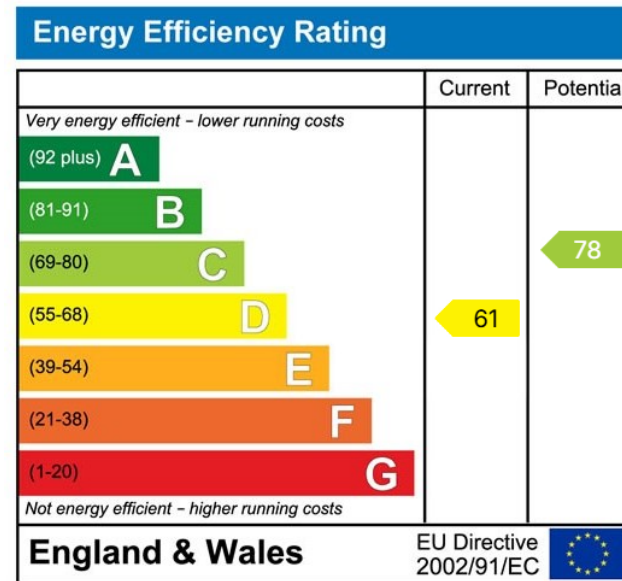

MISREPRESENTATION ACT 1967: These particulars do not constitute any part of an offer or a contract. Whilst every care is taken to ensure accuracy, no responsibility for errors or misdescription is accepted. Any intending purchaser must satisfy themselves by inspection or otherwise as to the correctness of each of the statements in these particulars. The vendor does not make nor give, and neither Taylors nor any person in their employment has any authority to make or give any representation or warranty whatsoever about this property. As the seller's estate agents, we are not surveyors or conveyancing experts, and we cannot comment on the property's condition or issues relating to the title or other legal issues that may affect this property unless we have been made aware of such matters. Interested parties should employ professionals to make such enquiries before making transactional decisions. **EPC:** can be supplied free of charge. **CONSUMER PROTECTION REGULATIONS (2008):** These particulars have been prepared with care and approved by the vendors (where possible) but are intended as a guide only, with measurements being approximate and usually the maximum size, which may include alcoves, recesses or otherwise as described, and you must NOT rely on them for any other purpose. The appearance of an item in any photograph does not mean that it forms part of the property or sale price. **FIXTURES AND FITTINGS:** Only those items specifically mentioned in these sales particulars are included in the sale price. Taylors have NOT tested any apparatus, equipment, fixture or fitting and cannot verify they are in working order or fit for their purpose. **PLANNING PERMISSION / BUILDING REGULATIONS:** Any reference to the property being extended, altered or converted in any way does not infer that planning permission or building regulations have been granted or applied for, nor do Taylors accept any responsibility for such not having been obtained. **FLOOR PLAN:** This plan is for illustrative purposes only. The services, systems and appliances shown have not been tested and no guarantee as to their operability or efficiency can be given.