

14 Bridge Street, Thetford, Norfolk, IP24 3AA
Tel: 01842 754161
thetford@chilternsestateagents.co.uk
www.shiresresidential.com

chilterns

Estate & Letting Agents



Lime Grove, Thetford, Norfolk, IP24 2HW

Rent - £1,150 PCM Deposit - £1,326

This well-presented three-bedroom end-terraced home offers generous living space and excellent access to local amenities, schools and transport links — making it ideal for families or professional tenants. Externally, the home benefits from a private enclosed rear garden mainly laid to lawn with patio area, as well as 2 designated parking spaces.

- END TERRACED HOUSE
- 3 BEDROOMS
- MODERN KITCHEN
- FAMILY BATHROOM
- PARKING & ENCLOSED REAR GARDEN
- CLOSE TO TOWN CENTRE
- ELECTRIC HEATING & ENERGY RATING - D
- APPROXIMATE SIZE - 688 SQFT
- COUNCIL TAX BAND - C
- AVAILABLE NOW



Council Tax Band: C - EPC Rating: D 55

GROUND FLOOR
31.3 sq.m. (337 sq.ft.) approx.

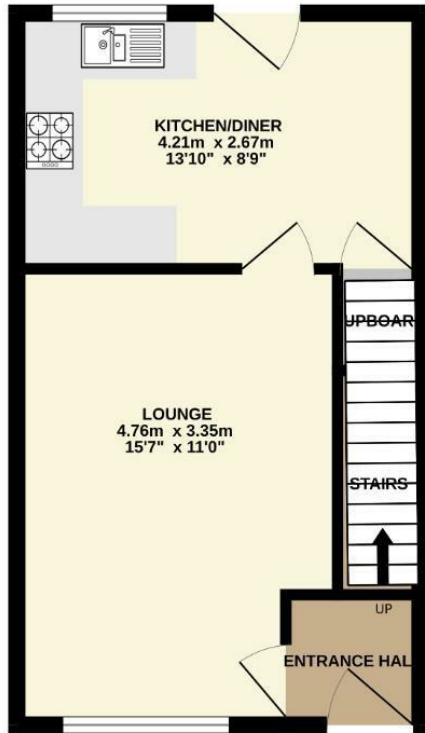

1ST FLOOR
31.3 sq.m. (337 sq.ft.) approx.

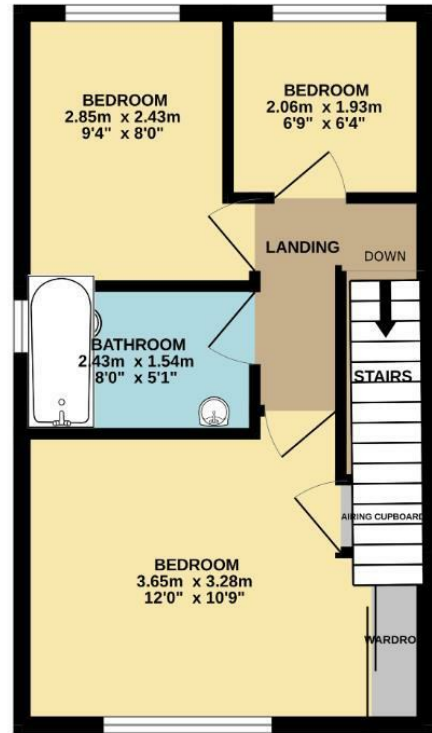

TOTAL FLOOR AREA : 62.6 sq.m. (673 sq.ft.) approx.

Whilst every attempt has been made to ensure the accuracy of the floorplan contained here, measurements of doors, windows, rooms and any other items are approximate and no responsibility is taken for any error, omission or mis-statement. This plan is for illustrative purposes only and should be used as such by any prospective purchaser. The services, systems and appliances shown have not been tested and no guarantee as to their operability or efficiency can be given.
Made with Metropix ©2020

