

Floorplan

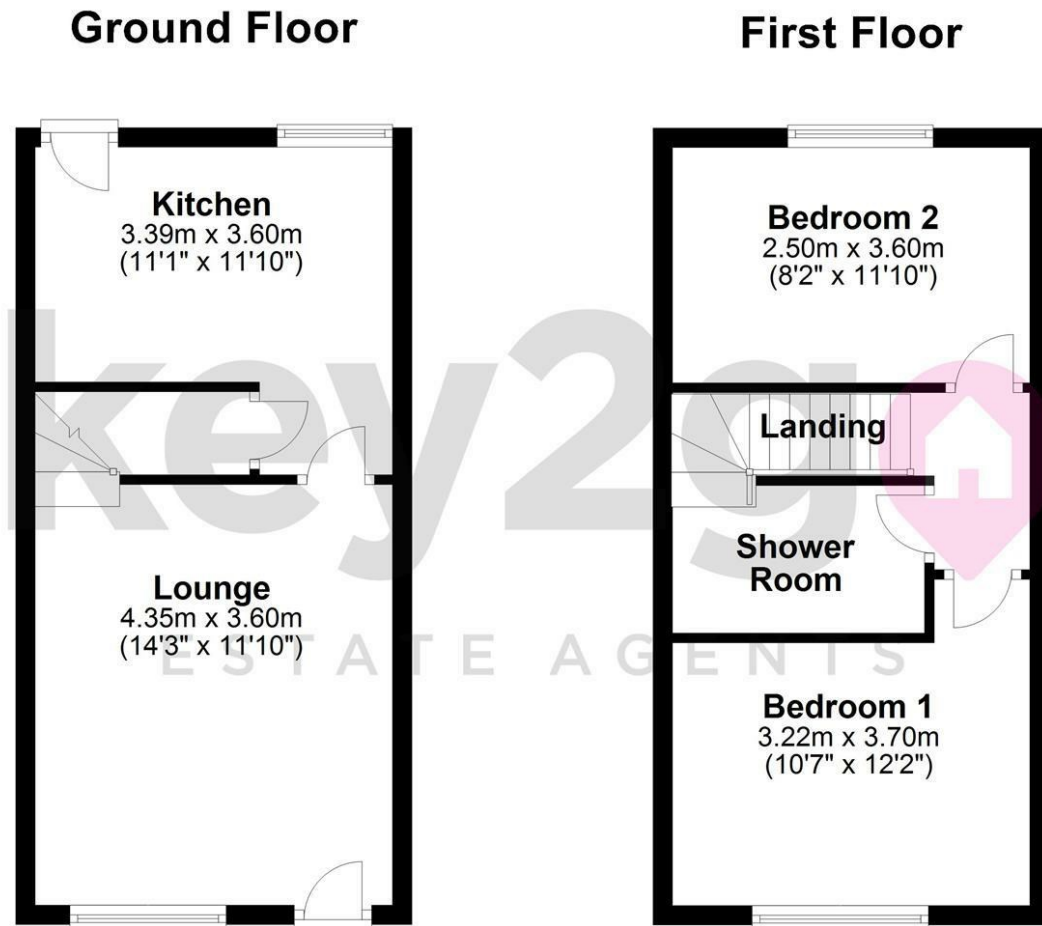

Total area: approx. 56.8 sq. metres (611.9 sq. feet)

Area Map



Energy Efficiency Graph

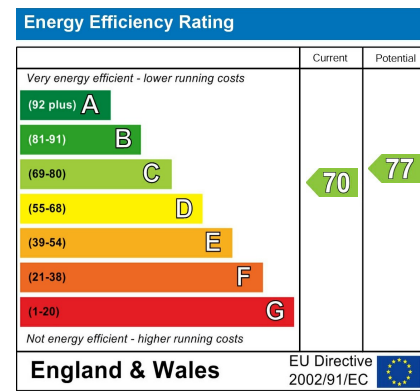

Viewing

Please contact our Lettings Team Office on 0114 2478819 if you wish to arrange a viewing appointment for this property or require further information.

These particulars, whilst believed to be accurate are set out as a general outline only for guidance and do not constitute any part of an offer or contract. Intending purchasers should not rely on them as statements of representation of fact, but must satisfy themselves by inspection or otherwise as to their accuracy. No person in this firm's employment has the authority to make or give any representation or warranty in respect of the property.



61 Springfield Close  
Eckington, Sheffield, S21 4GS

£850 PCM



# 61 Springfield Close

Eckington, Sheffield, S21 4GS

£850 PCM



A well-presented two-bedroom home located on the popular Springfield Close, available to let immediately. This charming property offers comfortable living with a bright and spacious lounge, a modern fitted kitchen, two good-sized bedrooms, and a contemporary family bathroom.

Ideally suited for professionals, couples, or small families, the property benefits from a quiet residential setting while remaining close to local amenities, transport links, and schools.

Available now – early viewing is highly recommended.

A unique opportunity to rent this stunning throughout, two bedroomed terraced property. Offering a low maintenance garden, garage and a stylish kitchen and bathroom. Ideal road links to Chesterfield and M1 Motorway. Close to the countryside and a choice of schools. Perfect for a couple or single person!

