

# Parkheath

*Sold on Service*

---

**Parkhill Road NW3**  
**£2,950 Per Month (£681 per week) - Camden Band E**



Elegant 2 double bedroom apartment  
Bright and airy accommodation  
Open plan shaker style kitchen with breakfast bar  
3 piece bathroom  
Close proximity to Hampstead Heath

1st floor in modern period conversion  
Wood floor reception room  
Fitted wardrobes to principle bedroom  
Walking distance to Belsize Park underground  
EPC Rating: C, Council Tax: Camden band E

Belsize Park Office 020 7431 3104

# Parkhill Road, NW3

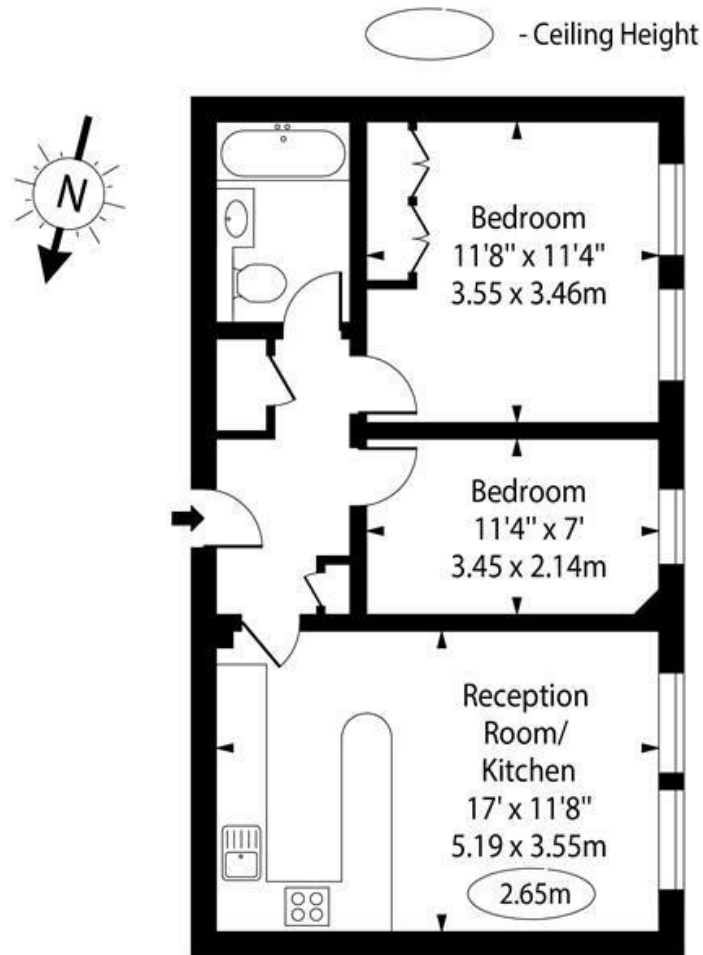

First Floor

Approx Gross Internal Area 553 Sq Ft - 51.41 Sq M

For Illustration Purposes Only - Not To Scale Floor Plan by [www.nogaphotostudio.com](http://www.nogaphotostudio.com) Ref: No.53024

This floor plan should be used as a general outline for guidance only. Any intending purchaser or lessee should satisfy themselves by inspection, searches, enquiries and full survey as to the correctness of each statement. Any areas, measurements or distances quoted are approximate and should not be used to value a property or be the basis of any sale or let.

The particulars do not constitute part of an offer or contract. The particulars, including text, photographs and plans, are for the guidance only of prospective purchasers/tenants and must not be relied upon as statements of fact. The descriptions provided therein represent the opinion of the author and whilst given in good faith should not be construed as statements of fact. Nothing in these particulars shall be deemed a statement that the property is in good condition or otherwise or that any services or facilities are in good working order. All measurements are approximate