



Connells

Flat 15 Ker Street Ope
Plymouth

Flat 15 Ker Street Ope Plymouth PL1 4RZ

for sale
£140,000



Property Description

Welcoming to the market is the exciting opportunity to acquire this immaculately presented one bedroom purpose-built first floor apartment, situated in a popular residential location. Benefiting from an open-plan kitchen/lounge, one double bedroom, bathroom, balcony and allocated parking.

Located centrally in the PL1 area of Plymouth, close to a host of local amenities such as an array of shops and cafes, well-regarded schools, local parks whilst being a stone's throw away from the city centre and main transport links.

This apartment offers showhome condition throughout, with an spacious light and airy open-plan kitchen/lounge with double patio doors leading directly out onto your own private balcony, modern matching wall and base units with built-in appliances in the kitchen area, perfect for hosting. One large double bedroom and a modern bathroom comprising bath with overhead shower, hand basin and W.C. Ample storage space can also be found throughout this home.

Externally, this property offers a private balcony and allocated parking.

This apartment in the perfect opportunity for a first time buyer or investor, appealing to a wide range of buyers.

BOOK YOUR VIEWINGS NOW!

Welcoming to the market is the exciting opportunity to acquire this immaculately

presented one bedroom purpose-built first floor apartment, situated in a popular residential location. Benefiting from an open-plan kitchen/lounge, one double bedroom, bathroom, balcony and allocated parking.

Located centrally in the PL1 area of Plymouth, close to a host of local amenities such as an array of shops and cafes, well-regarded schools, local parks whilst being a stone's throw away from the city centre and main transport links.

This apartment offers showhome condition throughout, with an spacious light and airy open-plan kitchen/lounge with double patio doors leading directly out onto your own private balcony, modern matching wall and base units with built-in appliances in the kitchen area, perfect for hosting. One large double bedroom and a modern bathroom comprising bath with overhead shower, hand basin and W.C. Ample storage space can also be found throughout this home.

Externally, this property offers a private balcony and allocated parking.

This apartment in the perfect opportunity for a first time buyer or investor, appealing to a wide range of buyers.

BOOK YOUR VIEWINGS NOW!

Welcoming to the market is the exciting opportunity to acquire this immaculately presented one bedroom purpose-built first floor apartment, situated in a popular residential location. Benefiting from an open-

plan kitchen/lounge, one double bedroom, bathroom, balcony and allocated parking.

Located centrally in the PL1 area of Plymouth, close to a host of local amenities such as an array of shops and cafes, well-regarded schools, local parks whilst being a stone's throw away from the city centre and main transport links.

This apartment offers showhome condition throughout, with an spacious light and airy open-plan kitchen/lounge with double patio doors leading directly out onto your own private balcony, modern matching wall and base units with built-in appliances in the kitchen area, perfect for hosting. One large double bedroom and a modern bathroom comprising bath with overhead shower, hand basin and W.C. Ample storage space can also be found throughout this home.

Externally, this property offers a private balcony and allocated parking.

This apartment in the perfect opportunity for a first time buyer or investor, appealing to a wide range of buyers.

BOOK YOUR VIEWINGS NOW!

Welcoming to the market is the exciting opportunity to acquire this immaculately presented one bedroom purpose-built first floor apartment, situated in a popular residential location. Benefiting from an open-plan kitchen/lounge, one double bedroom, bathroom, balcony and allocated parking.

Located centrally in the PL1 area of Plymouth, close to a host of local amenities such as an array of shops and cafes, well-regarded schools, local parks whilst being a

stone's throw away from the city centre and main transport links.

This apartment offers showhome condition throughout, with an spacious light and airy open-plan kitchen/lounge with double patio doors leading directly out onto your own private balcony, modern matching wall and base units with built-in appliances in the kitchen area, perfect for hosting. One large double bedroom and a modern bathroom comprising bath with overhead shower, hand basin and W.C. Ample storage space can also be found throughout this home.

Externally, this property offers a private balcony and allocated parking.

This apartment in the perfect opportunity for a first time buyer or investor, appealing to a wide range of buyers.

BOOK YOUR VIEWINGS NOW!







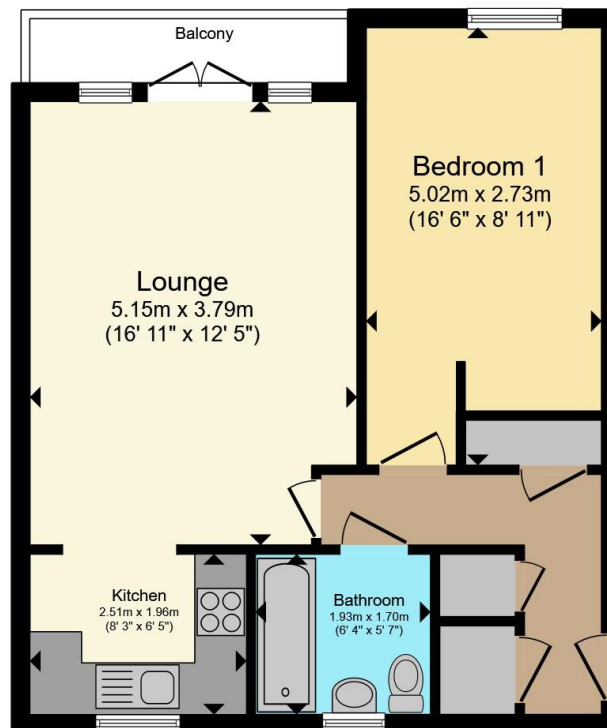

Total floor area 49.4 m² (532 sq.ft.) approx

This floor plan is for illustrative purposes only. It is not drawn to scale. Any measurements, floor areas (including any total floor area), openings and orientation are approximate. No details are guaranteed, they cannot be relied upon for any purpose and they do not form part of any agreement. No liability is taken for any error, omission or misstatement. A party must rely upon its own inspection(s). Powered by www.propertybox.io

Connells

To view this property please contact Connells on

T 01752 674 467
E plymouth@connells.co.uk

32 Mannamead Road
 PLYMOUTH PL4 7AA

EPC Rating: B Council Tax
 Band: A

Service Charge:
 1060.00

Ground Rent:
 225.00

Tenure: Leasehold

view this property online connells.co.uk/Property/PLH313116

This is a Leasehold property with details as follows; Term of Lease 125 years from 01 Jan 2014. Should you require further information please contact the branch. Please Note additional fees could be incurred for items such as

1. MONEY LAUNDERING REGULATIONS Intending purchasers will be asked to produce identification documentation at a later stage and we would ask for your co-operation in order that there will be no delay in agreeing the sale. 2. These particulars do not constitute part or all of an offer or contract. 3. The measurements indicated are supplied for guidance only and as such must be considered incorrect. Potential buyers are advised to recheck measurements before committing to any expense. 4. We have not tested any apparatus, equipment, fixtures, fittings or services and it is in the buyers interest to check the working condition of any appliances.

Connells Residential is registered in England and Wales under company number 1489613, Registered Office is Cumbria House, 16-20 Hockliffe Street, Leighton Buzzard, Bedfordshire, LU7 1GN. VAT Registration Number is 500 2481 05.



See all our properties at www.connells.co.uk | www.rightmove.co.uk | www.zoopla.co.uk

Property Ref: PLH313116 - 0002