

# 44 Aynsley Gardens

Church Langley, Harlow

Nestled in the welcoming community of Church Langley, this two bedroom apartment offers heaps of scope to add your own stamp. An ideal find for first-time buyers or downsizers perhaps - this one is a must-see!

Council Tax band: C

Tenure: Leasehold

- Two double bedroom apartment
- Ideal first time buy
- Opportunity to add own stamp
- Allocated parking
- Easy access to M11
- Located within Church Langley
- Beautiful local walks



**Hallway**

**Living / Dining Room**

14' 9" x 13' 9" (4.50m x 4.20m)

**Kitchen**

8' 2" x 6' 11" (2.50m x 2.10m)

**Bedroom**

10' 10" x 10' 6" (3.30m x 3.20m)

**Bedroom**

10' 10" x 6' 11" (3.30m x 2.10m)

**Bathroom**





# Aynsley Gardens CM17

Approx. Gross Internal Area 567 Sq Ft - 52.67 Sq M

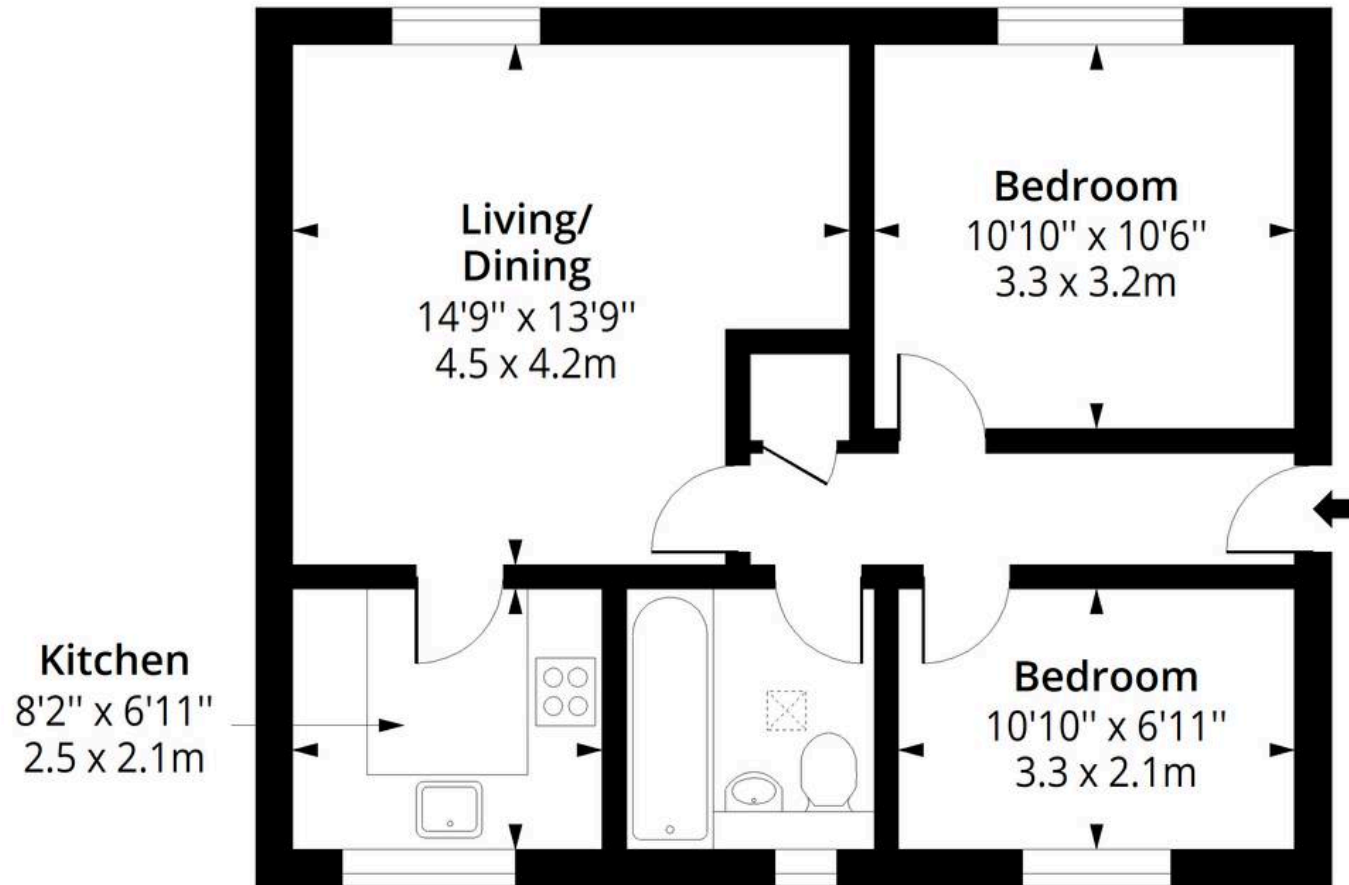
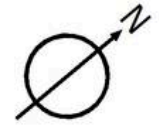

## Second Floor

Floor Area 567 Sq Ft - 52.67 Sq M



Measured according to RICS IPMS2. Floor plan is for illustrative purposes only and is not to scale. Every attempt has been made to ensure the accuracy of the floor plan shown, however all measurements, fixtures, fittings and data shown are an approximate interpretation for illustrative purposes only. 1 sq m = 10.76 sq feet.

Date: 21/5/2026