



Apt 11, Robert Ellis Court St. Martins Road, Knebworth

Knebworth

CHANDLERS

£325,000

# Apartment 11

Robert Ellis Court St. Martins Road, Knebworth

A two bedroomed 'penthouse' apartment situated within the heart of the village; this purpose built over 55's prestigious development consists of just 23 apartments.

Secure electric gated access leads to both the parking and landscaped gardens. The development is well presented with carpeted communal stairway which also features a Lift to the second floor.

The Apartment is accessed via a large central hallway providing access to all principal rooms, kitchen / dining room, 19ft sitting room opening onto a walled balcony, main bedroom also opening onto balcony and ensuite, further bedroom with fitted wardrobes, Jack & Jill bathroom.

Knebworth is a desirable Hertfordshire village providing a Doctors Surgery, supermarket, bakers, butchers and various other shops and restaurants. The beautiful Hertfordshire countryside is on your doorstep while Knebworth Train station provides access to London Kings Cross and the wider rail network. EPC Rating C

Additional / Material Information

Mains Water, Gas, Electricity

Underfloor heating

Local Authority is North Hertfordshire District Council

Council Tax Band E

Lease – 125 Years from 25th March 2008

Ground Rent – £500 PA

Service Charge – £2861

Council Tax band: E

Tenure: Leasehold

EPC Energy Efficiency Rating: C

EPC Environmental Impact Rating: C

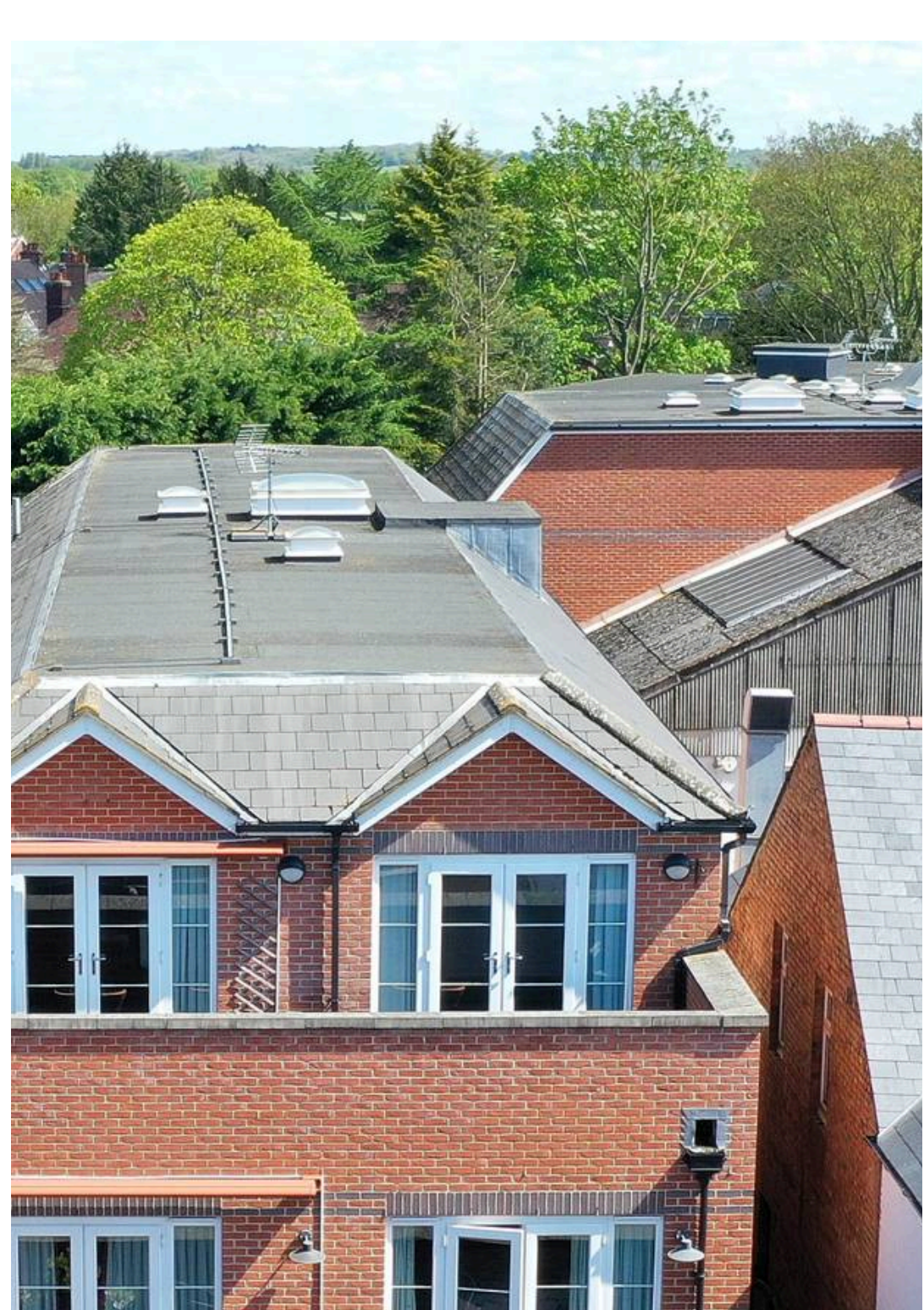



## Apartment 11

Robert Ellis Court St. Martins Road,  
Knebworth

- Penthouse Apartment
- Sitting room opening onto balcony
- Fitted Kitchen with Inbuilt appliances
- Main bedroom with French doors to balcony
- Ensuite to 1st bedroom
- 2nd Bedroom
- Jack & Jill Ensuite
- Outside Balcony providing open views over Knebworth
- Lift access











TOP FLOOR

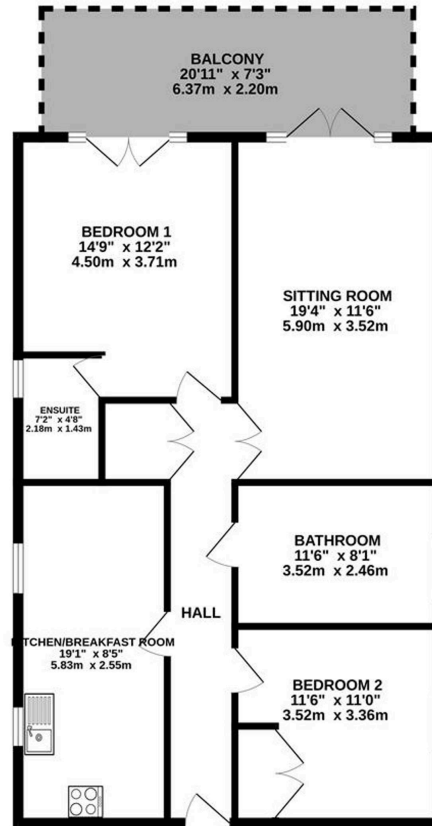

Whilst every attempt has been made to ensure the accuracy of the floorplan contained here, measurements of doors, windows, rooms and any other items are approximate and no responsibility is taken for any error, omission or mis-statement. This plan is for illustrative purposes only and should be used as such by any prospective purchaser. The services, systems and appliances shown have not been tested and no guarantee as to their operability or efficiency can be given.  
Made with Metropix ©2024

# Chandlers Estate Agents

Chandlers, 18 Market Place – SG1 1DB

01438356635

[sales@chandlers-estates.co.uk](mailto:sales@chandlers-estates.co.uk)

[www.chandlers-estates.co.uk/](http://www.chandlers-estates.co.uk/)

While we believe the details provided to be correct, we do not guarantee their accuracy. Prospective buyers should verify all information independently before making any decisions. No responsibility is taken for any errors, omissions, or misstatements.