



Wellington Road, New Brighton

£539,000 Council Tax Band D

 4
  2
  3



A one of a kind! This Grade II listed building is an impressive Georgian property that features unique and remarkable historic elements enhanced by modern upgrades that elevate the property even further. Offering breathtaking views across the River Mersey and towards Liverpool, which can also be enjoyed from the balcony plus the beautiful tiered gardens. Situated on a sought-after road, steps from the promenade in New Brighton. Interior: dining room, WC, breakfast kitchen, grand hallway, living room and bedroom to the ground floor, with a further two bedrooms, living room/bedroom and bathroom with additional WC on the first floor. Also having a basement with home office and shower room. Exterior: fantastic tiered lawned gardens with patio area and detached garage. Be quick!

Key Features

- Four/Five Bedroom Georgian Property
- Grade II Listed Building
- Outbuildings, Tiered Gardens and Garage
- Council Tax Band D
-
-
-

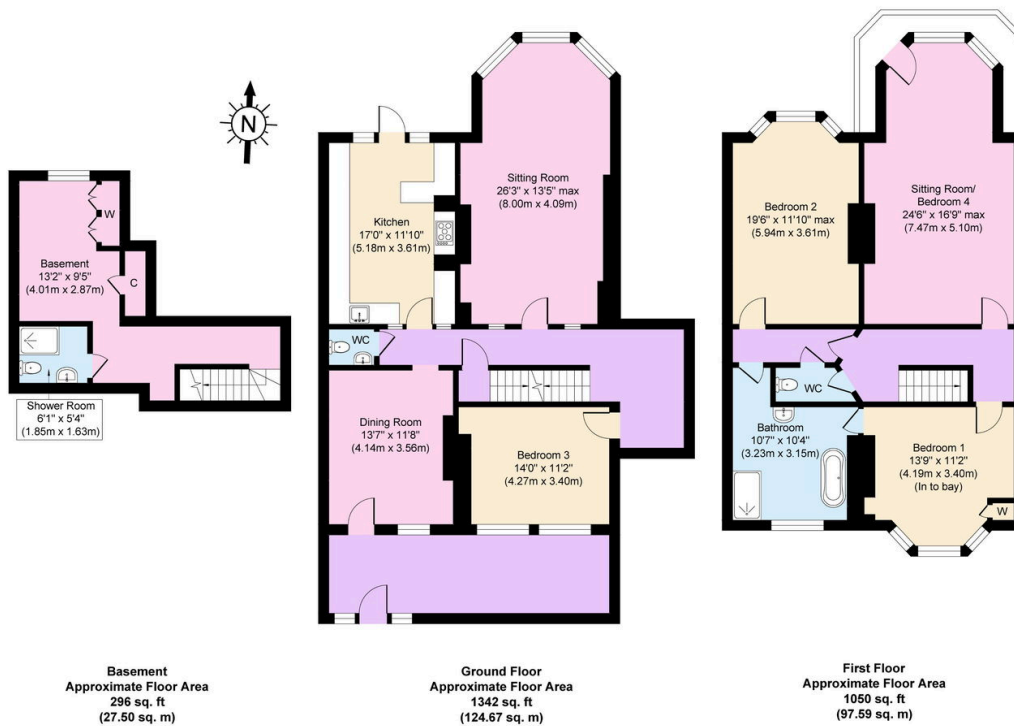

Copyright V360 Ltd 2025 | www.houseviz.com