

Whittaker Street, SW1W

£807 Per week

A unique refurbished one bedroom split level apartment located in a quiet Mews in Chelsea, just a short walk to Sloane Square Station. Double height ceilings and windows makes this property a must see.

Close to Sloane Square and the King's Road with a wide variety of shops, cafés and restaurants including, Partridge's, Waitrose supermarket, Peter Jones and Restaurant Gordon Ramsey.

Features

- One Bedroom
- Newly Refurbished
- Split Level
- Mews Location
- Gated
- In Built Storage

Whittaker Street, London, SW1W

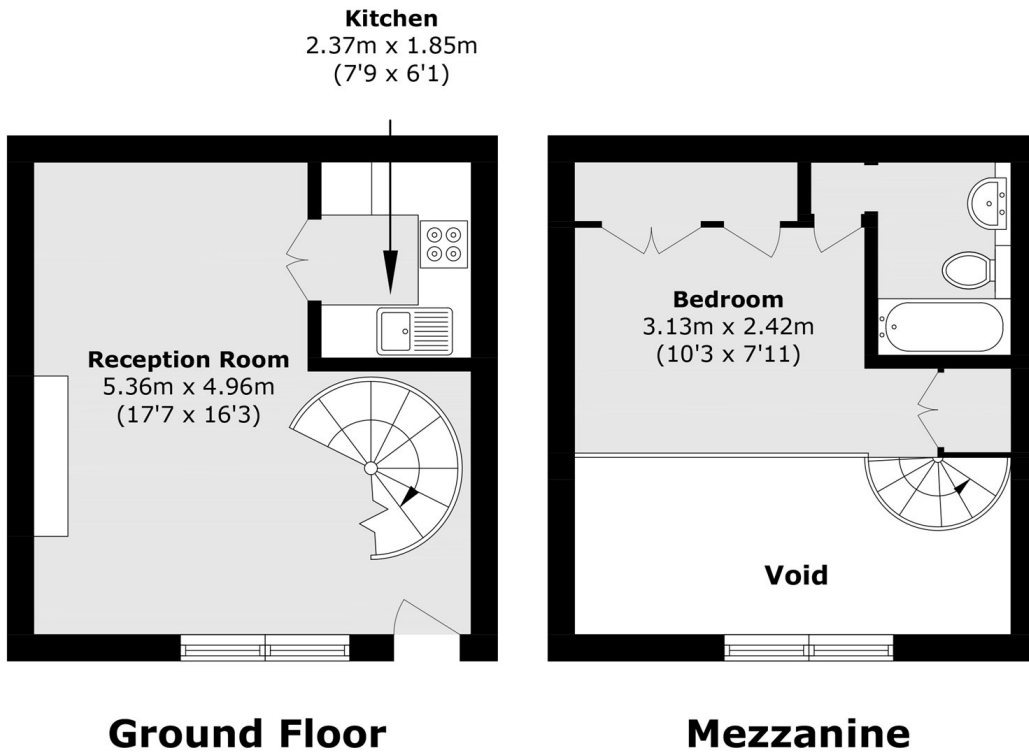

Total area (approx.): 42.9 sq. m (461.7 sq. ft)
(Excluding Void/Including Mezzanine)