

JOHN DALE Estate Agency

POWERED BY
KELLERWILLIAMS



Cowley Drive, Brighton BN2 6TP

Detached chalet bungalow in a desirable location
Bright, versatile living spaces with huge potential
Large sunny southerly garden – ideal for entertaining
EPC rating: D (pot. C)

OFFERS IN THE REGION OF - £399,950

Detached chalet bungalow with generous living, sunny southerly garden, distant sea views & garage. Close to Brighton Marina, beaches & the South Downs – blending space, charm & a vibrant coastal lifestyle.

This large detached chalet-style bungalow isn't just a home – it's a lifestyle. Tucked away in a desirable spot, it combines space, potential and coastal charm with all the ingredients for relaxed yet connected living. With four bedrooms, two bathrooms and two versatile reception rooms, there's room for everyone to spread out, while the generous kitchen is ready to become the heart of the home.

Step outside and you'll instantly feel the appeal: a substantial southerly garden where the sun lingers all day, perfect for barbecues, family gatherings or simply unwinding with a book. To the front, a smart garden and large garage add both practicality and kerb appeal, while at the rear you'll find stunning distant views across to the sea – a daily reminder of why living here feels so special.

The lifestyle on offer is second to none. Just minutes away you'll find Brighton Marina with its waterside restaurants, shops and vibrant energy, while the city centre tempts with theatres, bars and culture. Love the outdoors? You're spoilt for choice: the beautifully restored Saltdean Lido for summer swims, long coastal walks along the undercliff path, golf clubs, tennis courts, bowling greens and bathing beaches all within easy reach. For adventures further afield, the South Downs National Park beckons with rolling countryside and endless footpaths.

This is a home where mornings can start with sea air and countryside walks, afternoons can be spent in the garden soaking up the sunshine, and evenings can lead you effortlessly into the buzz of Brighton. Spacious, adaptable and perfectly positioned, it promises not just a place to live, but a wonderful way of life.



Ground Floor

Approx. 117.1 sq. metres (1280.0 sq. feet)

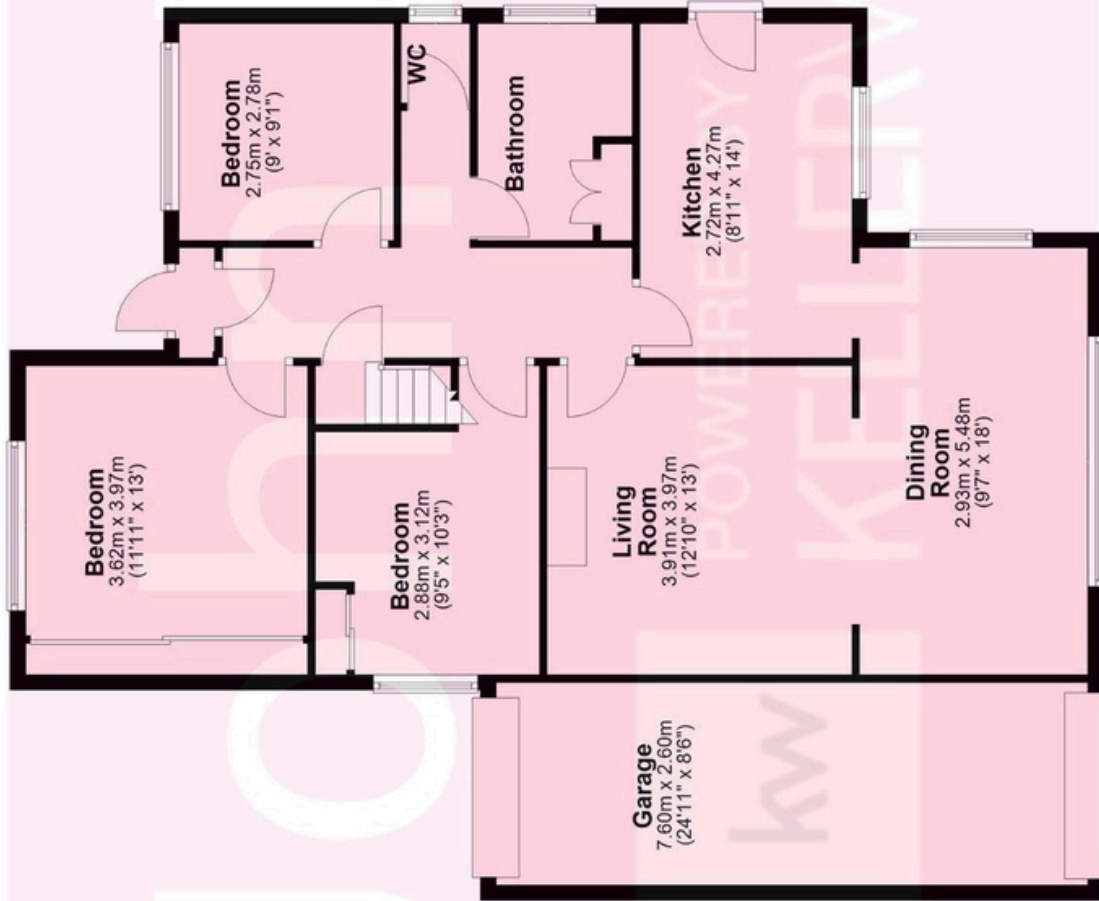

First Floor

Approx. 33.4 sq. metres (359.1 sq. feet)

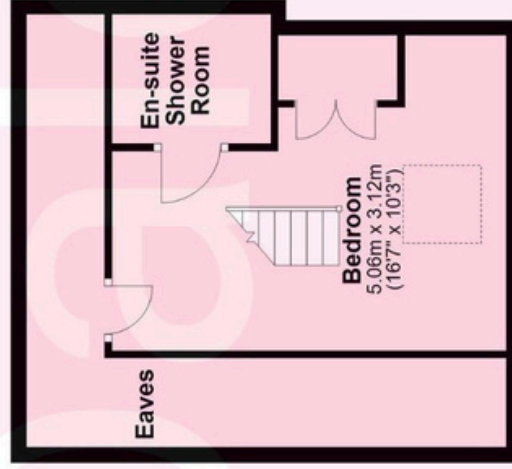

Total area: approx. 150.4 sq. metres (1619.1 sq. feet)



POWERED BY
KELLERWILLIAMS