

Oakham Road, Littleover

aksresidential.com

Offers in excess of
£230,000



AKS
THE ESTATE AGENCY

This property at a glance:



Watch the video



Oakham Road, Littleover



Jodie says:

“This beautifully presented two-bedroom semi-detached home is perfectly placed on the ever-popular Highfields estate in Littleover.

From the moment you arrive, the property offers a sense of space and practicality, with convenient side-by-side parking at the front, something that works incredibly well for busy households or when guests visit. The welcoming entrance hallway is complete with a useful built-in cupboard (perfect for keeping everyday clutter neatly tucked away) and access to a handy downstairs WC.

The heart of the home is the stunning open-plan living space, I absolutely love this area! The contemporary kitchen has sleek grey units and fully integrated appliances, creating a clean, modern feel, while still being incredibly functional for day-to-day life. What really stands out is how well the space flows into the living-dining area—ideal for both relaxed evenings and entertaining. It’s a layout that just works, whether you’re cooking, hosting, or simply unwinding.

Upstairs, you’ll find two generously sized double bedrooms. The main bedroom is a real favourite, offering its own ensuite shower room and a useful storage cupboard, making it a comfortable and practical retreat. The second bedroom is equally versatile and works brilliantly as a child’s room, guest space, or even a home office depending on your needs. A stylish and modern family bathroom completes the first floor.

Outside, the south-east facing garden is a real highlight and something to truly enjoy. It’s a wonderful sun trap throughout the day, making it perfect for morning coffee or summer evenings. With a patio seating area, a lawn for play, and plenty of space for a shed, it’s a garden that’s both enjoyable and easy to use.

Overall, this home offers a fantastic balance of style, comfort, and practicality—with a layout and features that genuinely make everyday living feel easy and enjoyable”.

Oakham Road, Littleover



Did you spot...

This great family home has time remaining on the NHBC warranty



A message from the seller:

"Welcome to our home. This was our first place together, and we've genuinely loved living here for the past five years. It's been a special home for us, but with our second child on the way, we've decided it's time to move somewhere a bit bigger and start the next chapter. The house sits on a relatively new estate (around 7 years old) and it's a really peaceful area. It suits both young professionals and families – there are plenty of green spaces, walking routes and a few playgrounds nearby, and traffic is minimal, so it always feels calm and safe. We've been very lucky with the neighbours – our street is mostly young families, and there's a genuinely friendly, community feel. Despite being semi-detached, we've never had any issues with noise. Everything you need is close by – nursery, shops (Co-op, Aldi, pharmacy), GP, vet, and a few good local places to eat. There are also two great pubs nearby with really nice food and atmosphere."

AKS
THE ESTATE AGENCY



Floor Plan

Ground Floor
Approx. 31.1 sq. metres (335.0 sq. feet)

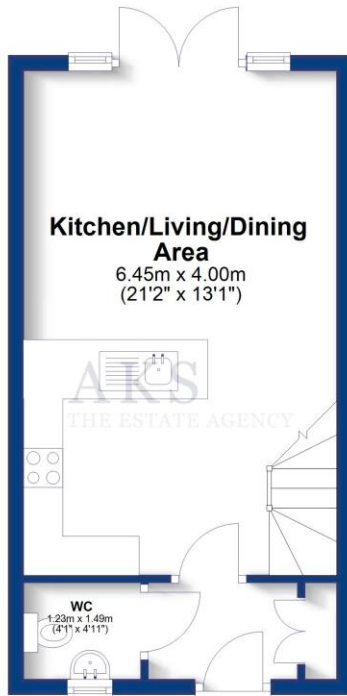

First Floor
Approx. 31.2 sq. metres (336.1 sq. feet)

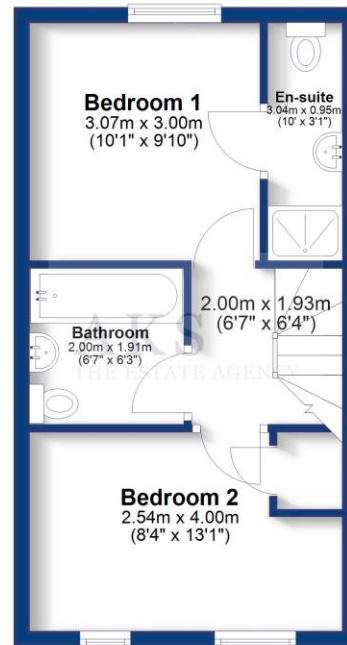

Total area: approx. 62.3 sq. metres (671.1 sq. feet)



Energy Performance Certificate

Oakham Road, Littleover

Presented by

AKS
THE ESTATE AGENCY



★★★★★
300+ 5 star Google Reviews



Key Features:

- TWO BEDROOM SEMI-DETACHED HOUSE
- SPACIOUS, OPEN-PLAN LAYOUT
- EN-SUITE TO MAIN BEDROOM
- SIDE BY SIDE DRIVEWAY PARKING
- FANTASTIC LOCATION
- SOUTH-EAST FACING GARDEN
- NHBC WARRANTY REMAINING
- EPC RATING B



About the area:

A popular suburb of Derby, Littleover has plenty of local amenities around, from a Co-op, to local shops, takeaways and easy access to the main road links. Alongside the secondary School, Derby Moor has gym facilities, grass and artificial football pitches and tennis courts. With easy access to the public transport links which frequently run into the City Centre and to Royal Derby Hospital, it is just a short drive from the Ring Road.



Schools:

Gayton Primary School is in the vicinity, with the secondary school being Littleover Community School or Derby Moor Academy in Littleover.



Don't miss out on the chance to own this incredible property!

To book a viewing with **Jodie** call
01332 30 30 30

[Click here](#) to watch the property video

