



## MANLEY STREET, NW1

£4,500 per month

Four Bedrooms  
Professional Sharers Welcome  
Period Conversion  
Maisonette  
Two Bathrooms  
Fully Furnished

@marshandparsons  
marshandparsons.co.uk

MARSH &  
PARSONS



# ABOUT THE PROPERTY

Well presented four bedroom maisonette in a charming period conversion set on a quiet residential road. The property is set over two floors and is flooded with natural light. The property benefits from ample living space, double bedrooms, separate kitchen and two bathrooms. Ideal for families and professional sharers.

Manley Street is ideally located just off Primrose Hill High Street, with its boutique shops, cafés, and restaurants a stones throw away. Walking distance to Primrose Hill & Regents Park's. Excellent transport links via Chalk Farm and Camden Underground Stations (Northern Line) with easy access to King's Cross St Pancras and Central London.



# STEP INSIDE MANLEY STREET

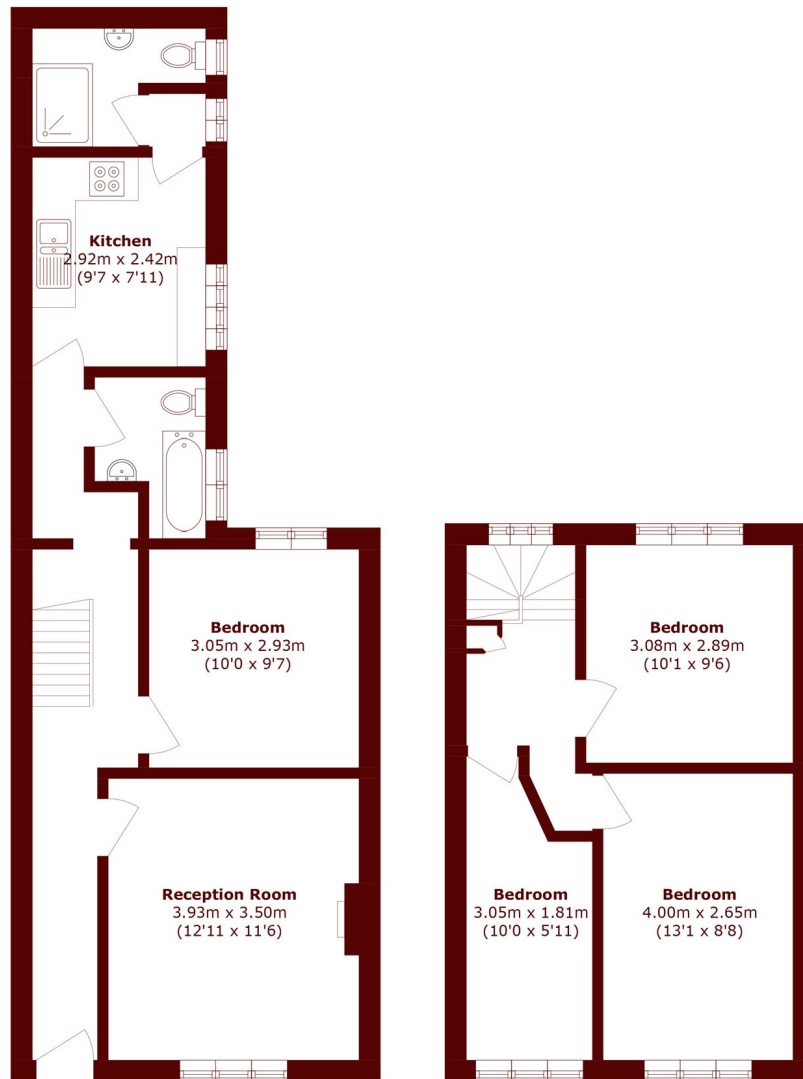

**Ground Floor**

**First Floor**

Total area (approx.): 82.9 sq. m (892.3 sq. ft)

**Camden**  
020 7244 2201

Energy Rating: We aim to make our particulars both accurate and reliable. However, they are not guaranteed; nor do they form part of an offer or contract. If you require clarification on any points then please contact us, especially if you're traveling some distance to view. Please note that appliances and heating systems have not been tested and therefore no warranties can be given as to their good working order

**MARSH &  
PARSONS**